



Y.S. TECH
元山科技工業股份有限公司
YEN SUN TECHNOLOGY CORPORATION

HEADQUARTERS / 總公司

No.329, Fengren Rd., Renwu Township, Kaohsiung County, TAIWAN 814
Tel: +886-7-3713588(10Lines) Fax: +886-7-3719643
www.ystech.com.tw E-mail:ystech@ystech.com.tw

TAIPEI / 台北

9F., No. 220, Sec. 4, Chengde Rd., Shilin Dist., Taipei City, TAIWAN 111
Tel: +886-2-28833896 Fax: +886-2-28833136

CHINA / 中國

Xinsi Admin Zone, Heng Li Town, Dongguan, Guangdong Province, CHINA
Postal code : 523466
E-mail:china@ystech.com.tw

U.S.A. / 美國

12691 Monarch St. Garden Grove, CA 92841, USA
Tel: +1-714-379-1400 Fax: +1-714-379-0100
www.ystechusa.com E-mail:sales@ystechusa.com

GERMANY/ 德國

Ruhrstraße 53, D-22761 Hamburg, Germany
Tel: +49-(0)40-84 00 01-0 Fax: +49-(0)40 84 00 01-65
www.elektrosil.com E-mail:el@elektrosil.com



Y.S. TECH
YEN SUN TECHNOLOGY CORPORATION



2011 PRODUCTS GUIDE COOLING FAN ENGINEERING HANDBOOK



DC AXIAL FAN / XTREME SERIES / DC BLOWER / AC AXIAL FAN



COMPANY MISSION
Environmental Concern
Customer Satisfaction

PHILOSOPHIES
Innovation Quality Efficiency

Established: 1987
C.E.O.: Mr. C. J. Chen
TS 16949 / ISO 9001 / ISO 14001 Certified
Capital: US\$10.65 Million
Employees: 1,000

Headquarters Location: Kaohsiung, Taiwan
Business Units:

Electronics Cooling Division
Home Appliance Division



Headquarters



Dongguan Factory



Shanghai Factory

Yen Sun Technology Corporation was established in 1987, conformity with the business philosophies of **INNOVATION, QUALITY** and **EFFICIENCY**.

With over 1000 employees, Yen Sun is a publicly-traded company in Taiwan comprised of two major divisions, including the Electronics Cooling Division and the Home Appliances Division. The manufacturing plants are located in Taiwan, Dongguan, and Shanghai with the worldwide service facilities throughout Asia, America, Australia and the greater part of Europe.

In the past decade, the Electronic Cooling Division has accumulated hundreds of patents all over the world and successfully established a reputation of consistent quality and unique capabilities with its well-known brand name Y.S. TECH. Devoted to innovative technologies and new products, Y.S. TECH continuously improves its R&D and core technologies. The core technologies consist of Advanced Motor Control, CFD Thermal and Fluid Dynamic Simulation, Psycho-Acoustic Analysis, and Electro-Thermal Analysis. Y.S. TECH has integrated its core technologies to develop a series of DC and AC cooling fans with RoHS compliance such as a series of Xtreme high performance fans, along with the *SINTETICO* long life bearing system that has been approved for Telecom and Automotive applications. Furthermore, utilizing T.M.D. Technology Y.S. TECH has developed the world's slimmest fans measuring only 0.4 centimeters in thickness with applications include the next-generation multi-function handheld devices.

CUSTOMER SATISFACTION is based on excellent production capabilities as well as a consistent level of quality. In such a way, Y.S. TECH's advanced automated production lines, along with our precision equipment, provide a high level quality control. Moreover, Yen Sun utilizes XRF to assist its Environmental Materials Management.

This quality system has not only been approved by ISO 14001 and ISO 9001, but has also gained TS 16949 certification, the worldwide automotive industry quality standard.

At Y.S. TECH, our long-term vision is to aggressively integrate our business resources, enhance total quality management, innovations, and increase our global logistics capabilities to achieve competitive advantages as a world-class manufacturer to be **YOUR BEST PARTNER OF THERMAL SOLUTIONS**.

FD 05 25 10 H B - N (Suffix)

1 2 3 4 5 6 7

- Explanation**
- Product Series(2 codes)**
FD : Axial DC Fan **BD** : DC Blower
KM : Axial DC Fan **PD** : T.M.D.FAN
 - Voltage Type(2 codes)**
05 : 5V **12** : 12V
24 : 24V **48** : 48V
 - Dimension (2 codes)**
25 : 25mmx25mm **30** : 30mmx30mm
40 : 40mmx40mm **45** : 45mmx45mm
50 : 50mmx50mm **60** : 60mmx60mm
70 : 70mmx70mm **75** : 75mmx75mm
80 : 80mmx80mm **92** : 92mmx92mm
97 : 97mmx97mm **12** : 120mmx120mm
 - Thickness(2 codes)**
10 : 10mm **15** : 15mm
20 : 20mm **25** : 25mm
28 : 28mm **30** : 30mm
32 : 32mm **33** : 33mm
38 : 38mm **56** : 56mm
 - Speed(1 code)**
L : Low Speed **M** : Medium Speed
H : High Speed **E** : Extra High Speed
U : Ultra
 - Bearing Type(1 code)**
B : Ball Bearing **S** : Sleeve Bearing
L : Sintetico Bearing
 - Impeller Type(1 code)**
N : Type N **E** : Type E **H** : Type H
P : Type P **R** : Type R □ : Standard Type
- (Suffix):(2 A 7 L F)**
a b c d e
- a : Number of Bearing**
1 : One Ball/Sleeve Bearing
2 : Two Ball Bearing
- b : Function**
N : Transistor (2 wires)
A : Transistor With FG Signal(3 wires)
I : Auto-Restart IC (2 wires)
F : Tachometer IC (3 wires)
R : Alarm High IC (3 wires)
C : Alarm High (R) + Tachometer (F) IC
Q : Alarm Low IC (3 wires)
P : Alarm Low (Q) + Tachometer (F) IC
S : Alarm high-low IC (3wires)
T : Thermistor IC (2 wires)
E : Thermistor IC(T)+VR
D : Thermistor IC(T)+VR+Tachometer(F) IC
M : Thermistor (T) + Tachometer (F) IC
X : Thermistor (T)+Alarm High(R) IC
V : Thermistor (T) +Alarm High-Low (S) IC
W : Pulse Width Modulation (PWM) IC
B : Pulse Width Modulation(PWM) IC, Without FG Signal
U : PWM(W)+Thermistor IC(T)
G : Vcc With PWM Control, Without FG Signal
H : Vcc With PWM Control, With FG Signal
- C : Speed Level**
1.2.3....9.B.D.F.H.U
- d : Customized Version**
B : Wide Operating Voltage Range Model
E : Wide Operating Temperature Range Model
H : HDB
Q : New Blades Design Q Type
W : New Blades Design W Type
L : LED Fan
K : KM Fan
R : Round Frame Fan
Y : Frameless
□ : Standard Type
- e : Special Model Version**

AC Fan Model Numbering System

F A1 120 38 H B T - (Suffix)

1 2 3 4 5 6 7

- Product Type / F** : AC FAN **B** : AC Blower
 - Voltage Type / A1** : 110/115VAC **A2** : 220/230VAC
 - Dimension / 120** : 120X120mm **172** : 172x150mm
176 : 176X176mm
254 : ø254mm
 - Thickness / 38** : 38mm **51** : 51mm **89** : 89mm
 - Speed / L** : Low Speed **M** : Medium Speed
H : High Speed **E** : Extreme Speed
 - Bearing Type / B** : Ball Bearing **S** : Sleeve Bearing
 - Connecting Type / L** : Lead Wire **T** : Terminal
- Suffix : Protection Function / E** : External Rotor Fan
T : Temperature Sensor
TC : Temperature Sensor+Capacitor



25x25x10mm

- Airflow: 2.0~3.3 CFM
- Static Pressure: 3.7~6.3 mm-H₂O
- Blade / Housing: Plastic Material UL 94V-0 P.B.T.
- Lead Wire: UL1571 #28 AWG
- Weight: 7.5 g

Model No.	Bearing	Rated Voltage VDC	Operating Voltage Range VDC	Speed RPM	Max. Airflow CFM	Max. Static Pressure mm-H ₂ O	Current mA	Power Consumption W	Life at 40°C L10 Hour	P-Q Curve	Noise Level dB(A)
FD052510LB-N	2B	05	4~5.5	7000	2.0	3.7	75	0.38	80000	4	18.0
FD052510MB-N	2B		4~5.5	8500	2.4	4.5	110	0.55	80000	3	22.5
FD052510HB-N	2B		4~5.5	10000	2.8	5.3	140	0.70	75000	2	26.0
FD052510EB-N	2B		4~5.5	12000	3.3	6.3	180	0.90	65000	1	30.0
FD122510LB-N	2B	12	9~13.2	7000	2.0	3.7	40	0.48	80000	4	18.0
FD122510MB-N	2B		7~13.2	8500	2.4	4.5	50	0.60	80000	3	22.5
FD122510HB-N	2B		7~13.2	10000	2.8	5.3	65	0.78	75000	2	26.0
FD122510EB-N	2B		7~13.2	12000	3.3	6.3	70	0.84	65000	1	30.0

2B: 2-ball bearing L: sintetico bearing S: sleeve bearing

Voltage Available
05 12 24 48

Bearing System Available
2B L S

Function Available
N A I F R Q S T M V C P D W U

PERFORMANCE P-Q CURVE

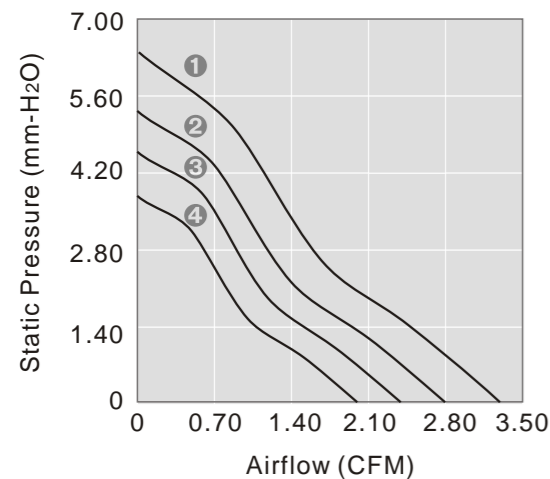

OUTLINE DIMENSIONS

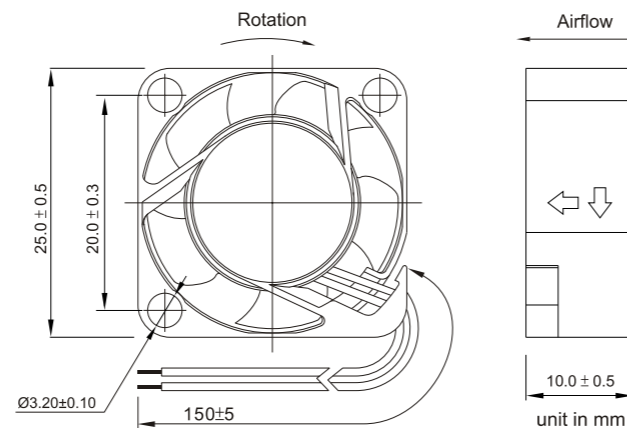

Please refer to Model Numbering System for bearing, function and speed level indication. Specifications are subject to changes without notice. Please refer to the formally issued product specification via contacting Y.S. TECH sales department. Visit Y.S. TECH web site at <http://www.ystech.com.tw> for updated information. Customized Specifications are designed accordingly.



25x25x15mm

- Airflow: 2.1~2.6 CFM
- Static Pressure: 3.1~4.7 mm-H₂O
- Blade / Housing: Plastic Material UL 94V-0 P.B.T.
- Lead Wire: UL1571 #28 AWG
- Weight: 10.0 g

Model No.	Bearing	Rated Voltage VDC	Operating Voltage Range VDC	Speed RPM	Max. Airflow CFM	Max. Static Pressure mm-H ₂ O	Current mA	Power Consumption W	Life at 40°C L10 Hour	P-Q Curve	Noise Level dB(A)
FD052515MB	2B	05	4~5.5	9000	2.1	3.1	70	0.35	80000	2	24.0
FD052515HB	2B		4~5.5	11000	2.6	4.7	100	0.50	75000	1	28.0
FD122515MB	2B	12	7~13.2	9000	2.1	3.1	45	0.54	80000	2	24.0
FD122515HB	2B		7~13.2	11000	2.6	4.7	60	0.72	75000	1	28.0

2B: 2-ball bearing L: sintetico bearing S: sleeve bearing

Voltage Available
05 12 24 48

Bearing System Available
2B L S

Function Available
N A I F R Q S T M V C P D W U

PERFORMANCE P-Q CURVE

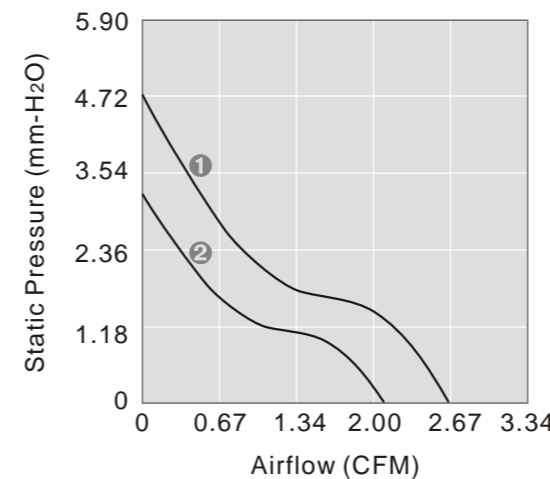

OUTLINE DIMENSIONS

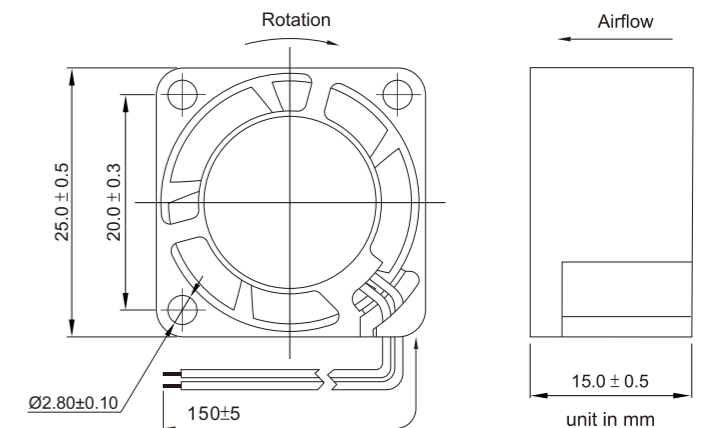

Please refer to Model Numbering System for bearing, function and speed level indication. Specifications are subject to changes without notice. Please refer to the formally issued product specification via contacting Y.S. TECH sales department. Visit Y.S. TECH web site at <http://www.ystech.com.tw> for updated information. Customized Specifications are designed accordingly.



30x30x10mm

- Airflow: 2.5~4.0 CFM
- Static Pressure: 2.0~5.2 mm-H₂O
- Blade / Housing: Plastic Material UL 94V-0 P.B.T.
- Lead Wire: UL1571 #28 AWG
- Weight: 9 g

Model No.	Bearing	Rated Voltage VDC	Operating Voltage Range VDC	Speed RPM	Max. Airflow CFM	Max. Static Pressure mm-H ₂ O	Current mA	Power Consumption W	Life at 40°C L10 Hour	P-Q Curve	Noise Level dB(A)
FD053010LB-N	2B	05	4~5.5	5800	2.5	2.0	50	0.25	80000	4	<17.0
FD053010MB-N	2B		4~5.5	6800	3.0	2.7	80	0.40	80000	3	18.0
FD053010HB-N	2B		4~5.5	7800	3.4	3.3	90	0.45	75000	2	21.5
FD053010EB-N	2B		4~5.5	10000	4.0	5.2	120	0.60	65000	1	28.0
FD123010LB-N	2B	12	9~13.2	5800	2.5	2.0	35	0.42	80000	4	<17.0
FD123010MB-N	2B		7~13.2	6800	3.0	2.7	40	0.48	80000	3	18.0
FD123010HB-N	2B		7~13.2	7800	3.4	3.3	40	0.48	75000	2	21.5
FD123010EB-N	2B		7~13.2	10000	4.0	5.2	60	0.72	65000	1	28.0

2B: 2-ball bearing L: sintetico bearing S: sleeve bearing

Voltage Available
05 12 24 48

Bearing System Available
2B L S

Function Available
N A I F R Q S T M V C P D W U

PERFORMANCE P-Q CURVE

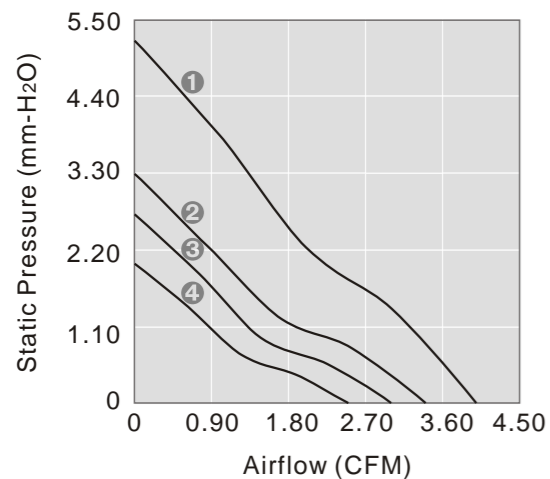

OUTLINE DIMENSIONS

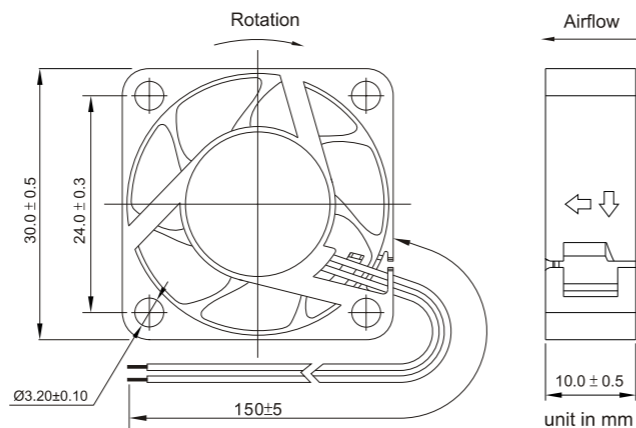

Please refer to Model Numbering System for bearing, function and speed level indication. Specifications are subject to changes without notice. Please refer to the formally issued product specification via contacting Y.S. TECH sales department. Visit Y.S. TECH web site at <http://www.ystech.com.tw> for updated information. Customized Specifications are designed accordingly.



30x30x15mm

- Airflow: 3.8~6.1 CFM
- Static Pressure: 2.8~7.1 mm-H₂O
- Blade / Housing: Plastic Material UL 94V-0 P.B.T.
- Lead Wire: UL1571 #28 AWG
- Weight: 13 g

Model No.	Bearing	Rated Voltage VDC	Operating Voltage Range VDC	Speed RPM	Max. Airflow CFM	Max. Static Pressure mm-H ₂ O	Current mA	Power Consumption W	Life at 40°C L10 Hour	P-Q Curve	Noise Level dB(A)
FD053015LB-N	2B	05	4~5.5	7000	3.8	2.8	60	0.30	80000	4	<17.0
FD053015MB-N	2B		4~5.5	8000	4.4	3.7	85	0.425	80000	3	20.5
FD053015HB-N	2B		4~5.5	9000	4.9	4.4	110	0.55	75000	2	25.0
FD053015EB-N	2B		4~5.5	11000	5.7	6.3	200	1.00	65000	1	30.0
FD123015LB-N	2B	12	7~13.2	7000	3.8	2.8	30	0.36	80000	4	<17.0
FD123015MB-N	2B		7~13.2	8000	4.4	3.7	40	0.48	80000	3	20.5
FD123015HB-N	2B		7~13.2	9000	4.9	4.4	45	0.54	75000	2	25.0
FD123015EB-N	2B		7~13.2	11500	6.1	7.1	90	1.08	65000	1	30.0

2B: 2-ball bearing L: sintetico bearing S: sleeve bearing

Voltage Available
05 12 24 48

Bearing System Available
2B L S

Function Available
N A I F R Q S T M V C P D W U

PERFORMANCE P-Q CURVE

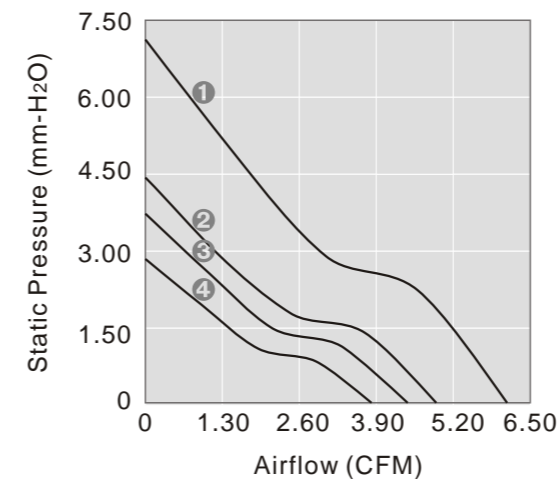

OUTLINE DIMENSIONS

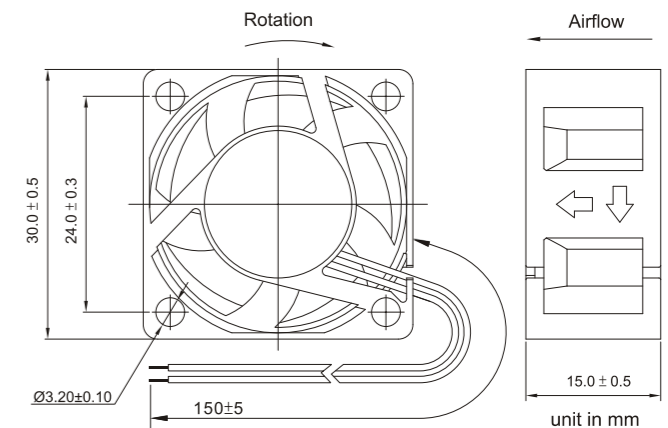

Please refer to Model Numbering System for bearing, function and speed level indication. Specifications are subject to changes without notice. Please refer to the formally issued product specification via contacting Y.S. TECH sales department. Visit Y.S. TECH web site at <http://www.ystech.com.tw> for updated information. Customized Specifications are designed accordingly.



40x40x10mm

- Airflow: 4.5~8.1 CFM
- Static Pressure: 2.0~5.4 mm-H₂O
- Blade / Housing: Plastic Material UL 94V-0 P.B.T.
- Lead Wire: UL1007 #26 AWG
- Weight: 15 g

Model No.	Bearing	Rated Voltage VDC	Operating Voltage Range VDC	Speed RPM	Max. Airflow CFM	Max. Static Pressure mm-H ₂ O	Current mA	Power Consumption W	Life at 40°C L10 Hour	P-Q Curve	Noise Level dB(A)
FD054010LB	2B	05	4~5.5	4500	4.5	2.0	90	0.45	80000	4	21.5
FD054010MB	2B		4~5.5	5500	5.6	2.9	130	0.65	80000	3	26.5
FD054010HB	2B		4~5.5	6500	6.6	4.1	170	0.85	75000	2	29.0
FD054010EB	2B		4~5.5	7500	8.1	5.4	250	1.25	65000	1	34.5
FD124010LB	2B	12	7~13.2	4500	4.5	2.0	45	0.54	80000	4	21.5
FD124010MB	2B		7~13.2	5500	5.3	2.9	65	0.78	80000	3	25.0
FD124010HB	2B		7~13.2	6500	6.6	4.1	75	0.90	75000	2	29.0
FD124010EB	2B		7~13.2	7500	8.1	5.4	120	1.44	65000	1	34.5
FD244010LB	2B	24	12~26.4	4500	4.5	2.0	50	1.20	80000	4	21.5
FD244010MB	2B		12~26.4	5500	5.3	2.9	60	1.44	80000	3	25.0
FD244010HB	2B		12~26.4	6500	6.6	4.1	70	1.68	75000	2	29.0
FD244010EB	2B		12~26.4	7500	8.1	5.4	120	1.44	65000	1	34.5

2B: 2-ball bearing L: sintetico bearing S: sleeve bearing

Voltage Available
05|12|24|48

Bearing System Available
2B|L|S

Function Available
N|A|I|F|R|Q|S|T|M|V|C|P|D|W|U

PERFORMANCE P-Q CURVE

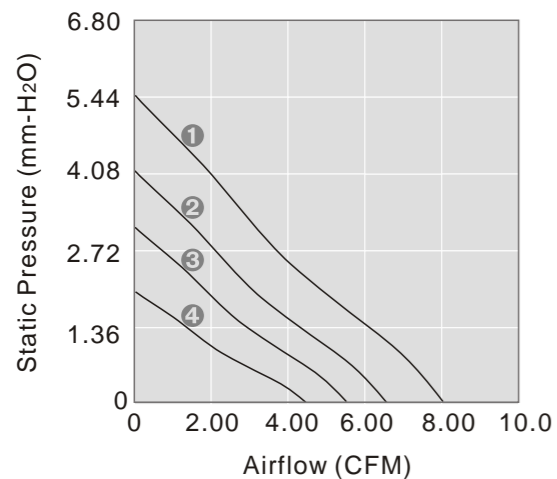

OUTLINE DIMENSIONS

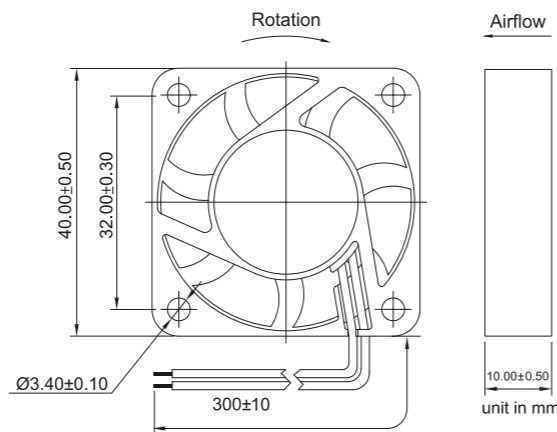

Please refer to Model Numbering System for bearing, function and speed level indication. Specifications are subject to changes without notice. Please refer to the formally issued product specification via contacting Y.S. TECH sales department. Visit Y.S. TECH web site at <http://www.ystech.com.tw> for updated information. Customized Specifications are designed accordingly.



40x40x15mm

- Airflow: 6.1~9.5 CFM
- Static Pressure: 4.6~8.7 mm-H₂O
- Blade / Housing: Plastic Material UL 94V-0 P.B.T.
- Lead Wire: UL1007 #26 AWG
- Weight: 26 g

Model No.	Bearing	Rated Voltage VDC	Operating Voltage Range VDC	Speed RPM	Max. Airflow CFM	Max. Static Pressure mm-H ₂ O	Current mA	Power Consumption W	Life at 40°C L10 Hour	P-Q Curve	Noise Level dB(A)
FD054015LB	2B	05	4~5.5	6000	6.1	4.6	200	1.00	80000	3	28.0
FD054015MB	2B		4~5.5	7300	7.5	6.8	280	1.40	80000	2	32.0
FD124015LB	2B		7~13.2	6000	6.1	4.6	80	0.96	80000	3	28.0
FD124015MB	2B		7~13.2	7300	7.5	6.8	120	1.44	80000	2	32.0
FD124015HB	2B	12	7~13.2	8600	9.5	8.7	160	1.92	75000	1	36.5

2B: 2-ball bearing L: sintetico bearing S: sleeve bearing

Voltage Available
05|12|24|48

Bearing System Available
2B|L|S

Function Available
N|A|I|F|R|Q|S|T|M|V|C|P|D|W|U

PERFORMANCE P-Q CURVE

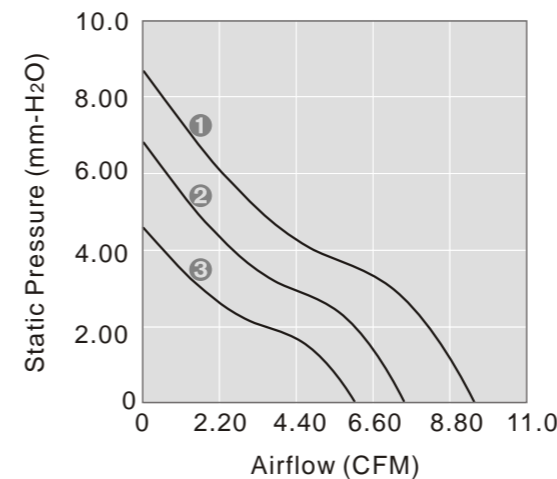

OUTLINE DIMENSIONS

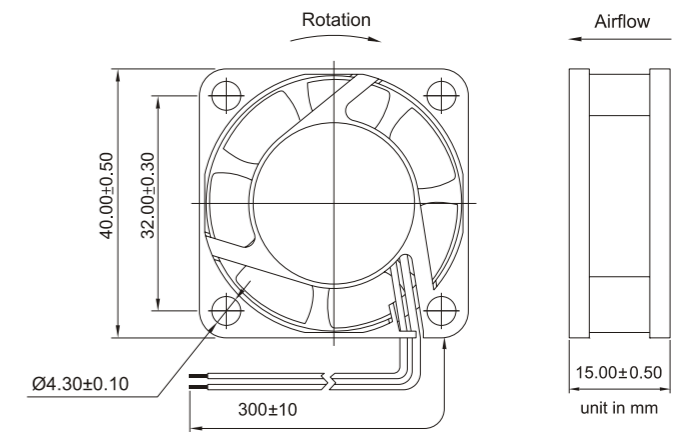

Please refer to Model Numbering System for bearing, function and speed level indication. Specifications are subject to changes without notice. Please refer to the formally issued product specification via contacting Y.S. TECH sales department. Visit Y.S. TECH web site at <http://www.ystech.com.tw> for updated information. Customized Specifications are designed accordingly.



40x40x15mm

- Airflow: 5.6~14.6 CFM
- Static Pressure: 2.6~14.6 mm-H2O
- Blade / Housing: Plastic Material UL 94V-0 P.B.T.
- Lead Wire: UL1007 #26 AWG
- Weight: 26 g

Model No.	Bearing	Rated Voltage VDC	Operating Voltage Range VDC	Speed RPM	Max. Airflow CFM	Max. Static Pressure mm-H2O	Current mA	Power Consumption W	Life at 40°C L10 Hour	P-Q Curve	Noise Level dB(A)
FD124015LB-N	2B	12	7~13.2	5000	5.6	2.6	90	1.08	80000	6	24.0
FD124015MB-N	2B	12	7~13.2	6000	6.6	3.5	100	1.20	80000	5	29.3
FD124015HB-N	2B	12	7~13.2	7000	8.2	5.1	130	1.56	75000	4	33.2
FD124015EB-N	2B	12	7~13.2	8300	9.4	7.1	190	2.28	65000	3	36.8
FD124015EB-N	2B	12	7~13.2	9500	11.2	9.1	240	2.88	65000	2	40.8
FD124015UB-N	2B	12	7~13.2	11000	14.6	14.6	280	3.36	65000	1	42.5

2B: 2-ball bearing L: sintetico bearing S: sleeve bearing

Voltage Available
05 12 24 48

Bearing System Available
2B L S

Function Available
N A I F R Q S T M V C P D W U

PERFORMANCE P-Q CURVE

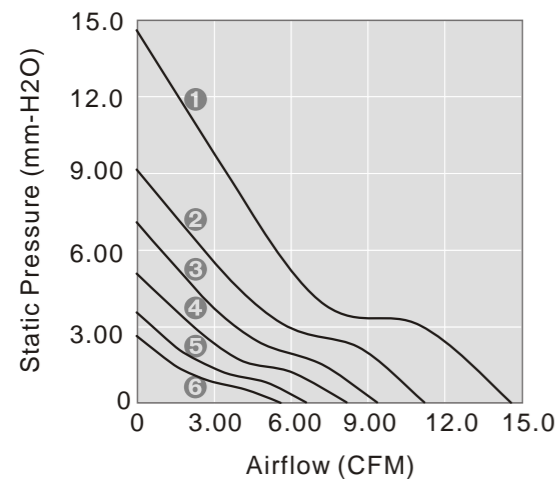

OUTLINE DIMENSIONS

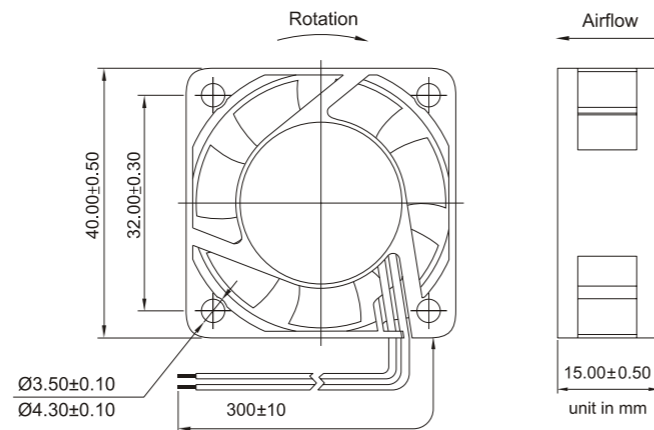

Please refer to Model Numbering System for bearing, function and speed level indication. Specifications are subject to changes without notice. Please refer to the formally issued product specification via contacting Y.S. TECH sales department. Visit Y.S. TECH web site at <http://www.ystech.com.tw> for updated information. Customized Specifications are designed accordingly.



40x40x20mm

- Airflow: 5.7~12.0 CFM
- Static Pressure: 3.2~11.5 mm-H2O
- Blade / Housing: Plastic Material UL 94V-0 P.B.T.
- Lead Wire: UL1007 #26 AWG
- Weight: 24 g

Model No.	Bearing	Rated Voltage VDC	Operating Voltage Range VDC	Speed RPM	Max. Airflow CFM	Max. Static Pressure mm-H2O	Current mA	Power Consumption W	Life at 40°C L10 Hour	P-Q Curve	Noise Level dB(A)
FD124020LB -H	2B	12	7~13.2	5000	5.7	3.2	70	0.84	80000	5	20.0
FD124020MB-H	2B	12	7~13.2	6300	7.2	5.2	100	1.20	80000	4	25.5
FD124020HB-H	2B	12	7~13.2	7600	9.0	6.4	140	1.68	75000	3	29.5
FD124020EB-H	2B	12	7~13.2	8900	10.5	9.2	170	2.04	65000	2	33.5
FD124020UB-H	2B	12	7~13.2	10000	12.0	11.5	210	2.52	65000	1	37.5
FD244020LB -H	2B	24	12~26.4	5000	5.7	3.2	40	0.96	80000	5	20.0
FD244020MB-H	2B	24	12~26.4	6300	7.2	5.2	50	1.20	80000	4	25.5
FD244020HB-H	2B	24	12~26.4	7600	9.0	6.4	70	1.68	75000	3	29.5
FD244020EB-H	2B	24	12~26.4	8900	10.5	9.2	100	2.40	65000	2	33.5
FD244020UB-H	2B	24	12~26.4	10000	12.0	11.5	130	3.12	65000	1	37.5

2B: 2-ball bearing L: sintetico bearing S: sleeve bearing

Voltage Available
05 12 24 48

Bearing System Available
2B L S

Function Available
N A I F R Q S T M V C P D W U

PERFORMANCE P-Q CURVE

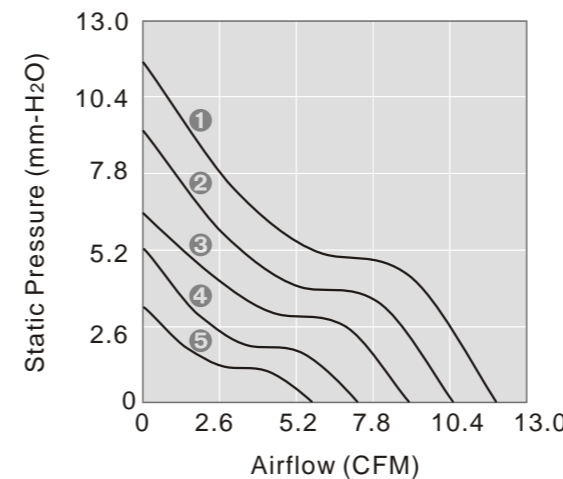

OUTLINE DIMENSIONS

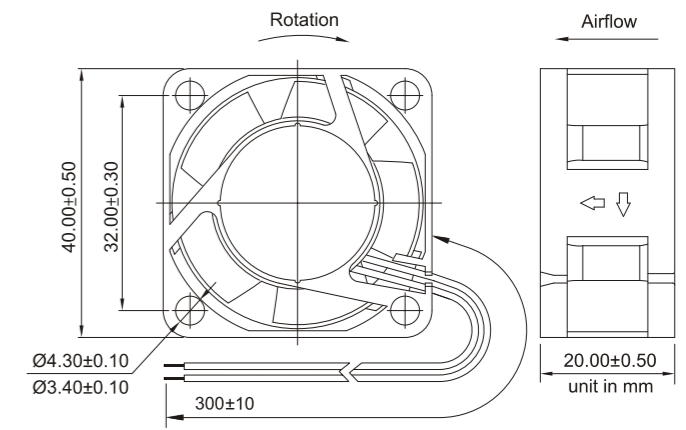

Please refer to Model Numbering System for bearing, function and speed level indication. Specifications are subject to changes without notice. Please refer to the formally issued product specification via contacting Y.S. TECH sales department. Visit Y.S. TECH web site at <http://www.ystech.com.tw> for updated information. Customized Specifications are designed accordingly.



45x45x10mm

- Airflow: 8.0~10.3 CFM
- Static Pressure: 2.5~4.8 mm-H₂O
- Blade / Housing: Plastic Material UL 94V-0 P.B.T.
- Lead Wire: UL1007 #26 AWG
- Weight: 17 g

Model No.	Bearing	Rated Voltage VDC	Operating Voltage Range VDC	Speed RPM	Max. Airflow CFM	Max. Static Pressure mm-H ₂ O	Current mA	Power Consumption W	Life at 40°C L10 Hour	P-Q Curve	Noise Level dB(A)
FD054510LS	S	5	4~5.5	4900	7.6	2.5	150	0.75	30000	3	28.5
FD054510MS	S	5	4~5.5	5300	8.5	3.0	170	0.85	30000	2	30.5
FD054510HS	S	5	4~5.5	6300	10.0	4.0	240	1.20	25000	1	35.5
FD054510LB	2B	5	4~5.5	5100	8.49	3.1	150	0.75	80000	3	29.0
FD054510MB	2B	5	4~5.5	5500	8.7	3.4	170	0.85	80000	2	31.5
FD054510HB	2B	5	4~5.5	6500	10.3	4.8	240	1.20	75000	1	37.0
FD124510LS	S	12	7~13.2	4900	7.6	2.5	90	1.08	30000	3	28.5
FD124510MS	S	12	7~13.2	5300	8.5	3.0	120	1.44	30000	2	30.5
FD124510HS	S	12	7~13.2	6300	10.0	4.0	140	1.68	25000	1	35.5
FD124510LB	2B	12	7~13.2	5100	8.49	3.1	90	1.08	80000	3	29.0
FD124510MB	2B	12	7~13.2	5500	8.7	3.4	120	1.44	80000	2	31.5
FD124510HB	2B	12	7~13.2	6500	10.3	4.8	140	1.68	75000	1	37.0

2B: 2-ball bearing L: sintetico bearing S: sleeve bearing

Voltage Available
05 12 24 48

Bearing System Available
2B L S

Function Available
N A I F R Q S T M V C P D W U

PERFORMANCE P-Q CURVE

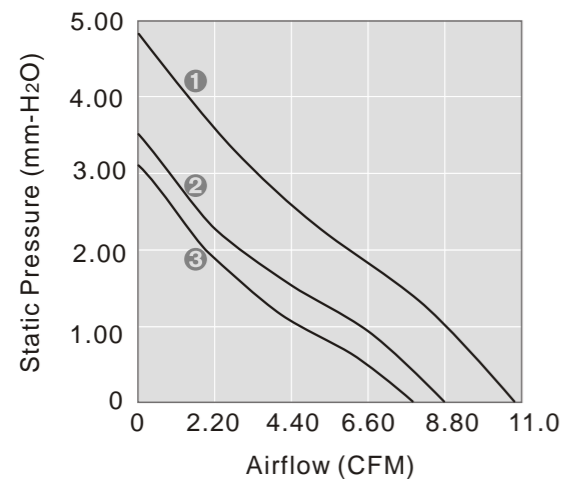

OUTLINE DIMENSIONS

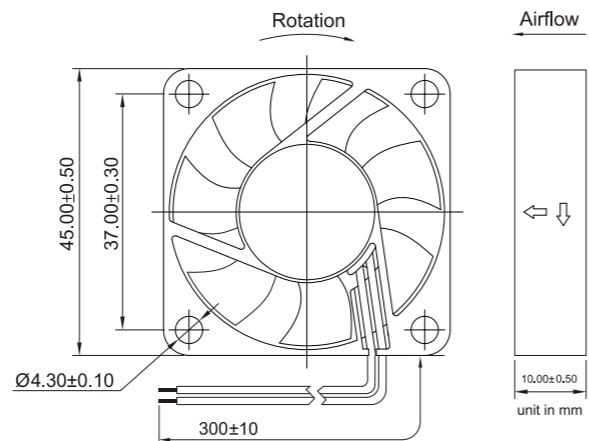

Please refer to Model Numbering System for bearing, function and speed level indication. Specifications are subject to changes without notice. Please refer to the formally issued product specification via contacting Y.S. TECH sales department. Visit Y.S. TECH web site at <http://www.ystech.com.tw> for updated information. Customized Specifications are designed accordingly.



50x50x10mm

- Airflow: 9.0~13.8 CFM
- Static Pressure: 1.7~4.1 mm-H₂O
- Blade / Housing: Plastic Material UL 94V-0 P.B.T.
- Lead Wire: UL1007 #26 AWG
- Weight: 18 g

Model No.	Bearing	Rated Voltage VDC	Operating Voltage Range VDC	Speed RPM	Max. Airflow CFM	Max. Static Pressure mm-H ₂ O	Current mA	Power Consumption W	Life at 40°C L10 Hour	P-Q Curve	Noise Level dB(A)
FD055010LB	2B	5	4~5.5	4000	9.0	1.7	150	0.75	80000	4	25.5
FD055010MB	2B	5	4~5.5	4600	10.7	2.6	170	0.85	80000	3	31.0
FD055010HB	2B	5	4~5.5	5200	12.0	3.0	215	1.08	75000	2	34.0
FD125010LB	2B	12	7~13.2	4200	9.5	1.9	90	1.08	80000	4	27.0
FD125010MB	2B	12	7~13.2	4600	10.7	2.6	120	1.44	80000	3	31.0
FD125010HB	2B	12	7~13.2	5200	12.0	3.0	140	1.68	75000	2	34.0
FD245010MB	2B	24	12~26.4	4600	10.7	2.6	60	1.44	80000	3	31.0
FD245010HB	2B	24	12~26.4	5200	12.0	3.0	100	2.40	75000	2	34.0

2B: 2-ball bearing L: sintetico bearing S: sleeve bearing

Voltage Available
05 12 24 48

Bearing System Available
2B L S

Function Available
N A I F R Q S T M V C P D W U

PERFORMANCE P-Q CURVE

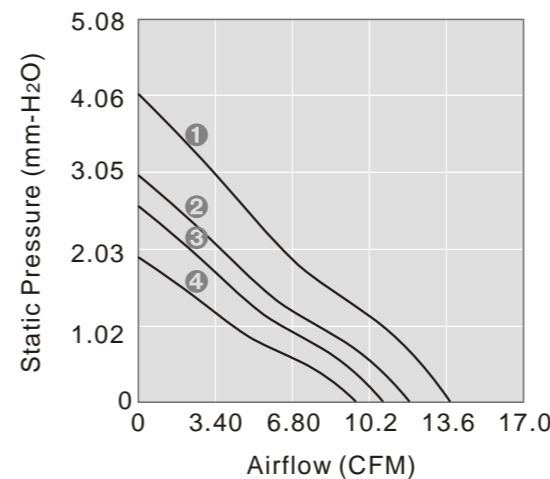

OUTLINE DIMENSIONS

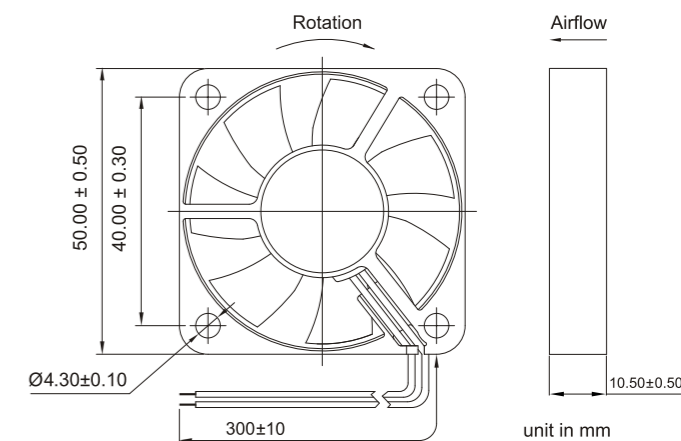

Please refer to Model Numbering System for bearing, function and speed level indication. Specifications are subject to changes without notice. Please refer to the formally issued product specification via contacting Y.S. TECH sales department. Visit Y.S. TECH web site at <http://www.ystech.com.tw> for updated information. Customized Specifications are designed accordingly.



50x50x15mm

- Airflow: 12.0~17.1 CFM
- Static Pressure: 2.0~4.4 mm-H₂O
- Blade / Housing: Plastic Material UL 94V-0 P.B.T.
- Lead Wire: UL1007 #26 AWG
- Weight: 27 g

Model No.	Bearing	Rated Voltage VDC	Operating Voltage Range VDC	Speed RPM	Max. Airflow CFM	Max. Static Pressure mm-H ₂ O	Current mA	Power Consumption W	Life at 40°C L10 Hour	P-Q Curve	Noise Level dB(A)
FD055015LB	2B	05	4~5.5	3800	12.0	2.0	180	0.90	80000	4	24.5
FD055015MB	2B		4~5.5	4500	13.1	3.2	250	1.25	80000	3	29.5
FD055015HB	2B		4~5.5	5000	15.5	3.6	285	1.43	75000	2	31.5
FD125015LB	2B	12	7~13.2	3800	12.0	2.0	85	1.02	80000	4	24.5
FD125015MB	2B		7~13.2	4500	13.1	3.2	130	1.56	80000	3	30.0
FD125015HB	2B		7~13.2	5000	15.5	3.6	170	2.04	75000	2	31.5
FD125015EB	2B	24	7~13.2	5500	17.1	4.4	220	2.64	65000	1	36.5
FD245015LB	2B		12~26.4	3800	12.0	2.0	70	1.68	80000	4	24.5
FD245015MB	2B		12~26.4	4500	13.1	3.2	80	1.92	80000	3	30.0
FD245015HB	2B	12~26.4	5000	15.5	3.6	90	2.16	75000	2	31.5	
FD245015EB	2B	12~26.4	5500	17.1	4.4	110	2.64	65000	1	36.5	

2B: 2-ball bearing L: sintetico bearing S: sleeve bearing

Voltage Available
05 12 24 48

Bearing System Available
2B L S

Function Available
N A I F R Q S T M V C P D W U

PERFORMANCE P-Q CURVE

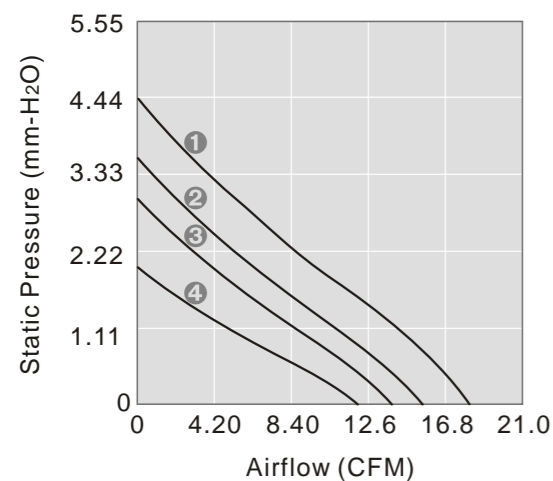

OUTLINE DIMENSIONS

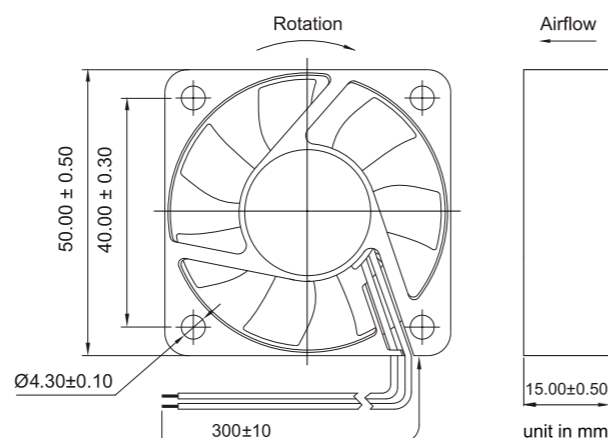

Please refer to Model Numbering System for bearing, function and speed level indication. Specifications are subject to changes without notice. Please refer to the formally issued product specification via contacting Y.S. TECH sales department. Visit Y.S. TECH web site at <http://www.ystech.com.tw> for updated information. Customized Specifications are designed accordingly.



50x50x20mm

- Airflow: 8.9~14.0 CFM
- Static Pressure: 2.1~5.5 mm-H₂O
- Blade / Housing: Plastic Material UL 94V-0 P.B.T.
- Lead Wire: UL1007 #26 AWG
- Weight: 36.0 g

Model No.	Bearing	Rated Voltage VDC	Operating Voltage Range VDC	Speed RPM	Max. Airflow CFM	Max. Static Pressure mm-H ₂ O	Current mA	Power Consumption W	Life at 40°C L10 Hour	P-Q Curve	Noise Level dB(A)
FD125020LS	S	12	7~13.2	3500	8.9	2.1	60	0.72	30000	3	22.5
FD125020MS	S		7~13.2	4300	11.0	4.0	90	1.08	30000	2	25.0
FD125020HS	S		7~13.2	5300	13.2	4.7	110	1.32	25000	1	30.0
FD125020LB	2B		7~13.2	3900	10.0	2.5	60	0.72	80000	3	23.5
FD125020MB	2B		7~13.2	4800	12.2	4.0	90	1.08	80000	2	28.0
FD125020HB	2B		7~13.2	5600	14.0	5.5	110	1.32	75000	1	32.5

2B: 2-ball bearing L: sintetico bearing S: sleeve bearing

Voltage Available
05 12 24 48

Bearing System Available
2B L S

Function Available
N A I F R Q S T M V C P D W U

PERFORMANCE P-Q CURVE

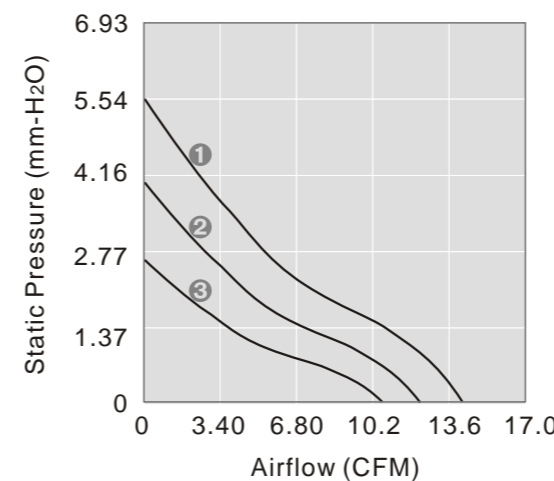

OUTLINE DIMENSIONS

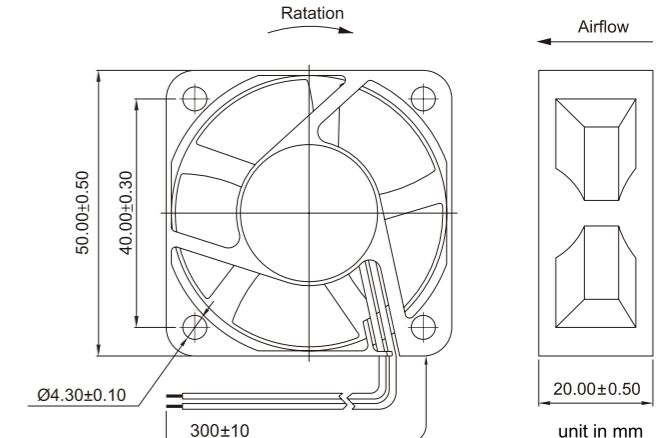

Please refer to Model Numbering System for bearing, function and speed level indication. Specifications are subject to changes without notice. Please refer to the formally issued product specification via contacting Y.S. TECH sales department. Visit Y.S. TECH web site at <http://www.ystech.com.tw> for updated information. Customized Specifications are designed accordingly.



60x60x10mm

- Airflow: 17.3~23.3 CFM
- Static Pressure: 2.1~4.0 mm-H₂O
- Blade / Housing: Plastic Material UL 94V-0 P.B.T.
- Lead Wire: UL1007 #26 AWG
- Weight: 26.0 g

Model No.	Bearing	Rated Voltage VDC	Operating Voltage Range VDC	Speed RPM	Max. Airflow CFM	Max. Static Pressure mm-H ₂ O	Current mA	Power Consumption W	Life at 40°C L10 Hour	P-Q Curve	Noise Level dB(A)
FD056010LB	2B	05	4~5.5	3800	17.3	2.1	260	1.30	80000	3	33.0
FD126010LS	S	12	7~13.2	3800	17.3	2.1	140	1.68	30000	3	37.5
FD126010MS	S		7~13.2	4500	21.0	3.0	170	2.04	30000	2	38.0
FD126010HS	S	7~13.2	5200	23.3	4.0	240	2.88	25000	1	41.0	
FD126010LB	2B	12	7~13.2	3800	17.3	2.1	140	1.68	80000	3	33.0
FD126010MB	2B		7~13.2	4500	21.0	3.0	170	2.04	80000	2	38.0
FD126010HB	2B	7~13.2	5200	23.3	4.0	240	2.88	75000	1	41.0	

2B: 2-ball bearing L: sintetico bearing S: sleeve bearing

Voltage Available
05 12 24 48

Bearing System Available
2B L S

Function Available
N A I F R Q S T M V C P D W U

PERFORMANCE P-Q CURVE

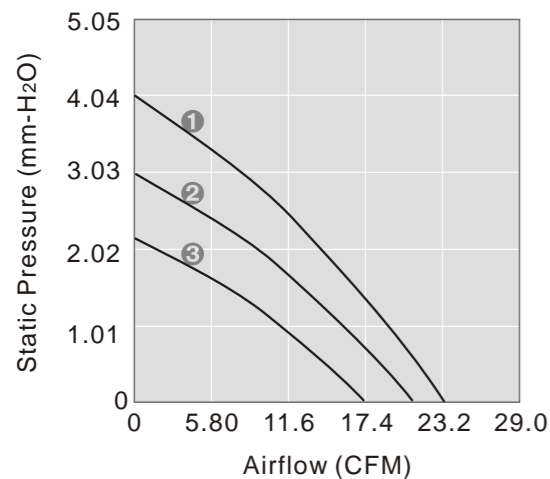

OUTLINE DIMENSIONS

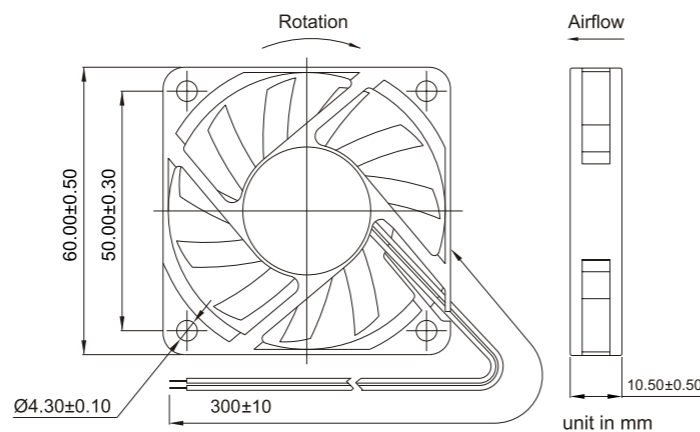

Please refer to Model Numbering System for bearing, function and speed level indication. Specifications are subject to changes without notice. Please refer to the formally issued product specification via contacting Y.S. TECH sales department. Visit Y.S. TECH web site at <http://www.ystech.com.tw> for updated information. Customized Specifications are designed accordingly.



60x60x15mm

- Airflow: 17.1~31.3 CFM
- Static Pressure: 2.0~5.3 mm-H₂O
- Blade / Housing: Plastic Material UL 94V-0 P.B.T.
- Lead Wire: UL1007 #26 AWG
- Weight: 26.0 g

Model No.	Bearing	Rated Voltage VDC	Operating Voltage Range VDC	Speed RPM	Max. Airflow CFM	Max. Static Pressure mm-H ₂ O	Current mA	Power Consumption W	Life at 40°C L10 Hour	P-Q Curve	Noise Level dB(A)
FD126015LB	2B	12	7~13.2	3200	17.0	2.0	100	1.20	80000	5	25.5
FD126015MB	2B		7~13.2	4000	21.0	3.0	160	1.92	80000	4	33.0
FD126015HB	2B	7~13.2	4700	24.1	3.9	220	2.64	75000	3	36.0	
FD126015EB	2B	7~13.2	5200	27.2	4.8	270	3.24	65000	2	40.0	
FD126015EB	2B	12	7~13.2	6000	31.3	5.3	400	4.80	65000	1	43.0
FD126015LS	S		7~13.2	3000	15.1	1.8	75	0.90	30000	5	24.0
FD126015MS	S	7~13.2	3800	19.8	2.6	140	1.68	30000	4	31.0	
FD126015HS	S	7~13.2	4700	24.1	3.9	220	2.64	25000	3	36.0	
FD246015LB	2B	24	12~26.4	3200	17.0	2.0	70	1.68	80000	5	25.5
FD246015MB	2B		12~26.4	4000	21.0	3.0	110	2.64	80000	4	33.0
FD246015HB	2B	12~26.4	4700	24.1	3.9	145	3.48	75000	3	36.0	
FD246015LS	S	12~26.4	3000	15.1	1.8	90	2.16	30000	5	24.0	
FD246015MS	S	12~26.4	3800	19.8	2.6	110	2.64	30000	4	31.0	

2B: 2-ball bearing L: sintetico bearing S: sleeve bearing

Voltage Available
05 12 24 48

Bearing System Available
2B L S

Function Available
N A I F R Q S T M V C P D W U

PERFORMANCE P-Q CURVE

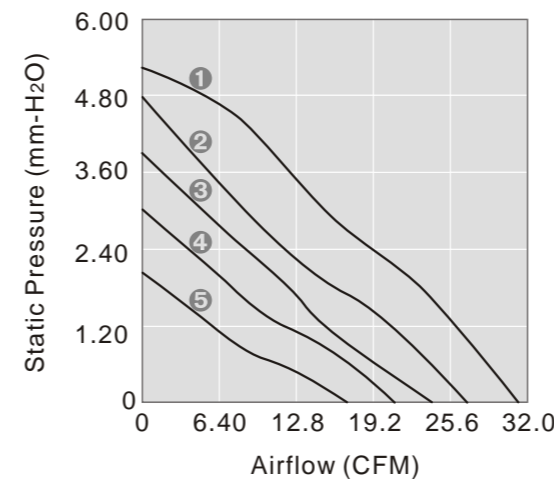

OUTLINE DIMENSIONS

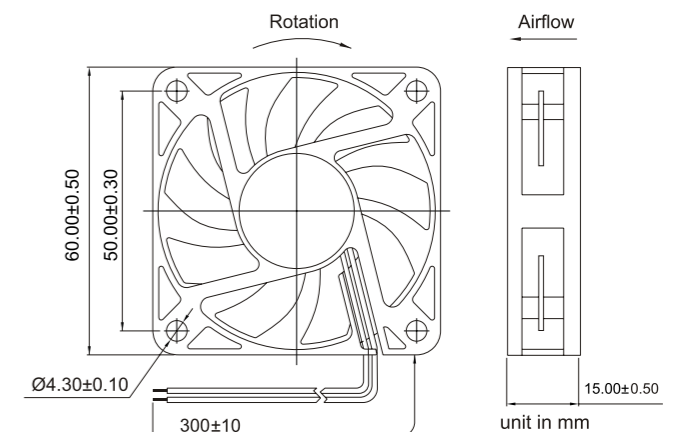

Please refer to Model Numbering System for bearing, function and speed level indication. Specifications are subject to changes without notice. Please refer to the formally issued product specification via contacting Y.S. TECH sales department. Visit Y.S. TECH web site at <http://www.ystech.com.tw> for updated information. Customized Specifications are designed accordingly.



60x60x20mm

- Airflow: 17.1~29.1 CFM
- Static Pressure: 2.4~7.0 mm-H₂O
- Blade / Housing: Plastic Material UL 94V-0 P.B.T.
- Lead Wire: UL1007 #26 AWG
- Weight: 44.0 g

Model No.	Bearing	Rated Voltage VDC	Operating Voltage Range VDC	Speed RPM	Max. Airflow CFM	Max. Static Pressure mm-H ₂ O	Current mA	Power Consumption W	Life at 40°C L10 Hour	P-Q Curve	Noise Level dB(A)
FD126020LB	2B	12	7~13.2	3000	17.0	2.4	80	0.96	80000	4	26.0
FD126020MB	2B	12	7~13.2	3600	20.0	3.4	110	1.32	80000	3	30.0
FD126020HB	2B	12	7~13.2	4200	22.9	4.4	160	1.92	75000	2	35.0
FD126020EB	2B	12	7~13.2	5300	29.1	7.0	280	3.36	65000	1	41.0
FD126020LS	S	12	7~13.2	2800	15.2	2.0	80	0.96	30000	4	25.0
FD126020MS	S	12	7~13.2	3400	18.0	2.7	110	1.32	30000	3	28.0
FD126020HS	S	12	7~13.2	4000	21.8	4.0	160	1.92	25000	2	35.0
FD126020ES	S	12	7~13.2	5300	29.2	7.0	250	3.00	25000	1	41.0
FD246020LB	2B	24	12~26.4	3000	17.0	2.4	40	0.96	80000	4	26.0
FD246020MB	2B	24	12~26.4	3600	20.0	3.4	70	1.68	80000	3	30.0
FD246020HB	2B	24	12~26.4	4200	22.9	4.4	80	1.92	75000	2	35.0
FD246020MS	S	24	12~26.4	3400	18.0	2.7	70	1.68	30000	3	28.0
FD246020HS	S	24	12~26.4	4000	21.8	4.0	80	1.92	25000	2	35.0

2B: 2-ball bearing L: sintetico bearing S: sleeve bearing

Voltage Available
05 12 24 48

Bearing System Available
2B L S

Function Available
N A I F R Q S T M V C P D W U

PERFORMANCE P-Q CURVE

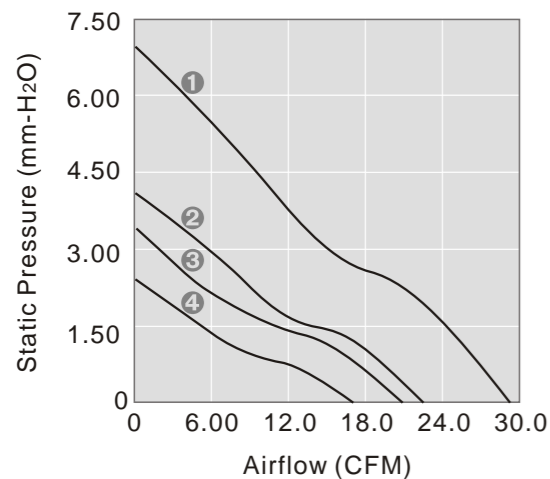

OUTLINE DIMENSIONS

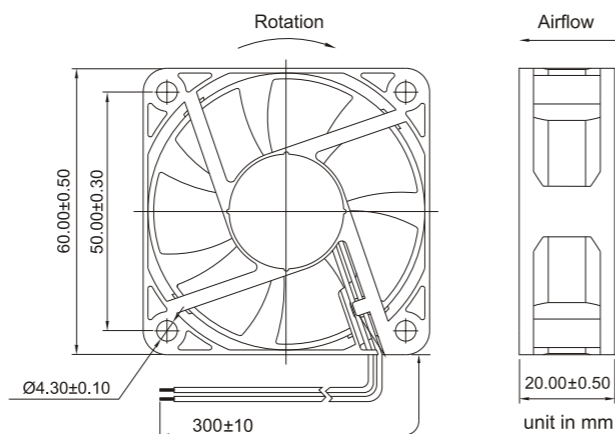

Please refer to Model Numbering System for bearing, function and speed level indication. Specifications are subject to changes without notice. Please refer to the formally issued product specification via contacting Y.S. TECH sales department. Visit Y.S. TECH web site at <http://www.ystech.com.tw> for updated information. Customized Specifications are designed accordingly.



60x60x25mm

- Airflow: 15.8~40.1 CFM
- Static Pressure: 2.4~14.2 mm-H₂O
- Blade / Housing: Plastic Material UL 94V-0 P.B.T.
- Lead Wire: UL1007 #24 AWG
- Weight: 56 g

Model No.	Bearing	Rated Voltage VDC	Operating Voltage Range VDC	Speed RPM	Max. Airflow CFM	Max. Static Pressure mm-H ₂ O	Current mA	Power Consumption W	Life at 40°C L10 Hour	P-Q Curve	Noise Level dB(A)
FD126025LB	2B	12	7~13.2	2800	15.8	2.4	80	0.96	80000	5	23.5
FD126025MB	2B	12	7~13.2	3700	20.0	3.8	120	1.44	80000	4	29.5
FD126025HB	2B	12	7~13.2	4300	25.4	5.5	150	1.80	75000	3	34.0
FD126025EB	2B	12	7~13.2	5200	29.3	6.3	210	2.52	65000	2	40.5
FD126025EB	2B	12	7~13.2	6800	40.1	14.2	330	3.96	65000	1	48.0
FD246025LB	2B	24	12~26.4	2800	15.8	2.4	50	1.20	80000	5	23.5
FD246025MB	2B	24	12~26.4	3700	20.0	3.8	70	1.68	80000	4	29.5
FD246025HB	2B	24	12~26.4	4300	25.4	5.5	90	2.16	75000	3	34.0
FD246025EB	2B	24	12~26.4	5200	29.3	6.3	110	2.64	65000	2	40.5
FD246025EB	2B	24	12~26.4	6800	40.1	14.2	210	5.04	65000	1	48.0
FD486025LB	2B	48	24~56.0	2800	15.8	2.4	30	1.44	80000	5	23.5
FD486025MB	2B	48	24~56.0	3700	20.0	3.8	45	2.16	80000	4	29.5
FD486025HB	2B	48	24~56.0	4300	25.4	5.5	50	2.40	75000	3	34.0
FD486025EB	2B	48	24~56.0	5200	29.3	6.3	80	3.84	65000	2	40.5

2B: 2-ball bearing L: sintetico bearing S: sleeve bearing

Voltage Available
05 12 24 48

Bearing System Available
2B L S

Function Available
N A I F R Q S T M V C P D W U

PERFORMANCE P-Q CURVE

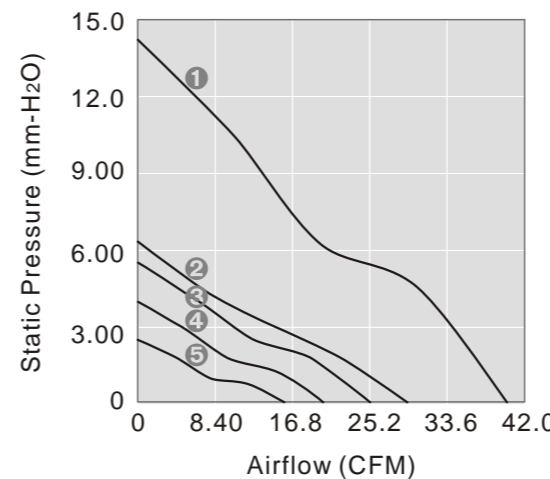

OUTLINE DIMENSIONS

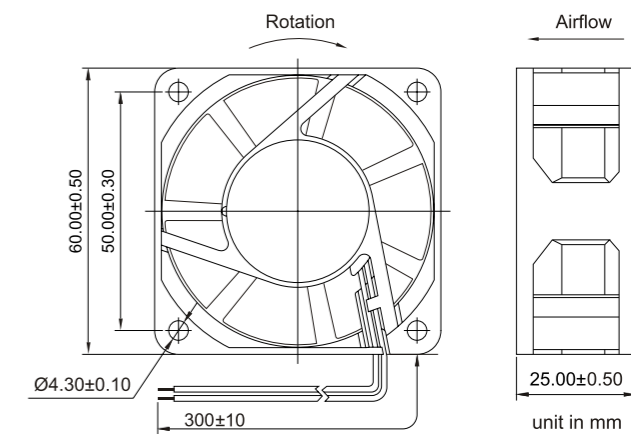

Please refer to Model Numbering System for bearing, function and speed level indication. Specifications are subject to changes without notice. Please refer to the formally issued product specification via contacting Y.S. TECH sales department. Visit Y.S. TECH web site at <http://www.ystech.com.tw> for updated information. Customized Specifications are designed accordingly.



60x60x25mm

- Airflow: 14.4~31.2 CFM
- Static Pressure: 5.0~11.8 mm-H₂O
- Blade / Housing: Plastic Material UL 94V-0 P.B.T.
- Lead Wire: UL1007 #24 AWG
- Weight: 56 g

Model No.	Bearing	Rated Voltage VDC	Operating Voltage Range VDC	Speed RPM	Max. Airflow CFM	Max. Static Pressure mm-H ₂ O	Current mA	Power Consumption W	Life at 40°C L10 Hour	P-Q Curve	Noise Level dB(A)
FD126025LB	2B	12	7~13.2	3000	14.4	5.0	50	0.60	80000	5	24.9
FD126025MB	2B	12	7~13.2	4100	19.7	7.5	80	0.96	80000	4	31.0
FD126025HB	2B	12	7~13.2	5100	24.5	9.3	120	1.44	75000	3	36.0
FD126025EB	2B	12	7~13.2	5600	26.9	10.2	150	1.80	65000	2	38.1
FD126025EB	2B	12	7~13.2	6500	31.2	11.8	190	2.28	65000	1	41.0
FD246025LB	2B	24	12~26.4	3000	14.4	5.0	35	0.84	80000	5	24.9
FD246025MB	2B	24	12~26.4	4100	19.7	7.5	55	1.32	80000	4	31.0
FD246025HB	2B	24	12~26.4	5100	24.5	9.3	75	1.80	75000	3	36.0
FD246025EB	2B	24	12~26.4	5600	26.9	10.2	100	2.40	65000	2	38.1
FD246025EB	2B	24	12~26.4	6500	31.2	11.8	110	2.64	65000	1	41.0

2B: 2-ball bearing L: sintetico bearing S: sleeve bearing

Voltage Available
05 12 24 48

Bearing System Available
2B L S

Function Available
N A I F R Q S T M V C P D W U

PERFORMANCE P-Q CURVE

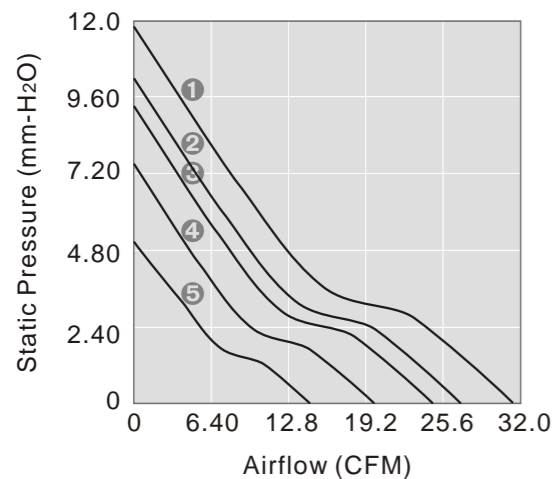

OUTLINE DIMENSIONS

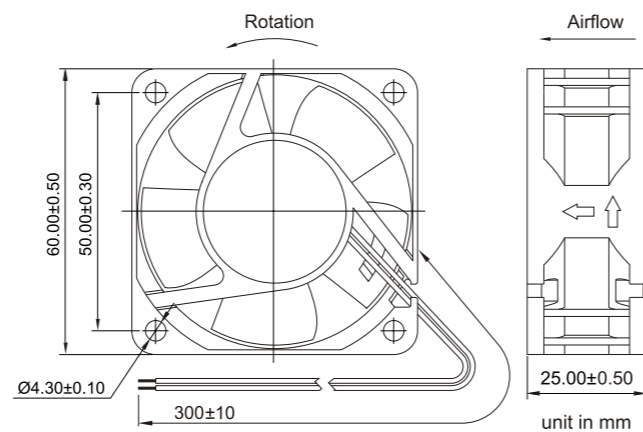

Please refer to Model Numbering System for bearing, function and speed level indication. Specifications are subject to changes without notice. Please refer to the formally issued product specification via contacting Y.S. TECH sales department. Visit Y.S. TECH web site at <http://www.ystech.com.tw> for updated information. Customized Specifications are designed accordingly.



70x70x10mm

- Airflow: 14.9~31.0 CFM
- Static Pressure: 2.3~4.8 mm-H₂O
- Blade / Housing: Plastic Material UL 94V-0 P.B.T.
- Lead Wire: UL1007 #26 AWG
- Weight: 35.0 g

Model No.	Bearing	Rated Voltage VDC	Operating Voltage Range VDC	Speed RPM	Max. Airflow CFM	Max. Static Pressure mm-H ₂ O	Current mA	Power Consumption W	Life at 40°C L10 Hour	P-Q Curve	Noise Level dB(A)
FD057010LB-H	2B	05	4~5.5	2300	14.9	2.3	160	0.80	80000	6	20.5
FD057010MB-H	2B	05	4~5.5	2700	17.5	2.7	200	1.00	80000	5	24.0
FD057010HB-H	2B	05	4~5.5	3100	20.1	3.1	270	1.35	75000	4	27.0
FD127010LB-H	2B	12	7~13.2	3700	23.9	3.7	130	1.56	80000	3	31.0
FD127010MB-H	2B	12	7~13.2	4300	27.8	4.3	170	2.04	80000	2	34.5
FD127010HB-H	2B	12	7~13.2	4800	31.0	4.8	240	2.88	75000	1	37.0

2B: 2-ball bearing L: sintetico bearing S: sleeve bearing

Voltage Available
05 12 24 48

Bearing System Available
2B L S

Function Available
N A I F R Q S T M V C P D W U

PERFORMANCE P-Q CURVE

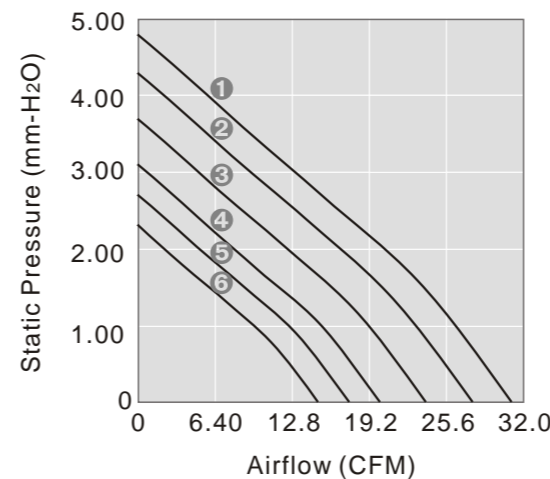

OUTLINE DIMENSIONS

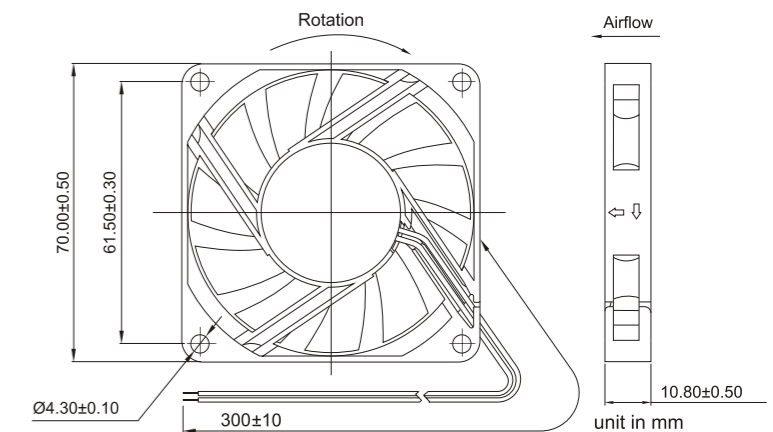

Please refer to Model Numbering System for bearing, function and speed level indication. Specifications are subject to changes without notice. Please refer to the formally issued product specification via contacting Y.S. TECH sales department. Visit Y.S. TECH web site at <http://www.ystech.com.tw> for updated information. Customized Specifications are designed accordingly.



70x70x15mm

- Airflow: 27.9~39.5 CFM
- Static Pressure: 3.5~6.8 mm-H₂O
- Blade / Housing: Plastic Material UL 94V-0 P.B.T.
- Lead Wire: UL1007 #26 AWG
- Weight: 54.0 g

Model No.	Bearing	Rated Voltage VDC	Operating Voltage Range VDC	Speed RPM	Max. Airflow CFM	Max. Static Pressure mm-H ₂ O	Current mA	Power Consumption W	Life at 40°C L10 Hour	P-Q Curve	Noise Level dB(A)
FD127015LB	2B	12	7~13.2	3800	27.9	3.5	130	1.56	80000	4	34.0
FD127015MB	2B	12	7~13.2	4300	31.6	4.4	190	2.28	80000	3	39.0
FD127015HB	2B	12	7~13.2	4800	35.3	5.4	260	3.12	75000	2	41.5
FD127015EB	2B	12	7~13.2	5500	39.5	6.8	400	4.80	65000	1	45.5
FD127015LS	S	12	7~13.2	3800	27.9	3.5	160	1.86	30000	4	34.0
FD127015MS	S	12	7~13.2	4300	31.6	4.4	220	2.64	30000	3	39.0
FD127015HS	S	12	7~13.2	4800	35.3	5.4	280	3.36	25000	2	41.5

2B: 2-ball bearing L: sintetico bearing S: sleeve bearing

Voltage Available
05 12 24 48

Bearing System Available
2B L S

Function Available
N A I F R Q S T M V C P D W U

PERFORMANCE P-Q CURVE

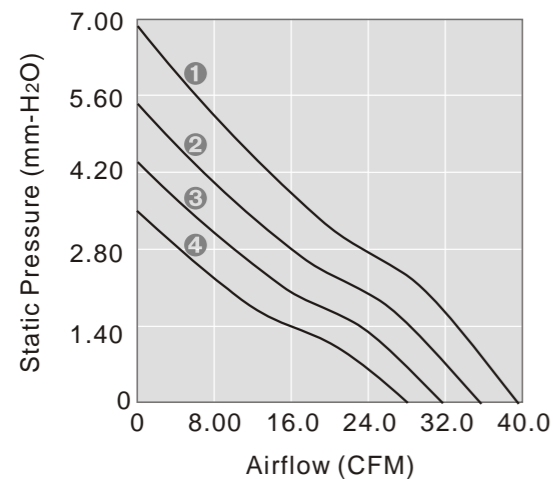

OUTLINE DIMENSIONS

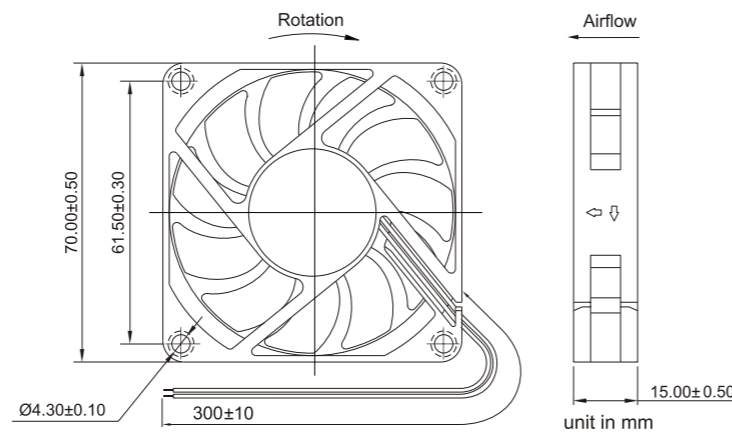

Please refer to Model Numbering System for bearing, function and speed level indication. Specifications are subject to changes without notice. Please refer to the formally issued product specification via contacting Y.S. TECH sales department. Visit Y.S. TECH web site at <http://www.ystech.com.tw> for updated information. Customized Specifications are designed accordingly.



70x70x25mm

- Airflow: 25.0~49.0 CFM
- Static Pressure: 3.0~10.06 mm-H₂O
- Blade / Housing: Plastic Material UL 94V-0 P.B.T.
- Lead Wire: UL1007 #24 AWG
- Weight: 82.0 g

Model No.	Bearing	Rated Voltage VDC	Operating Voltage Range VDC	Speed RPM	Max. Airflow CFM	Max. Static Pressure mm-H ₂ O	Current mA	Power Consumption W	Life at 40°C L10 Hour	P-Q Curve	Noise Level dB(A)
FD127025LB	2B	12	7~13.2	3000	25.0	3.0	90	1.08	80000	4	29.0
FD127025MB	2B	12	7~13.2	4000	33.1	5.0	170	2.04	80000	3	34.5
FD127025HB	2B	12	7~13.2	5000	40.5	7.2	300	3.60	75000	2	41.0
FD127025EB	2B	12	7~13.2	6000	49.0	10.6	400	4.80	65000	1	47.0
FD127025LS	S	12	7~13.2	2900	24.9	3.0	110	1.32	30000	4	28.0
FD127025MS	S	12	7~13.2	3900	33.0	4.9	210	2.52	30000	3	33.5
FD127025HS	S	12	7~13.2	4900	36.7	7.1	300	3.60	25000	2	40.0
FD127025ES	S	12	7~13.2	5900	48.1	10.2	400	4.80	20000	1	46.0

2B: 2-ball bearing L: sintetico bearing S: sleeve bearing

Voltage Available
05 12 24 48

Bearing System Available
2B L S

Function Available
N A I F R Q S T M V C P D W U

PERFORMANCE P-Q CURVE

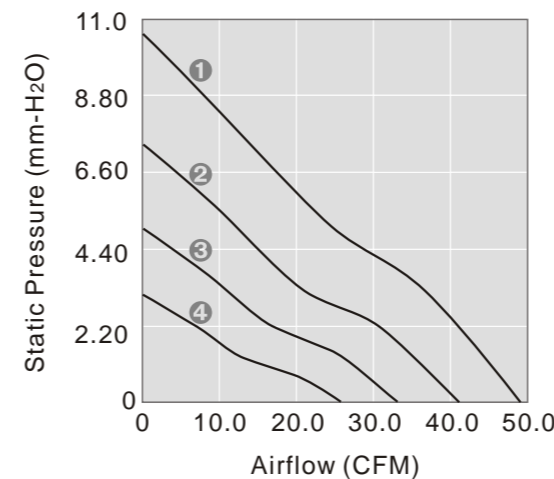

OUTLINE DIMENSIONS

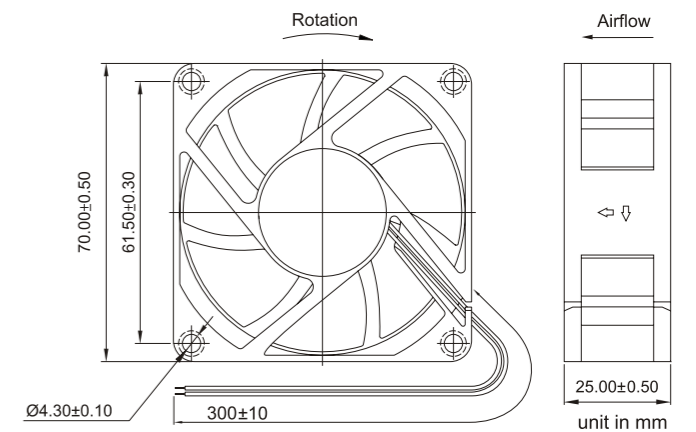

Please refer to Model Numbering System for bearing, function and speed level indication. Specifications are subject to changes without notice. Please refer to the formally issued product specification via contacting Y.S. TECH sales department. Visit Y.S. TECH web site at <http://www.ystech.com.tw> for updated information. Customized Specifications are designed accordingly.



80x80x15mm

- Airflow: 23.5~50.2 CFM
- Static Pressure: 1.4~5.8 mm-H₂O
- Blade / Housing: Plastic Material UL 94V-0 P.B.T.
- Lead Wire: UL1007 #26 AWG
- Weight: 50.0 g

Model No.	Bearing	Rated Voltage VDC	Operating Voltage Range VDC	Speed RPM	Max. Airflow CFM	Max. Static Pressure mm-H ₂ O	Current mA	Power Consumption W	Life at 40°C L10 Hour	P-Q Curve	Noise Level dB(A)
FD128015LB	2B	12	7~13.2	2100	23.5	1.4	70	0.84	80000	5	19.0
FD128015MB	2B	12	7~13.2	2600	29.1	1.9	100	1.20	80000	4	27.0
FD128015HB	2B	12	7~13.2	3200	35.8	2.7	190	2.28	75000	3	33.0
FD128015EB	2B	12	7~13.2	3900	43.6	4.3	250	3.00	65000	2	38.5
FD128015EB	2B	12	7~13.2	4500	50.2	5.8	380	4.56	65000	1	42.0
FD128015LL	L	12	7~13.2	2100	23.5	1.4	90	1.08	50000	5	19.0
FD128015ML	L	12	7~13.2	2600	29.1	1.9	140	1.68	50000	4	27.0
FD128015HL	L	12	7~13.2	3200	35.8	2.7	250	3.00	50000	3	30.5
FD128015EL	L	12	7~13.2	3900	43.6	4.3	330	3.96	50000	2	35.0

2B: 2-ball bearing L: sintetico bearing S: sleeve bearing

Voltage Available
05 12 24 48

Bearing System Available
2B L S

Function Available
N A I F R Q S T M V C P D W U

PERFORMANCE P-Q CURVE

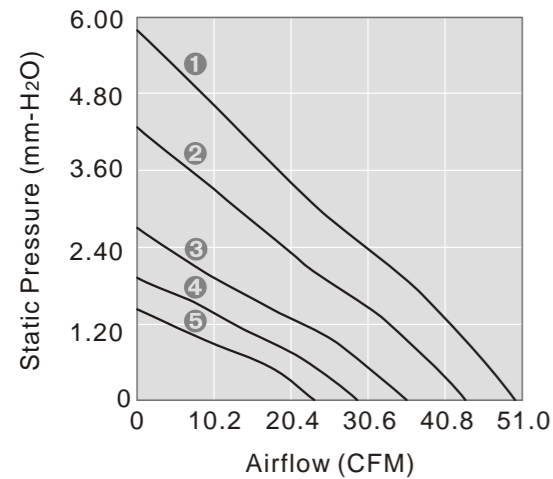

OUTLINE DIMENSIONS

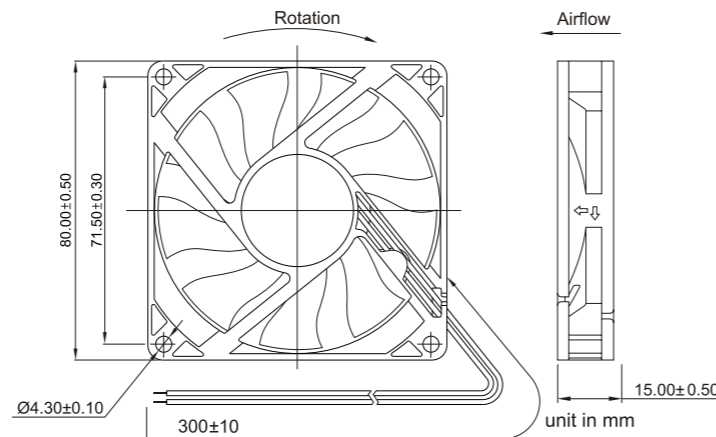

Please refer to Model Numbering System for bearing, function and speed level indication. Specifications are subject to changes without notice. Please refer to the formally issued product specification via contacting Y.S. TECH sales department. Visit Y.S. TECH web site at <http://www.ystech.com.tw> for updated information. Customized Specifications are designed accordingly



80x80x20mm

- Airflow: 22.7~37.0 CFM
- Static Pressure: 1.3~4.4 mm-H₂O
- Blade / Housing: Plastic Material UL 94V-0 P.B.T.
- Lead Wire: UL1007 #24 AWG
- Weight: 85.0 g

Model No.	Bearing	Rated Voltage VDC	Operating Voltage Range VDC	Speed RPM	Max. Airflow CFM	Max. Static Pressure mm-H ₂ O	Current mA	Power Consumption W	Life at 40°C L10 Hour	P-Q Curve	Noise Level dB(A)
FD128020LB	2B	12	7~13.2	2100	23.3	1.4	100	1.20	80000	4	22.9
FD128020MB	2B	12	7~13.2	2600	31.0	2.2	110	1.32	80000	3	27.0
FD128020HB	2B	12	7~13.2	3100	37.0	3.2	150	1.80	75000	2	33.5
FD128020EB	2B	12	7~13.2	3600	45.2	4.4	200	2.40	65000	1	38.0
FD128020LS	S	12	7~13.2	1900	22.7	1.3	100	1.20	30000	4	22.5
FD128020MS	S	12	7~13.2	2400	28.2	1.9	110	1.32	30000	3	25.0
FD128020HS	S	12	7~13.2	2900	23.3	3.1	150	1.80	25000	2	33.5
FD248020LB	2B	24	12~26.4	2100	23.3	1.4	50	1.20	80000	4	22.9
FD248020MB	2B	24	12~26.4	2600	31.0	2.2	66	1.58	80000	3	27.0
FD248020HB	2B	24	12~26.4	3100	37.0	3.2	100	2.40	75000	2	33.5

2B: 2-ball bearing L: sintetico bearing S: sleeve bearing

Voltage Available
05 12 24 48

Bearing System Available
2B L S

Function Available
N A I F R Q S T M V C P D W U

PERFORMANCE P-Q CURVE

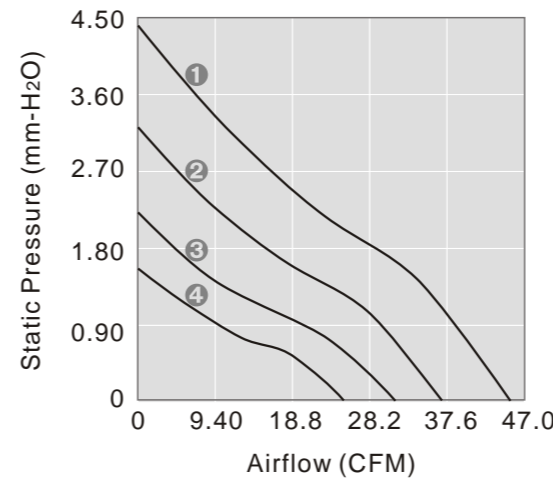

OUTLINE DIMENSIONS

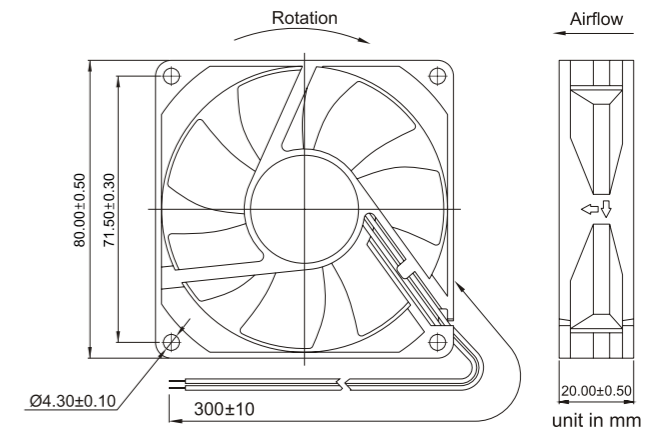

Please refer to Model Numbering System for bearing, function and speed level indication. Specifications are subject to changes without notice. Please refer to the formally issued product specification via contacting Y.S. TECH sales department. Visit Y.S. TECH web site at <http://www.ystech.com.tw> for updated information. Customized Specifications are designed accordingly



80x80x25mm

- Airflow: 27.9~48.5 CFM
- Static Pressure: 1.3~3.8 mm-H₂O
- Blade / Housing: Plastic Material UL 94V-0 P.B.T.
- Lead Wire: UL1007 #24 AWG
- Weight: 88 g



80x80x25mm

- Airflow: 26.3~59.6 CFM
- Static Pressure: 2.0~8.8 mm-H₂O
- Blade / Housing: Plastic Material UL 94V-0 P.B.T.
- Lead Wire: UL1007 #24 AWG
- Weight: 100 g

Model No.	Bearing	Rated Voltage VDC	Operating Voltage Range VDC	Speed RPM	Max. Airflow CFM	Max. Static Pressure mm-H ₂ O	Current mA	Power Consumption W	Life at 40°C L10 Hour	P-Q Curve	Noise Level dB(A)
FD128025LS	S	12	7~13.2	1900	27.9	1.3	100	1.20	30000	4	22.5
FD128025MS	S	12	7~13.2	2400	35.4	2.1	160	1.92	30000	3	27.5
FD128025HS	S	12	7~13.2	2900	43.7	2.9	230	2.76	25000	2	33.5
FD128025ES	S	12	7~13.2	3200	47.4	3.6	260	3.12	20000	1	36.0
FD128025LB	2B	12	7~13.2	2000	30.0	1.5	100	1.20	80000	4	23.5
FD128025MB	2B	12	7~13.2	2500	37.0	2.1	160	1.92	80000	3	30.0
FD128025HB	2B	12	7~13.2	3000	45.2	3.1	230	2.76	75000	2	34.5
FD128025EB	2B	12	7~13.2	3300	48.5	3.8	260	3.12	65000	1	37.0
FD248025LB	2B	24	12~26.4	2000	30.0	1.5	60	1.44	80000	4	23.5
FD248025MB	2B	24	12~26.4	2500	37.0	2.2	80	1.92	80000	3	30.0
FD248025HB	2B	24	12~26.4	3000	45.2	3.1	130	3.12	75000	2	34.5
FD488025LB	2B	48	24~56.0	2000	30.0	1.5	30	1.44	80000	4	23.5
FD488025MB	2B	48	24~56.0	2500	37.0	2.2	50	2.40	80000	3	30.0
FD488025HB	2B	48	24~56.0	3000	45.2	3.1	90	4.08	75000	2	34.5
FD488025EB	2B	48	24~56.0	3300	48.5	3.8	110	5.28	65000	1	37.0

Model No.	Bearing	Rated Voltage VDC	Operating Voltage Range VDC	Speed RPM	Max. Airflow CFM	Max. Static Pressure mm-H ₂ O	Current mA	Power Consumption W	Life at 40°C L10 Hour	P-Q Curve	Noise Level dB(A)
FD128025LS-N	S	12	7~13.2	2100	26.3	2.0	80	0.96	30000	6	26.0
FD128025MS-N	S	12	7~13.2	2600	32.7	3.1	130	1.56	30000	5	29.5
FD128025HS-N	S	12	7~13.2	3200	40.4	3.9	200	2.40	25000	4	35.5
FD128025ES-N	S	12	7~13.2	3500	46.0	5.2	250	3.00	20000	3	38.5
FD128025LB-N	2B	12	7~13.2	2300	28.8	2.2	80	0.96	80000	6	27.0
FD128025MB-N	2B	12	7~13.2	2900	36.9	3.6	130	1.56	80000	5	32.0
FD128025HB-N	2B	12	7~13.2	3400	41.7	4.5	140	1.68	75000	4	37.5
FD128025EB-N	2B	12	7~13.2	3700	48.5	5.8	250	3.00	65000	3	39.5
FD128025UB-N	2B	12	7~13.2	5500	64.1	12.5	500	6.00	65000	1	48.0
FD248025LB-N	2B	24	12~26.4	2300	28.8	2.2	60	1.44	80000	6	27.0
FD248025MB-N	2B	24	12~26.4	2900	36.9	3.6	80	1.92	80000	5	32.0
FD248025HB-N	2B	24	12~26.4	3400	41.7	4.5	100	2.40	75000	4	37.5
FD248025EB-N	2B	24	12~26.4	3700	48.5	5.8	110	2.64	65000	3	39.5
FD248025UB-N	2B	24	12~26.4	4500	59.6	8.8	280	3.36	65000	2	44.0
FD488025LB-N	2B	48	24~56.0	2900	36.9	3.6	45	2.16	80000	5	32.0
FD488025HB-N	2B	48	24~56.0	3400	41.7	4.5	80	3.84	75000	4	37.5
FD488025EB-N	2B	48	24~56.0	3700	48.5	5.9	90	4.08	75000	3	39.5

2B: 2-ball bearing L: sintetico bearing S: sleeve bearing

Voltage Available

Bearing System Available

05 12 24 48

2B L S

Function Available

N A I F R Q S T M V C P D W U

PERFORMANCE P-Q CURVE

OUTLINE DIMENSIONS

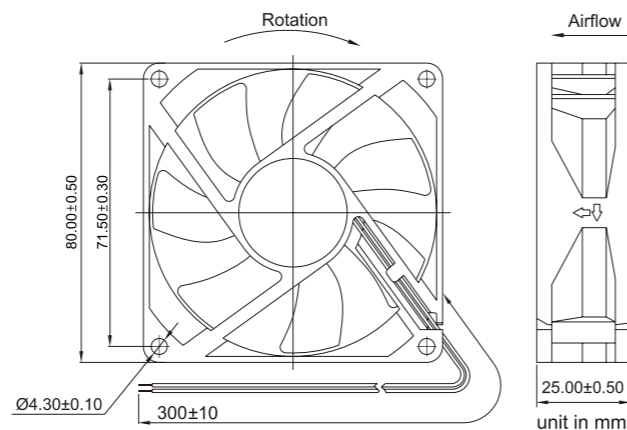
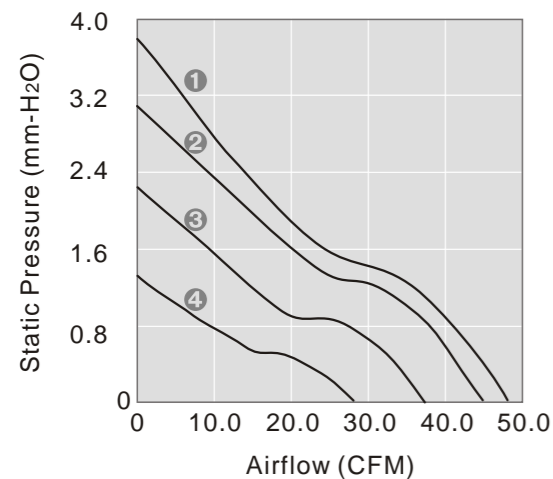

Please refer to Model Numbering System for bearing, function and speed level indication. Specifications are subject to changes without notice. Please refer to the formally issued product specification via contacting Y.S. TECH sales department. Visit Y.S. TECH web site at <http://www.ystech.com.tw> for updated information. Customized Specifications are designed accordingly.

2B: 2-ball bearing L: sintetico bearing S: sleeve bearing

Voltage Available

Bearing System Available

05 12 24 48

2B L S

Function Available

N A I F R Q S T M V C P D W U

PERFORMANCE P-Q CURVE

OUTLINE DIMENSIONS

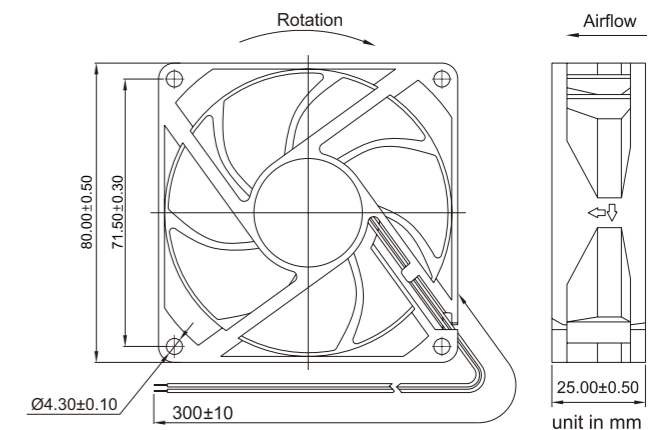
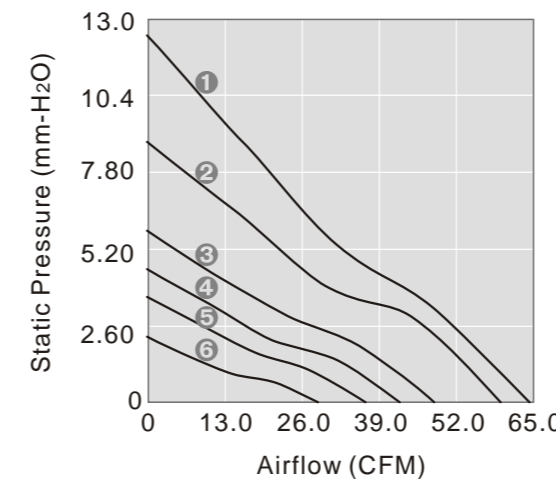

Please refer to Model Numbering System for bearing, function and speed level indication. Specifications are subject to changes without notice. Please refer to the formally issued product specification via contacting Y.S. TECH sales department. Visit Y.S. TECH web site at <http://www.ystech.com.tw> for updated information. Customized Specifications are designed accordingly.



92x92x25mm

- Airflow: 45.8~73.4 CFM
- Static Pressure: 3.1~7.2 mm-H₂O
- Blade / Housing: Plastic Material UL 94V-0 P.B.T.
- Lead Wire: UL1007 #24 AWG
- Weight: 100.0 g



92x92x25mm

- Airflow: 38.1~75.0 CFM
- Static Pressure: 1.5~4.8 mm-H₂O
- Blade / Housing: Plastic Material UL 94V-0 P.B.T.
- Lead Wire: UL1007 #24 AWG
- Weight: 100.0 g

Model No.	Bearing	Rated Voltage	Operating Voltage Range	Speed	Max. Airflow	Max. Static Pressure	Current	Power Consumption	Life at 40°C L10	P-Q Curve	Noise Level
		VDC	VDC	RPM	CFM	mm-H ₂ O	mA	W	Hour		dB(A)
FD129225LS	S		7~13.2	2400	45.8	3.1	150	1.80	30000	5	32.5
FD129225MS	S		7~13.2	2800	53.5	4.3	220	2.64	30000	4	38.0
FD129225HS	S		7~13.2	3100	58.6	5.2	260	3.12	25000	3	40.0
FD129225ES	S		7~13.2	3500	67.3	5.9	340	4.08	20000	2	43.0
FD129225ES	S		7~13.2	3800	73.4	7.3	470	5.64	20000	1	45.5
FD129225LB	2B	12	7~13.2	2400	45.8	3.1	150	1.80	80000	5	32.5
FD129225MB	2B	12	7~13.2	2800	53.5	4.3	220	2.64	80000	4	38.0
FD129225HB	2B	12	7~13.2	3100	58.6	5.2	260	3.12	75000	3	40.0
FD129225EB	2B	12	7~13.2	3500	67.3	5.9	340	4.08	65000	2	43.0
FD129225EB	2B	12	7~13.2	3800	73.4	7.2	470	5.64	65000	1	45.5
FD249225LB	2B	24	12~26.4	2400	45.8	3.1	90	2.16	80000	5	32.5
FD249225MB	2B	24	12~26.4	2800	53.5	4.3	120	2.88	80000	4	38.0
FD249225HB	2B	24	12~26.4	3100	58.6	5.2	160	3.84	75000	3	40.0
FD249225EB	2B	24	12~26.4	3500	67.3	5.9	200	4.80	65000	2	43.0
FD249225EB	2B	24	12~26.4	3800	73.4	7.3	270	6.48	65000	1	45.5
FD489225LB	2B	48	24~56.0	2400	45.8	3.1	55	2.64	80000	5	32.5
FD489225MB	2B	48	24~56.0	2800	53.5	4.3	80	3.84	80000	4	38.0
FD489225HB	2B	48	24~56.0	3100	58.6	5.2	100	4.80	75000	3	40.0

2B: 2-ball bearing L: sintetico bearing S: sleeve bearing

Voltage Available

Bearing System Available

Function Available

05 12 24 48

2B L S

N A I F R Q S T M V C P D W U

PERFORMANCE P-Q CURVE

OUTLINE DIMENSIONS

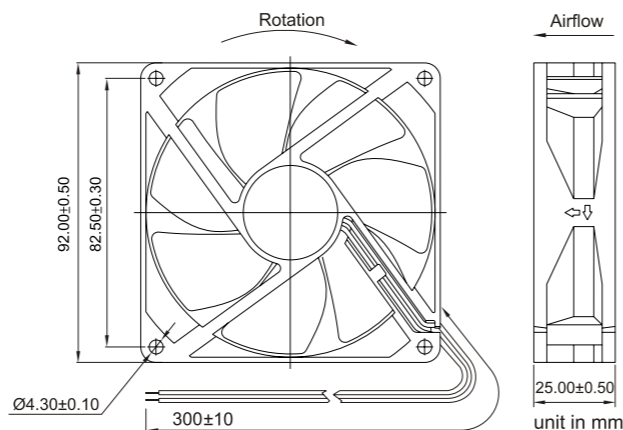
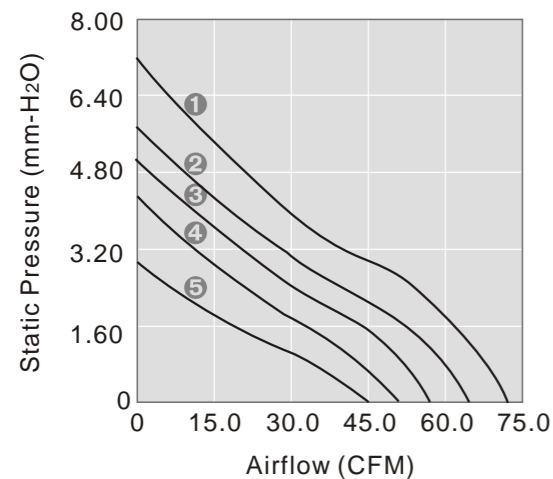

Please refer to Model Numbering System for bearing, function and speed level indication. Specifications are subject to changes without notice. Please refer to the formally issued product specification via contacting Y.S. TECH sales department. Visit Y.S. TECH web site at <http://www.ystech.com.tw> for updated information. Customized Specifications are designed accordingly.

Model No.	Bearing	Rated Voltage	Operating Voltage Range	Speed	Max. Airflow	Max. Static Pressure	Current	Power Consumption	Life at 40°C L10	P-Q Curve	Noise Level
		VDC	VDC	RPM	CFM	mm-H ₂ O	mA	W	Hour		dB(A)
FD129225LS-N	S		7~13.2	1800	38.1	1.5	100	1.20	30000	5	25.0
FD129225MS-N	S		7~13.2	2300	48.7	2.2	160	1.92	30000	4	32.0
FD129225HS-N	S		7~13.2	2700	61.4	2.7	200	2.40	25000	3	36.5
FD129225ES-N	S		7~13.2	3000	63.1	3.3	260	3.12	20000	2	39.0
FD129225LB-N	2B	12	7~13.2	1900	40.2	1.7	100	1.20	80000	5	25.0
FD129225MB-N	2B	12	7~13.2	2400	50.8	2.4	160	1.92	80000	4	33.0
FD129225HB-N	2B	12	7~13.2	2800	63.7	3.0	230	2.76	75000	3	37.5
FD129225EB-N	2B	12	7~13.2	3100	66.3	3.7	260	3.12	65000	2	40.0
FD129225EB-N	2B	12	7~13.2	3500	75.0	4.8	360	4.32	65000	1	42.5
FD249225LB-N	2B	24	12~26.4	1900	40.2	1.7	60	1.44	80000	5	25.0
FD249225MB-N	2B	24	12~26.4	2400	50.8	2.4	80	1.92	80000	4	33.0
FD249225HB-N	2B	24	12~26.4	2800	63.7	3.0	130	3.12	75000	3	37.5
FD249225EB-N	2B	24	12~26.4	3100	66.3	3.7	160	3.84	65000	2	40.0
FD249225EB-N	2B	24	12~26.4	3600	81.9	3.9	190	4.56	65000	1	47.5
FD489225LB-N	2B	48	24~56.0	1900	40.2	1.7	30	1.44	80000	5	25.0
FD489225MB-N	2B	48	24~56.0	2400	50.8	2.4	55	2.64	80000	4	33.0
FD489225HB-N	2B	48	24~56.0	2800	63.7	3.0	70	3.36	75000	3	37.5

2B: 2-ball bearing L: sintetico bearing S: sleeve bearing

Voltage Available

Bearing System Available

Function Available

05 12 24 48

2B L S

N A I F R Q S T M V C P D W U

PERFORMANCE P-Q CURVE

OUTLINE DIMENSIONS

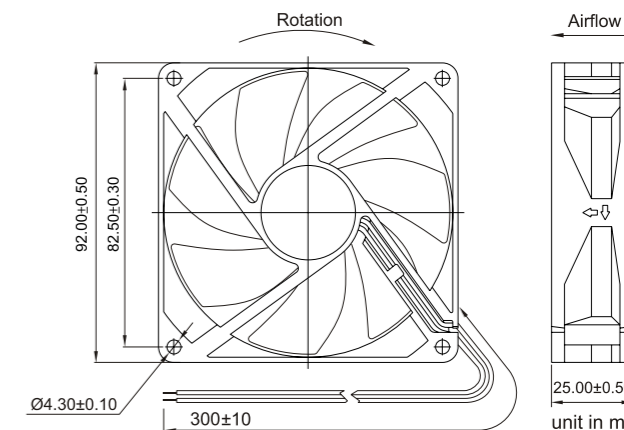
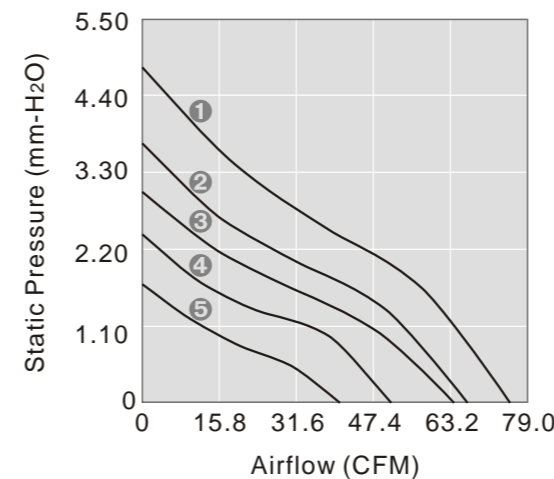

Please refer to Model Numbering System for bearing, function and speed level indication. Specifications are subject to changes without notice. Please refer to the formally issued product specification via contacting Y.S. TECH sales department. Visit Y.S. TECH web site at <http://www.ystech.com.tw> for updated information. Customized Specifications are designed accordingly.



92x92x32mm

- Airflow: 42.6~86.8 CFM
- Static Pressure: 3.5~14.3 mm-H₂O
- Blade / Housing: Plastic Material UL 94V-0 P.B.T.
- Lead Wire: UL1007 #22 AWG
- Weight: 183.0 g



120x120x25mm

- Airflow: 61.2 CFM
- Static Pressure: 2.3 mm-H₂O
- Blade / Housing: Plastic Material UL 94V-0 P.B.T.
- Lead Wire: UL1007 #24 AWG
- Weight: 118 g

Model No.	Bearing	Rated Voltage VDC	Operating Voltage Range VDC	Speed RPM	Max. Airflow CFM	Max. Static Pressure mm-H ₂ O	Current mA	Power Consumption W	Life at 40°C L10 Hour	P-Q Curve	Noise Level dB(A)
FD129232LB	2B	12	7~13.2	2300	42.6	3.5	130	1.56	80000	4	34.0
FD129232MB	2B	12	7~13.2	3200	58.7	6.9	270	3.24	80000	3	42.5
FD129232HB	2B	12	7~13.2	4000	73.3	10.7	490	5.88	75000	2	47.0
FD129232EB	2B	12	7~13.2	4700	86.8	14.3	650	7.80	65000	1	51.0
FD249232LB	2B	24	12~26.4	2300	42.6	3.5	90	2.16	80000	4	34.0
FD249232MB	2B	24	12~26.4	3200	58.7	6.9	170	4.08	80000	3	42.5
FD249232HB	2B	24	12~26.4	4000	73.3	10.7	260	6.24	75000	2	47.0
FD249232EB	2B	24	12~26.4	4700	86.8	14.3	420	10.08	65000	1	51.0
FD489232LB	2B	48	24~56.0	2300	42.6	3.5	70	3.36	80000	4	34.0
FD489232MB	2B	48	24~56.0	3200	58.7	6.9	120	5.76	80000	3	42.0
FD489232HB	2B	48	24~56.0	4000	73.3	10.7	210	10.08	75000	2	47.0
FD489232EB	2B	48	24~56.0	4700	86.8	14.3	280	13.44	75000	1	51.0

Model No.	Bearing	Rated Voltage VDC	Operating Voltage Range VDC	Speed RPM	Max. Airflow CFM	Max. Static Pressure mm-H ₂ O	Current mA	Power Consumption W	Life at 40°C L10 Hour	P-Q Curve	Noise Level dB(A)
KM121225LB	2B	12	7~13.2	2000	61.2	2.3	180	2.16	80000	1	31.5
KM121225LB	2B	12	7~13.2	1200	38.4	1.4	70	0.84	80000	2	17.5
KM121225LL	L	12	7~13.2	1200	38.4	1.4	65	0.78	50000	2	17.5
KM121225LL	L	12	7~13.2	800	25.6	1.0	40	0.48	50000	3	16.5
KM121225LS	S	12	7~13.2	2000	61.2	2.3	180	2.16	30000	1	31.5
KM121225LS	S	12	7~13.2	1200	38.4	1.4	70	0.84	30000	2	17.5
KM121225LS	S	12	7~13.2	800	25.6	1.0	40	0.48	30000	3	16.5

2B: 2-ball bearing L: sintetico bearing S: sleeve bearing

Voltage Available: 05 12 24 48
 Bearing System Available: 2B L S
 Function Available: N A I F R Q S T M V C P D W U

PERFORMANCE P-Q CURVE

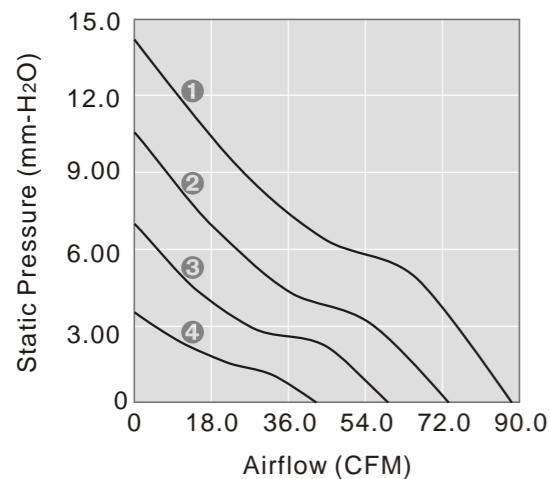

OUTLINE DIMENSIONS

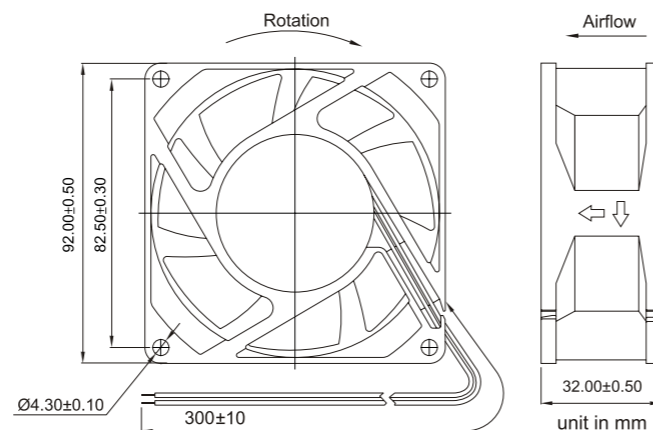

Please refer to Model Numbering System for bearing, function and speed level indication. Specifications are subject to changes without notice. Please refer to the formally issued product specification via contacting Y.S. TECH sales department. Visit Y.S. TECH web site at <http://www.ystech.com.tw> for updated information. Customized Specifications are designed accordingly.

2B: 2-ball bearing L: sintetico bearing S: sleeve bearing

Voltage Available: 05 12 24 48
 Bearing System Available: 2B L S
 Function Available: N A I F R Q S T M V C P D W U

PERFORMANCE P-Q CURVE

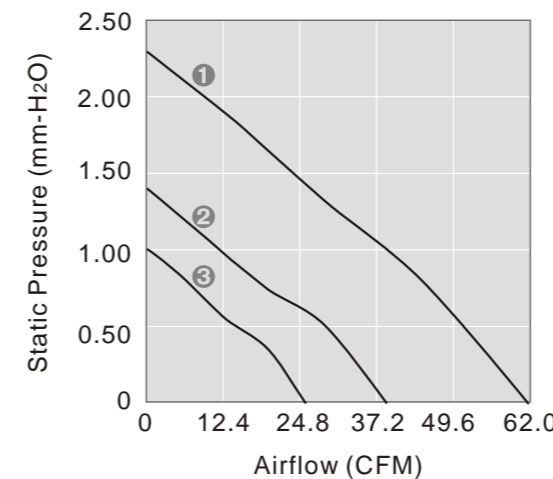

OUTLINE DIMENSIONS

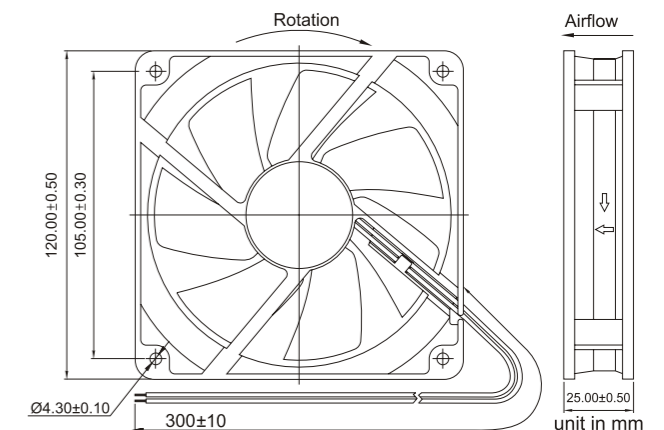

Please refer to Model Numbering System for bearing, function and speed level indication. Specifications are subject to changes without notice. Please refer to the formally issued product specification via contacting Y.S. TECH sales department. Visit Y.S. TECH web site at <http://www.ystech.com.tw> for updated information. Customized Specifications are designed accordingly.



120x120x25mm

- Airflow: 73.0~123.0 CFM
- Static Pressure: 2.6~7.6 mm-H₂O
- Blade / Housing: Plastic Material UL 94V-0 P.B.T.
- Lead Wire: UL1007 #22 AWG
- Weight: 160 g

Model No.	Bearing	Rated Voltage VDC	Operating Voltage Range VDC	Speed RPM	Max. Airflow CFM	Max. Static Pressure mm-H ₂ O	Current mA	Power Consumption W	Life at 40°C L10 Hour	P-Q Curve	Noise Level dB(A)
FD121225LB	2B	12	7~13.2	1800	73.0	2.6	180	2.16	80000	4	34.0
FD121225MB	2B	12	7~13.2	2200	87.8	3.9	290	3.48	80000	3	40.5
FD121225HB	2B	12	7~13.2	2600	106.1	5.8	460	5.52	75000	2	44.0
FD121225EB	2B	12	7~13.2	3000	123.1	7.6	570	6.84	65000	1	49.0
FD241225LB	2B	24	12~26.4	1800	73.0	2.6	100	2.40	80000	4	34.0
FD241225MB	2B	24	12~26.4	2200	87.8	3.9	160	3.84	80000	3	40.5
FD241225HB	2B	24	12~26.4	2600	106.1	5.8	280	6.72	75000	2	44.0
FD241225EB	2B	24	12~26.4	3000	123.1	7.6	360	8.64	65000	1	49.0
FD481225LB	2B	48	24~56.0	1800	73.0	2.6	70	3.36	80000	4	34.0
FD481225MB	2B	48	24~56.0	2200	87.8	3.9	130	6.24	80000	3	40.5
FD481225HB	2B	48	24~56.0	2600	106.1	5.8	110	5.28	75000	2	44.0
FD481225EB	2B	48	24~56.0	3000	123.1	7.6	190	9.12	65000	1	49.0

2B: 2-ball bearing L: sintetico bearing S: sleeve bearing

Voltage Available
05 12 24 48

Bearing System Available
2B L S

Function Available
N A I F R Q S T M V C P D W U

PERFORMANCE P-Q CURVE

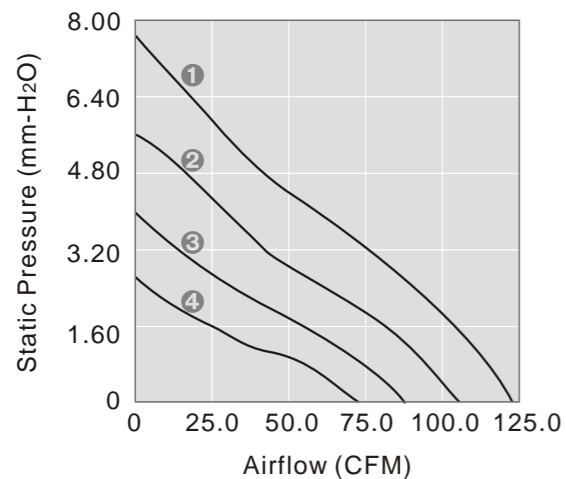

OUTLINE DIMENSIONS

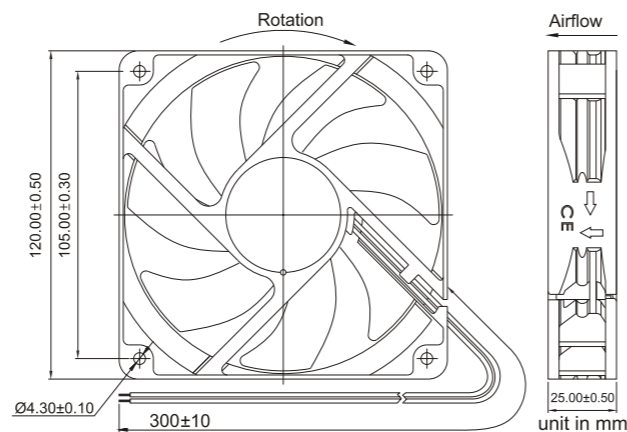

Please refer to Model Numbering System for bearing, function and speed level indication. Specifications are subject to changes without notice. Please refer to the formally issued product specification via contacting Y.S. TECH sales department. Visit Y.S. TECH web site at <http://www.ystech.com.tw> for updated information. Customized Specifications are designed accordingly.



120x120x32mm

- Airflow: 83.3~137.0 CFM
- Static Pressure: 4.3~9.4 mm-H₂O
- Blade / Housing: Plastic Material UL 94V-0 P.B.T.
- Lead Wire: UL1007 #22 AWG
- Weight: 219 g

Model No.	Bearing	Rated Voltage VDC	Operating Voltage Range VDC	Speed RPM	Max. Airflow CFM	Max. Static Pressure mm-H ₂ O	Current mA	Power Consumption W	Life at 40°C L10 Hour	P-Q Curve	Noise Level dB(A)
FD121232LB	2B	12	7~13.2	2100	87.7	4.2	330	3.96	80000	4	39.0
FD121232MB	2B	12	7~13.2	2500	99.3	6.1	450	5.40	80000	3	42.5
FD121232HB	2B	12	7~13.2	2900	115.0	8.0	580	6.96	75000	2	47.5
FD121232EB	2B	12	7~13.2	3300	137.3	9.4	840	10.08	65000	1	49.0
FD241232LB	2B	24	12~26.4	2100	87.7	4.2	150	3.60	80000	4	39.0
FD241232MB	2B	24	12~26.4	2500	99.3	6.1	200	4.80	80000	3	42.5
FD241232HB	2B	24	12~26.4	2900	115.0	8.0	290	6.96	75000	2	47.5
FD241232EB	2B	24	12~26.4	3300	137.3	9.4	400	9.60	65000	1	49.0
FD481232LB	2B	48	24~56.0	2100	83.3	4.3	90	4.32	80000	4	39.5
FD481232MB	2B	48	24~56.0	2500	99.3	6.1	130	6.24	80000	3	42.5
FD481232HB	2B	48	24~56.0	2900	115.0	8.0	190	9.12	75000	2	47.0

2B: 2-ball bearing L: sintetico bearing S: sleeve bearing

Voltage Available
05 12 24 48

Bearing System Available
2B L S

Function Available
N A I F R Q S T M V C P D W U

PERFORMANCE P-Q CURVE

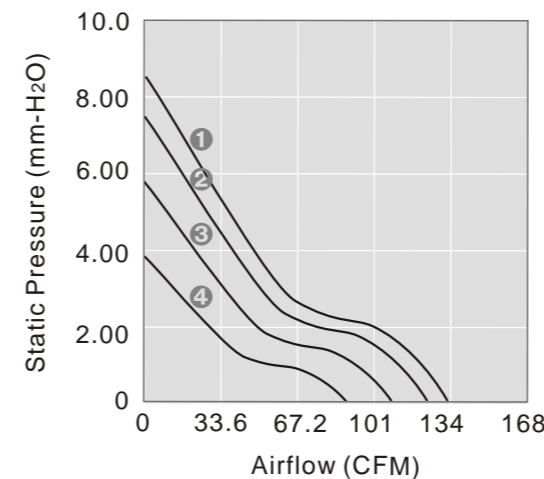

OUTLINE DIMENSIONS

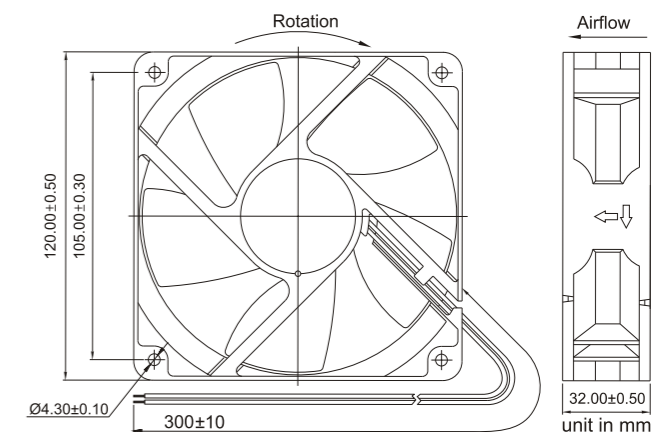

Please refer to Model Numbering System for bearing, function and speed level indication. Specifications are subject to changes without notice. Please refer to the formally issued product specification via contacting Y.S. TECH sales department. Visit Y.S. TECH web site at <http://www.ystech.com.tw> for updated information. Customized Specifications are designed accordingly.



120x120x38mm

- Airflow: 89.5~135.0 CFM
- Static Pressure: 3.9~8.6 mm-H₂O
- Blade / Housing: Plastic Material UL 94V-0 P.B.T.
- Lead Wire: UL1007 #22 AWG
- Weight: 220 g

Model No.	Bearing	Rated Voltage VDC	Operating Voltage Range VDC	Speed RPM	Max. Airflow CFM	Max. Static Pressure mm-H ₂ O	Current mA	Power Consumption W	Life at 40°C L10 Hour	P-Q Curve	Noise Level dB(A)
FD121238LB	2B	12	7~13.2	2000	89.5	3.9	320	3.84	80000	4	36.0
FD121238MB	2B	12	7~13.2	2400	107.0	5.8	400	4.80	80000	3	41.0
FD121238HB	2B	12	7~13.2	2800	125.5	7.6	660	7.92	75000	2	45.0
FD121238EB	2B	12	7~13.2	3000	135.0	8.6	830	9.96	65000	1	47.0
FD241238LB	2B	24	12~26.4	2000	89.5	3.9	150	3.60	80000	4	36.0
FD241238MB	2B	24	12~26.4	2400	107.0	5.8	250	6.00	80000	3	41.0
FD241238HB	2B	24	12~26.4	2800	125.5	7.6	310	7.44	75000	2	45.0
FD241238EB	2B	24	12~26.4	3000	135.0	8.6	410	9.84	65000	1	47.0
FD481238LB	2B	48	24~56.0	2000	89.5	3.9	120	5.76	80000	4	36.0
FD481238MB	2B	48	24~56.0	2400	107.0	5.8	140	6.72	80000	3	41.0
FD481238HB	2B	48	24~56.0	2800	125.5	7.6	180	8.64	75000	2	45.0
FD481238EB	2B	48	24~56.0	3000	135.0	8.6	210	10.08	65000	1	47.0

2B: 2-ball bearing L: sintetico bearing S: sleeve bearing

Voltage Available: 05 12 24 48 Bearing System Available: 2B L S Function Available: N A I F R Q S T M V C P D W U

PERFORMANCE P-Q CURVE

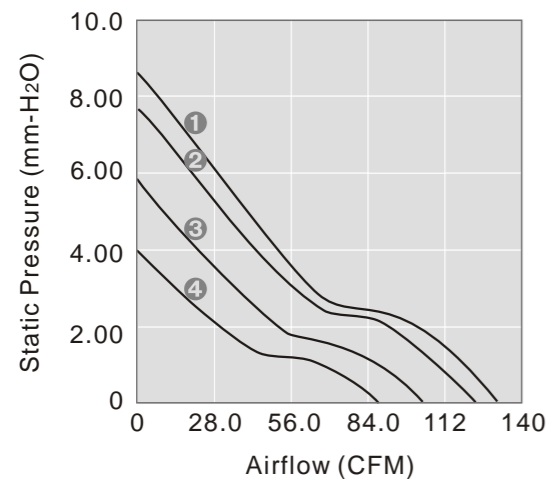

OUTLINE DIMENSIONS

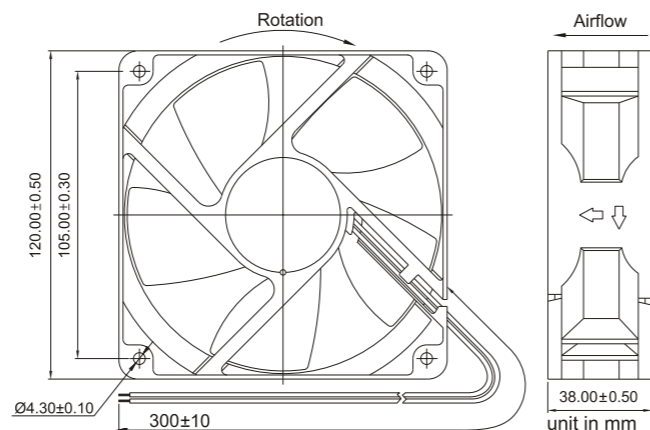

Please refer to Model Numbering System for bearing, function and speed level indication. Specifications are subject to changes without notice. Please refer to the formally issued product specification via contacting Y.S. TECH sales department. Visit Y.S. TECH web site at <http://www.ystech.com.tw> for updated information. Customized Specifications are designed accordingly.



120x120x38mm

- Airflow: 115.5~135.0 CFM
- Static Pressure: 9.15~13.2 mm-H₂O
- Blade / Housing: Plastic Material UL 94V-0 P.B.T.
- Lead Wire: UL1007 #22 AWG
- Weight: 220 g

Model No.	Bearing	Rated Voltage VDC	Operating Voltage Range VDC	Speed RPM	Max. Airflow CFM	Max. Static Pressure mm-H ₂ O	Current mA	Power Consumption W	Life at 40°C L10 Hour	P-Q Curve	Noise Level dB(A)
FD121238MB-N	2B	12	7~13.2	3500	115.0	9.1	560	6.72	80000	3	48.0
FD121238HB-N	2B	12	7~13.2	3800	125.8	9.8	680	8.16	75000	2	49.5
FD121238EB-N	2B	12	7~13.2	3900	129.8	11.0	850	10.2	65000	1	52.0
FD241238MB-N	2B	24	12~26.4	3500	115.0	9.1	380	9.12	80000	3	48.0
FD241238HB-N	2B	24	12~26.4	3800	125.8	9.8	420	10.08	75000	2	49.5
FD241238EB-N	2B	24	12~26.4	4100	135.0	13.2	470	11.28	65000	1	53.0
FD481238MB-N	2B	48	24~56.0	3500	115.0	9.1	130	6.24	80000	3	48.0
FD481238HB-N	2B	48	24~56.0	3800	125.8	9.8	160	7.68	75000	2	49.5
FD481238EB-N	2B	48	24~56.0	4100	135.0	13.2	230	11.04	65000	1	53.0

2B: 2-ball bearing L: sintetico bearing S: sleeve bearing

Voltage Available: 05 12 24 48 Bearing System Available: 2B L S Function Available: N A I F R Q S T M V C P D W U

PERFORMANCE P-Q CURVE

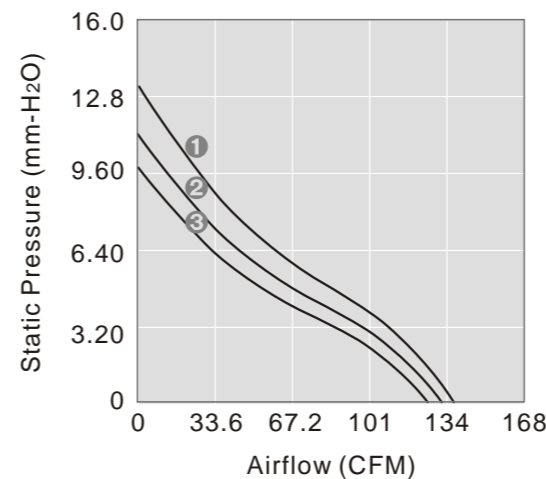

OUTLINE DIMENSIONS

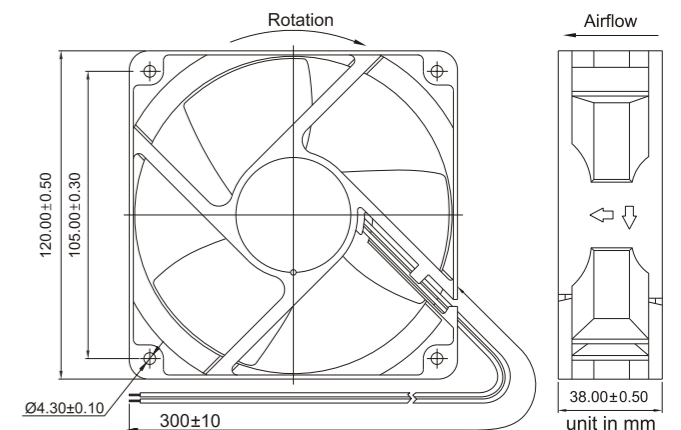

Please refer to Model Numbering System for bearing, function and speed level indication. Specifications are subject to changes without notice. Please refer to the formally issued product specification via contacting Y.S. TECH sales department. Visit Y.S. TECH web site at <http://www.ystech.com.tw> for updated information. Customized Specifications are designed accordingly.



50x50x10mm

- Airflow: 2.4~3.3 CFM
- Static Pressure: 6.1~11.5 mm-H₂O
- Blade / Housing: Plastic Material UL 94V-0 P.B.T.
- Lead Wire: UL1571 #28 AWG
- Weight: 17.5 g



50x50x15mm

- Airflow: 4.2~6.7 CFM
- Static Pressure: 16.3~32.8 mm-H₂O
- Blade / Housing: Plastic Material UL 94V-0 P.B.T.
- Lead Wire: UL1007 #26 AWG
- Weight: 28 g

Model No.	Bearing	Rated Voltage	Operating Voltage Range	Speed	Max. Airflow	Max. Static Pressure	Current	Power Consumption	Life at 40°C L10	P-Q Curve	Noise Level
	VDC	VDC	RPM	CFM	mm-H ₂ O	mA	W	Hour			
BD055010MB	2B	05	4~5.5	5000	2.4	6.1	120	0.60	80000	2	27.0
BD055010HB	2B		4~5.5	6500	3.3	11.5	170	0.85	75000	1	32.0
BD125010MB	2B	12	7~13.2	5000	2.4	6.1	55	0.66	80000	2	27.0
BD125010HB	2B		7~13.2	6500	3.3	11.5	100	1.20	75000	1	32.0

Model No.	Bearing	Rated Voltage	Operating Voltage Range	Speed	Max. Airflow	Max. Static Pressure	Current	Power Consumption	Life at 40°C L10	P-Q Curve	Noise Level
	VDC	VDC	RPM	CFM	mm-H ₂ O	mA	W	Hour			
BD055115LB	2B	05	4~5.5	4500	4.2	16.3	170	0.85	80000	4	33.5
BD055115MB	2B		4~5.5	5500	5.1	19.9	350	1.75	80000	3	38.0
BD125115LB	2B	12	7~13.2	4500	4.2	16.3	95	1.14	80000	4	33.5
BD125115MB	2B		7~13.2	5500	5.1	19.9	160	1.92	80000	3	38.0
BD125115HB	2B	24	7~13.2	6500	5.7	21.2	230	2.76	75000	2	41.5
BD125115EB	2B		7~13.2	7500	6.7	32.8	290	3.48	65000	1	47.5
BD245115LB	2B	24	12~26.4	4500	4.2	16.3	60	1.44	80000	4	33.5
BD245115MB	2B		12~26.4	5500	5.1	19.9	85	2.04	80000	3	38.0
BD245115HB	2B	24	12~26.4	6500	5.7	21.2	120	2.88	75000	2	41.5
BD245115EB	2B		12~26.4	7500	6.7	32.8	180	4.32	65000	1	47.5

2B: 2-ball bearing L: sintetico bearing S: sleeve bearing

2B: 2-ball bearing L: sintetico bearing S: sleeve bearing

Voltage Available
05 12 24 48

Bearing System Available
2B L S

Function Available
N A I F R Q S T M V C P D W U

Voltage Available
05 12 24 48

Bearing System Available
2B L S

Function Available
N A I F R Q S T M V C P D W U

PERFORMANCE P-Q CURVE

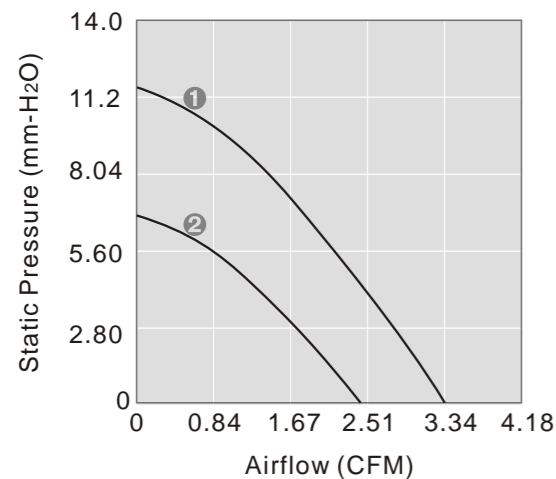

OUTLINE DIMENSIONS

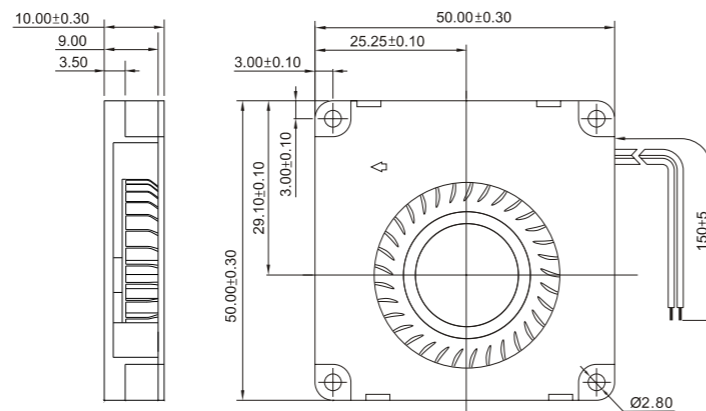

PERFORMANCE P-Q CURVE

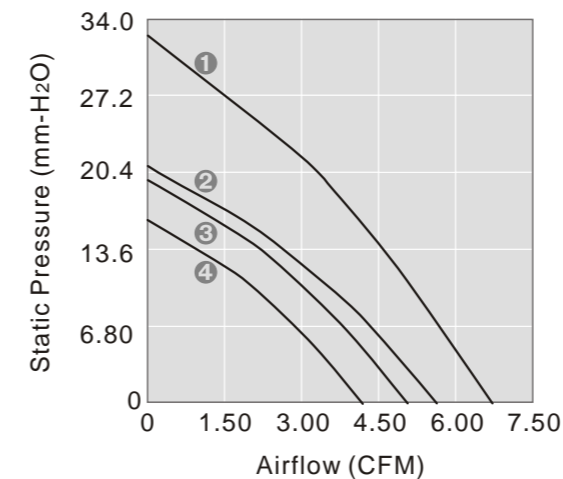

OUTLINE DIMENSIONS

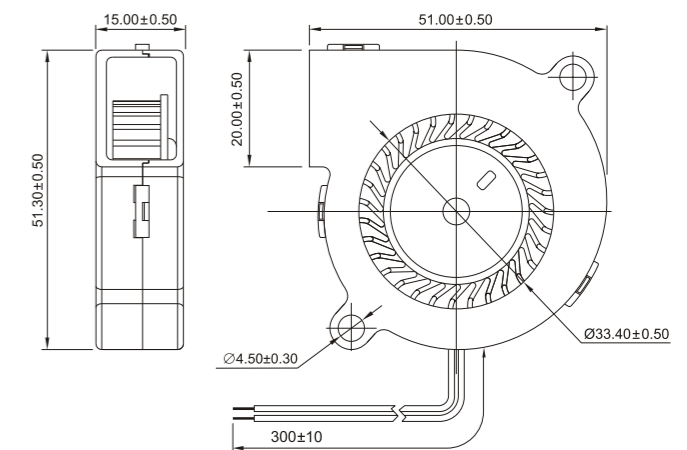

Please refer to Model Numbering System for bearing, function and speed level indication. Specifications are subject to changes without notice. Please refer to the formally issued product specification via contacting Y.S. TECH sales department. Visit Y.S. TECH web site at <http://www.ystech.com.tw> for updated information. Customized Specifications are designed accordingly.

Please refer to Model Numbering System for bearing, function and speed level indication. Specifications are subject to changes without notice. Please refer to the formally issued product specification via contacting Y.S. TECH sales department. Visit Y.S. TECH web site at <http://www.ystech.com.tw> for updated information. Customized Specifications are designed accordingly.



60x60x18mm

- Airflow: 6.7~8.2 CFM
- Static Pressure: 17.6~22.0 mm-H₂O
- Blade / Housing: Plastic Material UL 94V-0 P.B.T.
- Lead Wire: UL1007 #26 AWG
- Weight: 41 g



75x75x30mm

- Airflow: 9.7~16.5 CFM
- Static Pressure: 5.5~20.3 mm-H₂O
- Blade / Housing: Plastic Material UL 94V-0 P.B.T.
- Lead Wire: UL1007 #26 AWG
- Weight: 88.9 g

Model No.	Bearing	Rated Voltage	Operating Voltage Range	Speed	Max. Airflow	Max. Static Pressure	Current	Power Consumption	Life at 40°C L10	P-Q Curve	Noise Level
	VDC	VDC	RPM	CFM	mm-H ₂ O	mA	W	Hour			
BD126018LB	2B	12	7~13.2	4200	6.7	17.6	140	1.68	80000	3	38.0
BD126018MB	2B		7~13.2	4800	7.7	21.2	180	2.16	80000	2	43.5
BD126018HB	2B		7~13.2	5400	8.2	22.0	280	3.36	75000	1	49.0

Model No.	Bearing	Rated Voltage	Operating Voltage Range	Speed	Max. Airflow	Max. Static Pressure	Current	Power Consumption	Life at 40°C L10	P-Q Curve	Noise Level
	VDC	VDC	RPM	CFM	mm-H ₂ O	mA	W	Hour			
BD127530LB	2B	12	7~13.2	2400	9.7	5.5	110	1.32	80000	4	37.0
BD127530MB	2B		7~13.2	3000	12.2	10.3	190	2.28	80000	3	42.0
BD127530HB	2B		7~13.2	3400	14.0	13.7	270	3.24	75000	2	44.5
BD247530LB	2B	24	12~26.4	2400	9.7	5.5	60	1.44	80000	4	37.0
BD247530MB	2B		12~26.4	3000	12.2	10.3	110	2.64	80000	3	42.0
BD247530HB	2B		12~26.4	3400	14.0	13.7	150	3.60	75000	2	44.5
BD247530EB	2B		12~26.4	4000	16.5	20.3	200	4.80	65000	1	48.0

2B: 2-ball bearing L: sintetico bearing S: sleeve bearing

2B: 2-ball bearing L: sintetico bearing S: sleeve bearing

Voltage Available
05 12 24 48

Bearing System Available
2B L S

Function Available
N A I F R Q S T M V C P D W U

Voltage Available
05 12 24 48

Bearing System Available
2B L S

Function Available
N A I F R Q S T M V C P D W U

PERFORMANCE P-Q CURVE

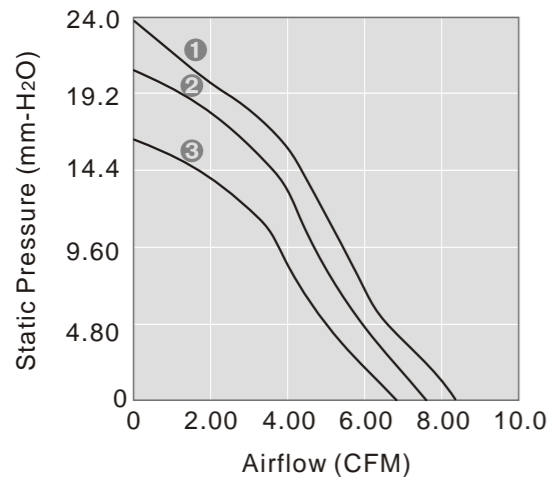

OUTLINE DIMENSIONS

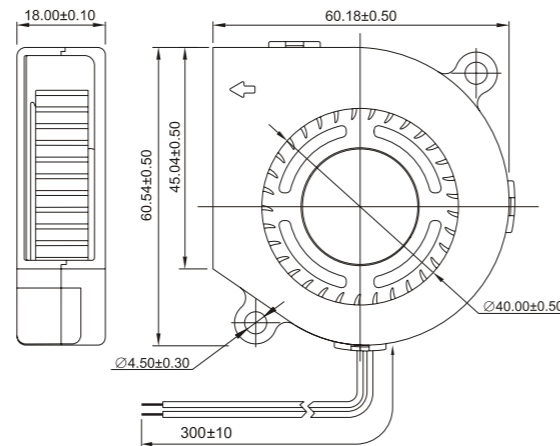

PERFORMANCE P-Q CURVE

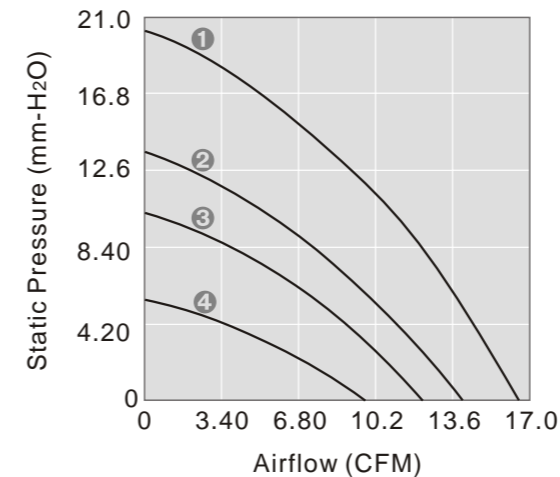

OUTLINE DIMENSIONS

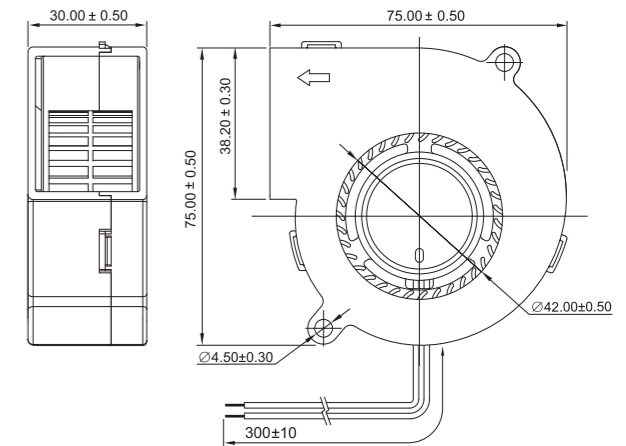

Please refer to Model Numbering System for bearing, function and speed level indication. Specifications are subject to changes without notice. Please refer to the formally issued product specification via contacting Y.S. TECH sales department. Visit Y.S. TECH web site at <http://www.ystech.com.tw> for updated information. Customized Specifications are designed accordingly.

Please refer to Model Numbering System for bearing, function and speed level indication. Specifications are subject to changes without notice. Please refer to the formally issued product specification via contacting Y.S. TECH sales department. Visit Y.S. TECH web site at <http://www.ystech.com.tw> for updated information. Customized Specifications are designed accordingly.



97x97x33mm

- Airflow: 25.6~32.4 CFM
- Static Pressure: 22.1~28.1 mm-H₂O
- Blade / Housing: Plastic Material UL 94V-0 P.B.T.
- Lead Wire: UL1007 #24 AWG
- Weight: 156.7 g



120x120x32mm

- Airflow: 24.5~48.9 CFM
- Static Pressure: 8.7~54.5 mm-H₂O
- Blade / Housing: Plastic Material UL 94V-0 P.B.T.
- Lead Wire: UL1007 #22 AWG
- Weight: 258.5 g

Model No.	Bearing	Rated Voltage	Operating Voltage Range	Speed	Max. Airflow	Max. Static Pressure	Current	Power Consumption	Life at 40°C L10	P-Q Curve	Noise Level
		VDC	VDC	RPM	CFM	mm-H ₂ O	mA	W	Hour		dB(A)
BD129733LB	2B		7~13.2	2600	25.6	22.1	400	4.80	80000	3	40.0
BD129733MB	2B	12	7~13.2	2900	28.5	24.7	480	5.76	80000	2	42.5
BD129733HB	2B		7~13.2	3300	32.4	28.1	740	8.88	75000	1	48.5
BD249733LB	2B		12~26.4	2600	25.6	22.1	210	5.04	80000	3	40.0
BD249733MB	2B	24	12~26.4	2900	28.5	24.7	280	6.72	80000	2	42.5
BD249733HB	2B		12~26.4	3300	32.4	28.1	420	10.08	75000	1	48.5

Model No.	Bearing	Rated Voltage	Operating Voltage Range	Speed	Max. Airflow	Max. Static Pressure	Current	Power Consumption	Life at 40°C L10	P-Q Curve	Noise Level
		VDC	VDC	RPM	CFM	mm-H ₂ O	mA	W	Hour		dB(A)
BD121232LB	2B		7~13.2	1800	24.5	8.7	230	2.76	80000	5	46.0
BD121232MB	2B		7~13.2	2100	28.9	21.1	350	4.20	80000	4	53.2
BD121232HB	2B	12	7~13.2	2600	36.0	28.0	730	8.76	75000	3	56.6
BD121232EB	2B		7~13.2	2900	38.2	31.5	1100	13.2	65000	2	60.2
BD121232UB	2B		7~13.2	3500	48.9	54.5	1750	21.0	65000	1	64.8

2B: 2-ball bearing L: sintetico bearing S: sleeve bearing

2B: 2-ball bearing L: sintetico bearing S: sleeve bearing

Voltage Available
05 12 24 48

Bearing System Available
2B L S

Function Available
N A I F R Q S T M V C P D W U

Voltage Available
05 12 24 48

Bearing System Available
2B L S

Function Available
N A I F R Q S T M V C P D W U

PERFORMANCE P-Q CURVE

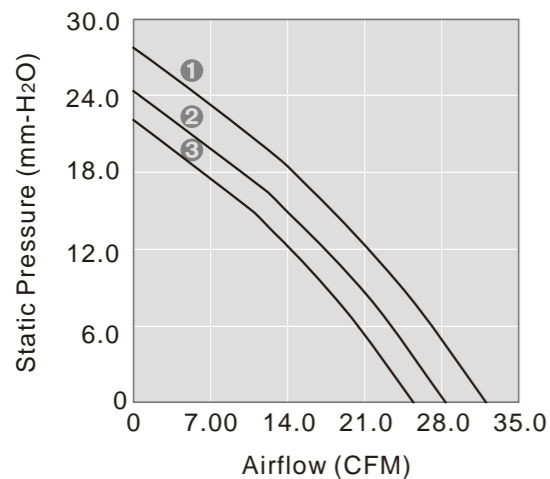

OUTLINE DIMENSIONS

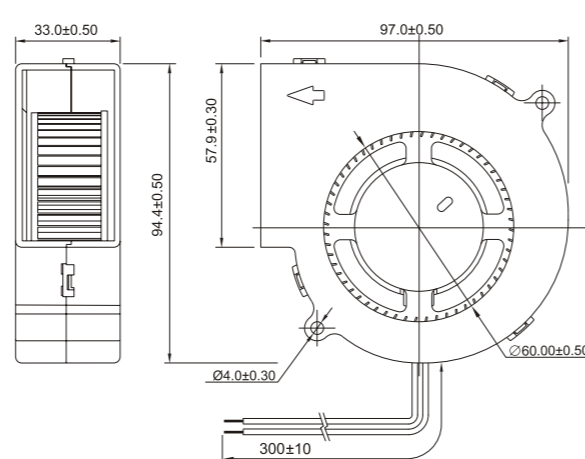

PERFORMANCE P-Q CURVE

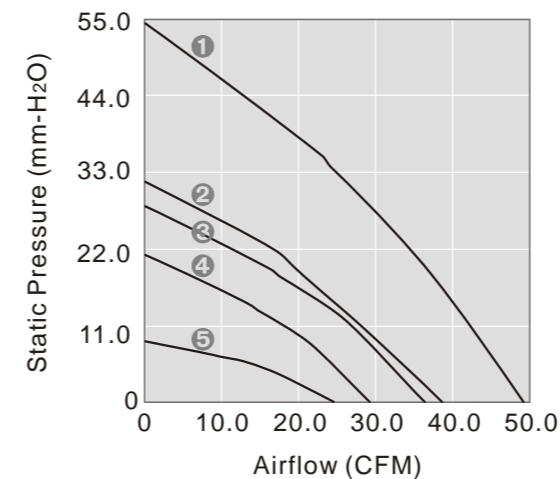

OUTLINE DIMENSIONS

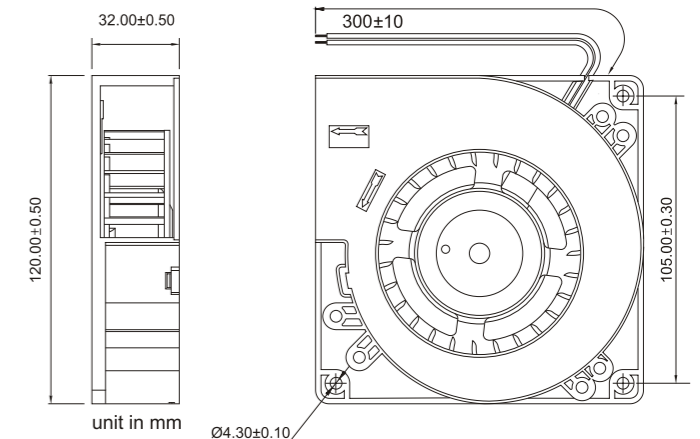

Please refer to Model Numbering System for bearing, function and speed level indication. Specifications are subject to changes without notice. Please refer to the formally issued product specification via contacting Y.S. TECH sales department. Visit Y.S. TECH web site at <http://www.ystech.com.tw> for updated information. Customized Specifications are designed accordingly.

Please refer to Model Numbering System for bearing, function and speed level indication. Specifications are subject to changes without notice. Please refer to the formally issued product specification via contacting Y.S. TECH sales department. Visit Y.S. TECH web site at <http://www.ystech.com.tw> for updated information. Customized Specifications are designed accordingly.



40x40x28mm

- Airflow: 10.3~25.9 CFM
- Static Pressure: 7.9~39.0 mm-H₂O
- Blade / Housing: Plastic Material UL 94V-0 P.B.T.
- Lead Wire: UL1007 #26 AWG
- Weight: 45.1 g



40x40x56mm

- Airflow: 25.5 CFM
- Static Pressure: 40.3 mm-H₂O
- Blade / Housing: Plastic Material UL 94V-0 P.B.T.
- Lead Wire: UL1007 #26 AWG
- Weight: 90.2 g

Model No.	Bearing	Rated Voltage VDC	Operating Voltage Range VDC	Speed RPM	Max. Airflow CFM	Max. Static Pressure mm-H ₂ O	Current mA	Power Consumption W	Life at 40°C L10 Hour	P-Q Curve	Noise Level dB(A)
FD054028HB -P	2B	05	4~5.5	8000	14.4	14.6	480	2.04	75000	5	37.5
FD124028LB -P	2B	12	7~13.2	5000	10.3	7.9	90	1.08	80000	7	24.5
FD124028MB-P	2B		7~13.2	7000	13.0	12.0	150	1.80	80000	6	34.5
FD124028HB -P	2B	12	7~13.2	8000	14.4	14.6	180	2.16	75000	5	37.5
FD124028EB -P	2B	12	7~13.2	9500	16.5	18.9	260	3.12	65000	4	41.0
FD124028EB -P	2B	12	7~13.2	11000	19.0	26.2	460	5.52	65000	3	47.0
FD124028EB -P	2B	12	7~13.2	13000	21.4	31.9	550	6.60	65000	2	49.5
FD124028EB -P	2B	12	7~13.2	16000	25.9	39.0	750	9.00	65000	1	51.5
FD244028LB -P	2B	24	12~26.4	5000	10.3	7.9	80	1.92	80000	7	24.5
FD244028MB-P	2B		12~26.4	7000	13.0	12.0	90	2.04	80000	6	34.5
FD244028HB -P	2B	24	12~26.4	8000	14.4	14.6	160	3.84	75000	5	37.5
FD244028EB -P	2B	24	12~26.4	9500	16.5	18.9	200	4.80	65000	4	41.0
FD244028EB -P	2B	24	12~26.4	11000	19.0	26.2	280	6.72	65000	3	47.0
FD244028EB -P	2B	24	12~26.4	13000	21.4	31.9	430	10.32	65000	2	49.5

Model No.	Bearing	Rated Voltage VDC	Operating Voltage Range VDC	Speed RPM	Max. Airflow CFM	Max. Static Pressure mm-H ₂ O	Current mA	Power Consumption W	Life at 40°C L10 Hour	P-Q Curve	Noise Level dB(A)
FD124056EB -P	2B	12	7~13.2	14000	25.5	40.3	1180	14.16	65000	1	60.5
FD244056EB -P	2B	24	12~26.4	14000	25.5	40.3	590	14.16	65000	1	60.5

2B: 2-ball bearing L: sintetico bearing S: sleeve bearing

Voltage Available
05 12 24 48

Bearing System Available
2B L S

Function Available
N A I F R Q S T M V C P D W U

PERFORMANCE P-Q CURVE

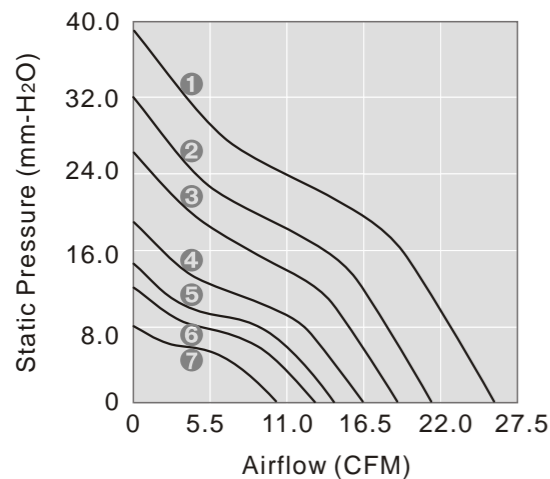

OUTLINE DIMENSIONS

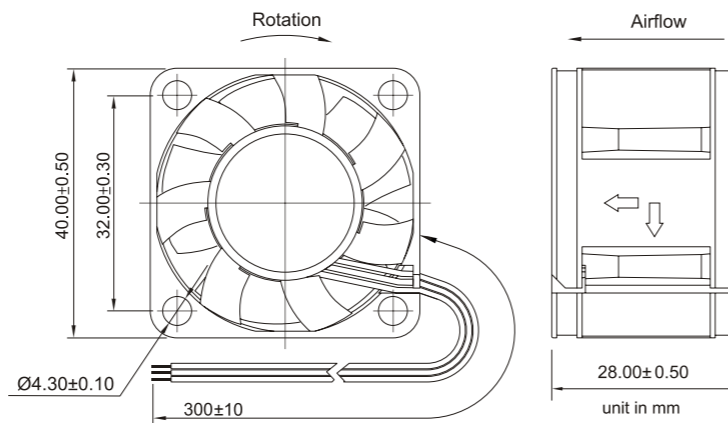

Please refer to Model Numbering System for bearing, function and speed level indication. Specifications are subject to changes without notice. Please refer to the formally issued product specification via contacting Y.S. TECH sales department. Visit Y.S. TECH web site at <http://www.ystech.com.tw> for updated information. Customized Specifications are designed accordingly.

2B: 2-ball bearing L: sintetico bearing S: sleeve bearing

Voltage Available
05 12 24 48

Bearing System Available
2B L S

Function Available
N A I F R Q S T M V C P D W U

PERFORMANCE P-Q CURVE

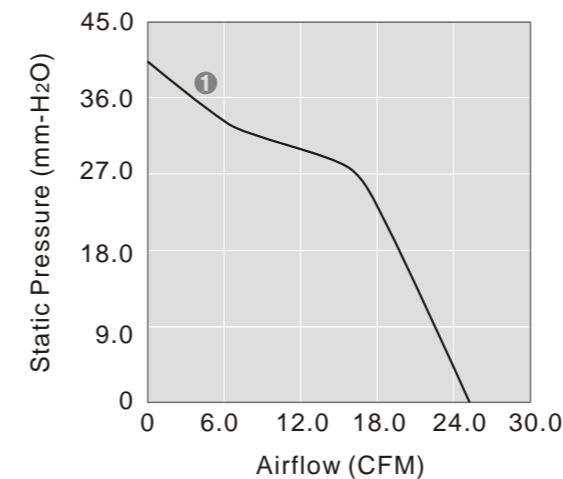

OUTLINE DIMENSIONS

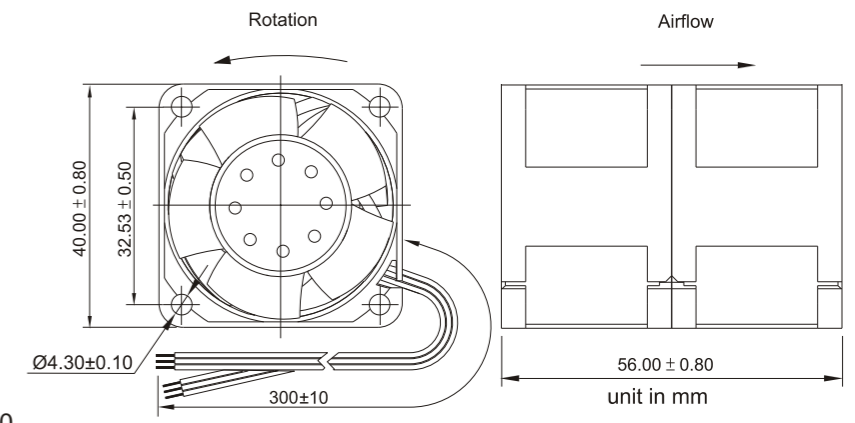

Please refer to Model Numbering System for bearing, function and speed level indication. Specifications are subject to changes without notice. Please refer to the formally issued product specification via contacting Y.S. TECH sales department. Visit Y.S. TECH web site at <http://www.ystech.com.tw> for updated information. Customized Specifications are designed accordingly.



60x60x38mm

- Airflow: 26.7~45.5 CFM
- Static Pressure: 8.1~22.9 mm-H₂O
- Blade / Housing: Plastic Material UL 94V-0 P.B.T.
- Lead Wire: UL1007 #24 AWG
- Weight: 115.6 g



80x80x32mm

- Airflow: 48.6~80.5 CFM
- Static Pressure: 13.5~22.3 mm-H₂O
- Blade / Housing: Plastic Material UL 94V-0 P.B.T.
- Lead Wire: UL1007 #24 AWG
- Weight: 148.2 g

Model No.	Bearing	Rated Voltage VDC	Operating Voltage Range VDC	Speed RPM	Max. Airflow CFM	Max. Static Pressure mm-H ₂ O	Current mA	Power Consumption W	Life at 40°C L10 Hour	P-Q Curve	Noise Level dB(A)
FD126038LB-P	2B	12	7~13.2	4500	26.7	8.1	190	2.28	80000	4	41.0
FD126038MB-P	2B	12	7~13.2	5500	32.6	12.2	260	3.12	80000	3	47.0
FD126038HB-P	2B	12	7~13.2	6500	38.5	16.5	450	5.40	75000	2	51.0
FD126038EB-P	2B	12	7~13.2	7500	45.5	22.9	720	8.64	65000	1	55.0
FD246038LB-P	2B	24	12~26.4	4500	26.7	8.1	110	2.64	80000	4	41.0
FD246038MB-P	2B	24	12~26.4	5500	32.6	12.2	170	4.08	80000	3	47.0
FD246038HB-P	2B	24	12~26.4	6500	38.5	16.5	250	6.00	75000	2	51.0
FD246038EB-P	2B	24	12~26.4	7500	45.5	22.9	360	8.64	65000	1	55.0
FD486038LB-P	2B	48	24~56.0	4500	26.7	8.1	70	3.36	80000	4	41.0
FD486038MB-P	2B	48	24~56.0	5500	32.6	12.2	90	4.32	80000	3	47.0
FD486038HB-P	2B	48	24~56.0	6500	38.5	16.5	130	6.24	75000	2	51.0
FD486038EB-P	2B	48	24~56.0	7500	45.5	22.9	190	9.12	65000	1	55.0

Model No.	Bearing	Rated Voltage VDC	Operating Voltage Range VDC	Speed RPM	Max. Airflow CFM	Max. Static Pressure mm-H ₂ O	Current mA	Power Consumption W	Life at 40°C L10 Hour	P-Q Curve	Noise Level dB(A)
FD128032LB-P	2B	12	7~13.2	3500	48.6	13.5	240	2.88	80000	4	45.0
FD128032MB-P	2B	12	7~13.2	4200	58.3	16.2	350	4.20	80000	3	49.0
FD128032HB-P	2B	12	7~13.2	5000	69.4	19.2	650	7.80	75000	2	53.0
FD128032EB-P	2B	12	7~13.2	5800	80.5	22.3	830	9.96	65000	1	56.0
FD248032LB-P	2B	24	12~26.4	3500	48.6	13.5	150	3.60	80000	4	45.0
FD248032MB-P	2B	24	12~26.4	4200	58.3	16.2	220	5.28	80000	3	49.0
FD248032HB-P	2B	24	12~26.4	5000	69.4	19.2	330	7.92	75000	2	53.0
FD248032EB-P	2B	24	12~26.4	5800	80.5	22.3	450	10.80	65000	1	56.0

2B: 2-ball bearing L: sintetico bearing S: sleeve bearing

2B: 2-ball bearing L: sintetico bearing S: sleeve bearing

Voltage Available: 05 12 24 48
 Bearing System Available: 2B L S
 Function Available: N A I F R Q S T M V C P D W U

Voltage Available: 05 12 24 48
 Bearing System Available: 2B L S
 Function Available: N A I F R Q S T M V C P D W U

PERFORMANCE P-Q CURVE

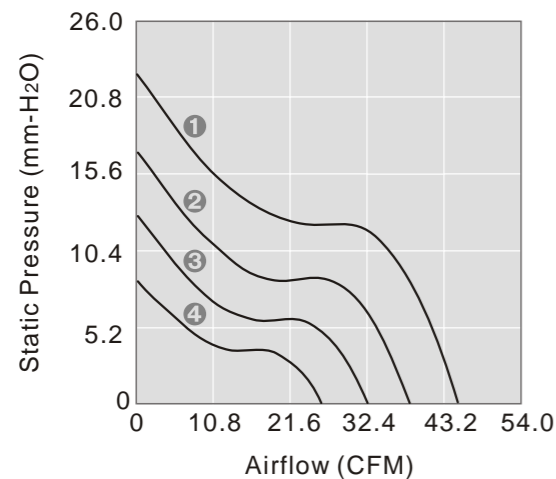

OUTLINE DIMENSIONS

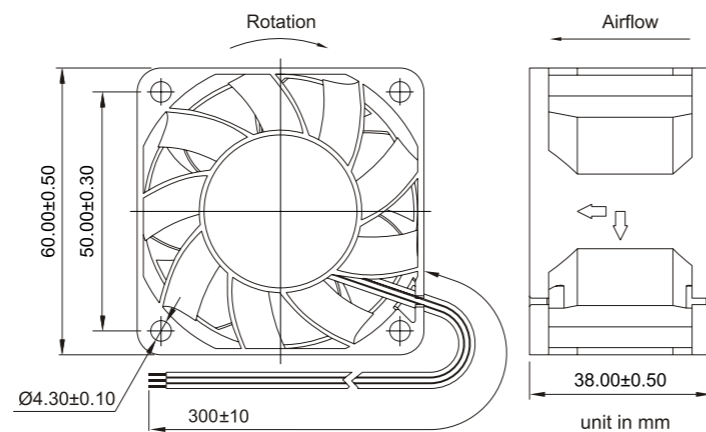

PERFORMANCE P-Q CURVE

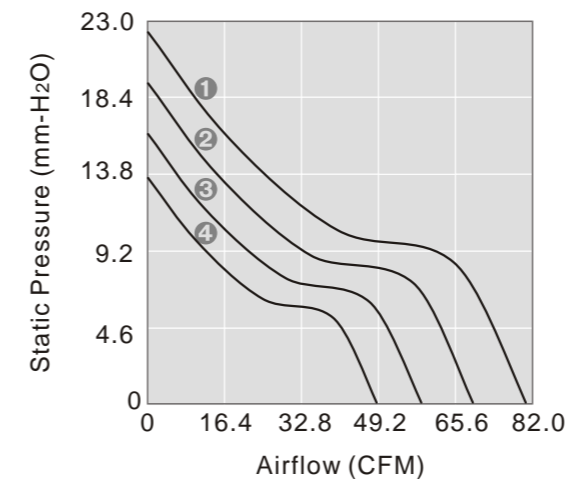

OUTLINE DIMENSIONS

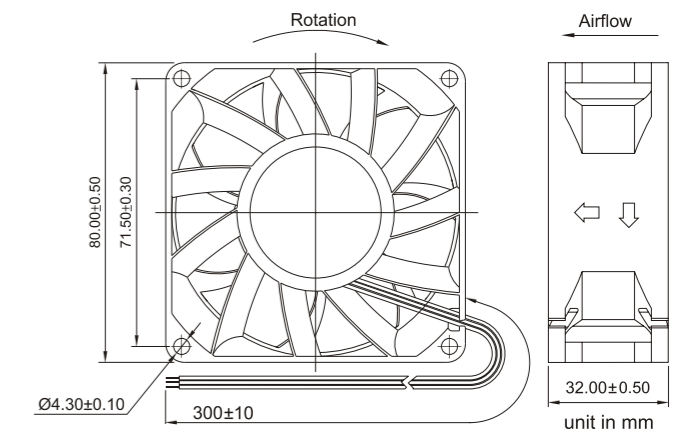

Please refer to Model Numbering System for bearing, function and speed level indication. Specifications are subject to changes without notice. Please refer to the formally issued product specification via contacting Y.S. TECH sales department. Visit Y.S. TECH web site at <http://www.ystech.com.tw> for updated information. Customized Specifications are designed accordingly.

Please refer to Model Numbering System for bearing, function and speed level indication. Specifications are subject to changes without notice. Please refer to the formally issued product specification via contacting Y.S. TECH sales department. Visit Y.S. TECH web site at <http://www.ystech.com.tw> for updated information. Customized Specifications are designed accordingly.



80x80x38mm

- Airflow: 47.6~81.2 CFM
- Static Pressure: 7.5~20.5 mm-H₂O
- Blade / Housing: Plastic Material UL 94V-0 P.B.T.
- Lead Wire: UL1007 #24 AWG
- Weight: 172.6 g



92x92x38mm

- Airflow: 80.5~117.3 CFM
- Static Pressure: 7.8~15.5 mm-H₂O
- Blade / Housing: Plastic Material UL 94V-0 P.B.T.
- Lead Wire: UL1007 #24 AWG
- Weight: 198.4 g

Model No.	Bearing	Rated Voltage	Operating Voltage Range	Speed	Max. Airflow	Max. Static Pressure	Current	Power Consumption	Life at 40°C L10	P-Q Curve	Noise Level
		VDC	VDC	RPM	CFM	mm-H ₂ O	mA	W	Hour		dB(A)
FD128038LB-P	2B	12	7~13.2	3400	47.6	7.5	240	2.88	80000	5	41.5
FD128038MB-P	2B		7~13.2	4200	58.9	11.2	380	4.56	80000	4	47.0
FD128038HB-P	2B		7~13.2	4900	69.2	15.2	580	6.96	75000	3	51.5
FD128038EB-P	2B		7~13.2	5700	81.2	20.5	800	9.60	65000	2	55.0
FD128038UB-P	2B	24	7~13.2	8000	116.0	37.2	2000	24.0	65000	1	62.5
FD248038LB-P	2B		12~26.4	3400	47.6	7.5	130	3.12	80000	5	41.5
FD248038MB-P	2B		12~26.4	4200	58.9	11.2	200	4.80	80000	4	47.0
FD248038HB-P	2B		12~26.4	4900	69.2	15.2	280	6.72	75000	3	51.5
FD248038EB-P	2B	48	12~26.4	5700	81.2	20.5	420	10.08	65000	2	55.0
FD488038LB-P	2B		24~56.0	3400	47.6	7.5	80	3.84	80000	5	41.5
FD488038MB-P	2B		24~56.0	4200	58.9	11.2	110	5.28	80000	4	47.0
FD488038HB-P	2B		24~56.0	4900	69.2	15.2	150	7.20	75000	3	51.5
FD488038EB-P	2B	24~56.0	5700	81.2	20.5	200	9.60	65000	2	55.0	

Model No.	Bearing	Rated Voltage	Operating Voltage Range	Speed	Max. Airflow	Max. Static Pressure	Current	Power Consumption	Life at 40°C L10	P-Q Curve	Noise Level
		VDC	VDC	RPM	CFM	mm-H ₂ O	mA	W	Hour		dB(A)
FD129238LB-P	2B	12	7~13.2	3300	80.5	7.8	450	5.40	80000	4	48.0
FD129238MB-P	2B		7~13.2	3800	92.6	10.9	640	7.68	80000	3	51.0
FD129238HB-P	2B		7~13.2	4300	102.9	11.9	950	11.40	75000	2	55.0
FD129238EB-P	2B		7~13.2	4900	117.3	15.5	1700	20.40	65000	1	57.0
FD249238LB-P	2B	24	12~26.4	3300	80.5	7.8	250	6.00	80000	4	48.0
FD249238MB-P	2B		12~26.4	3800	92.6	10.9	350	8.40	80000	3	51.0
FD249238HB-P	2B		12~26.4	4300	102.9	11.9	470	11.28	75000	2	55.0
FD249238EB-P	2B		12~26.4	4900	117.3	15.5	600	14.40	65000	1	57.0
FD489238LB-P	2B	48	24~56.0	3300	80.5	7.8	130	6.24	80000	4	48.0
FD489238MB-P	2B		24~56.0	3800	92.6	10.9	170	8.16	80000	3	51.0
FD489238HB-P	2B		24~56.0	4300	102.9	11.9	290	13.92	75000	2	55.0
FD489238EB-P	2B		24~56.0	4900	117.3	15.5	290	13.92	65000	1	57.0

2B: 2-ball bearing L: sintetico bearing S: sleeve bearing

Voltage Available
05 12 24 48

Bearing System Available
2B L S

Function Available
N A I F R Q S T M V C P D W U

PERFORMANCE P-Q CURVE

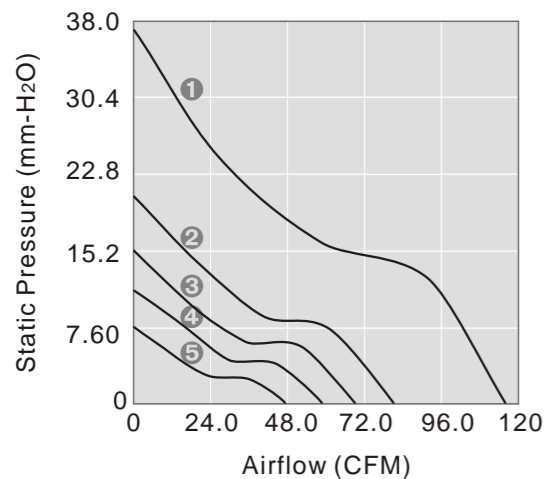

OUTLINE DIMENSIONS

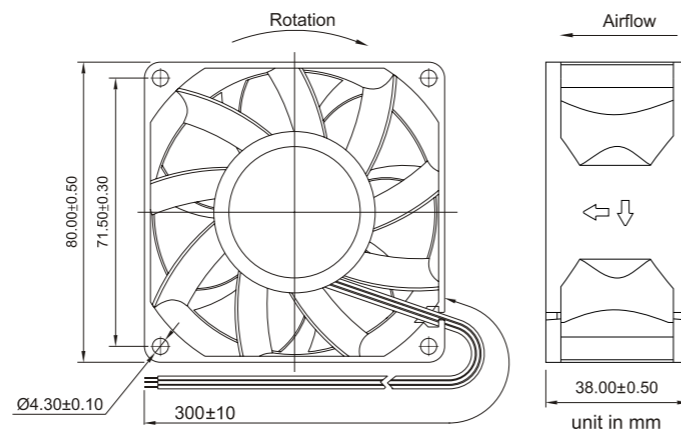

Please refer to Model Numbering System for bearing, function and speed level indication. Specifications are subject to changes without notice. Please refer to the formally issued product specification via contacting Y.S. TECH sales department. Visit Y.S. TECH web site at <http://www.ystech.com.tw> for updated information. Customized Specifications are designed accordingly.

2B: 2-ball bearing L: sintetico bearing S: sleeve bearing

Voltage Available
05 12 24 48

Bearing System Available
2B L S

Function Available
N A I F R Q S T M V C P D W U

PERFORMANCE P-Q CURVE

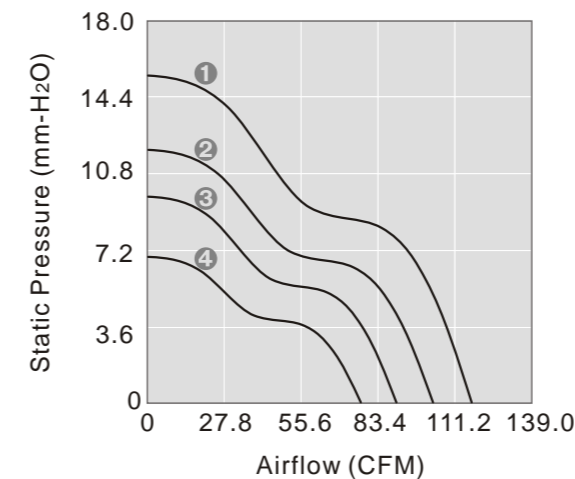

OUTLINE DIMENSIONS

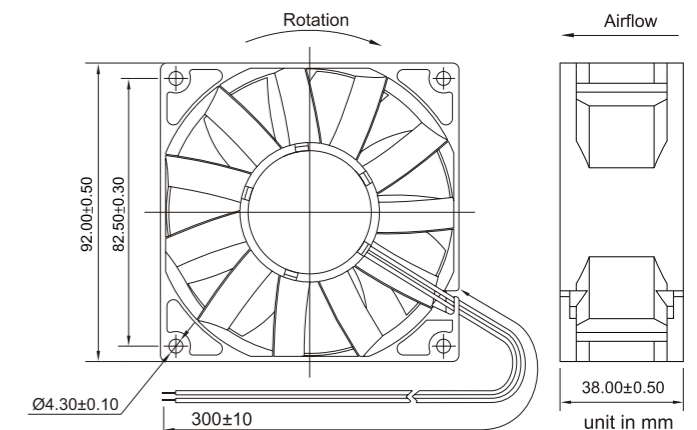

Please refer to Model Numbering System for bearing, function and speed level indication. Specifications are subject to changes without notice. Please refer to the formally issued product specification via contacting Y.S. TECH sales department. Visit Y.S. TECH web site at <http://www.ystech.com.tw> for updated information. Customized Specifications are designed accordingly.



120x120x38mm

- Airflow: 194.4~315.3 CFM
- Static Pressure: 31.1~50.5 mm-H₂O
- Blade / Housing: Plastic Material UL 94V-0 P.B.T.
- Lead Wire: UL1007 #22 AWG
- Weight: 400 g



120x120x38mm

- Airflow: 88.0~142.0 CFM
- Static Pressure: 8.4~20.0 mm-H₂O
- Blade / Housing: Plastic Material UL 94V-0 P.B.T.
- Frame: Die-Casting Aluminum
- Lead Wire: UL1007 #22 AWG
- Weight: 396.8 g

Model No.	Bearing	Rated Voltage	Operating Voltage Range	Speed	Max. Airflow	Max. Static Pressure	Current	Power Consumption	Life at 40°C L10	P-Q Curve	Noise Level
		VDC	VDC	RPM	CFM	mm-H ₂ O	mA	W	Hour		dB(A)
FD121238LB-P	2B	12	8~13.2	4000	194.4	31.1	2200	26.40	80000	5	64.0
FD121238MB-P	2B		8~13.2	4400	213.7	34.2	2600	31.20	80000	4	66.0
FD241238LB-P	2B	24	15~27.0	4000	194.4	31.1	850	20.40	80000	5	64.0
FD241238MB-P	2B		15~27.0	4400	213.7	34.2	1000	24.00	80000	4	66.0
FD241238HB-P	2B	24	15~27.0	5100	247.6	39.6	1600	38.40	65000	3	69.5
FD241238EB-P	2B		15~27.0	5800	281.5	45.1	2400	57.60	65000	2	72.5
FD481238LB-P	2B	48	35~56.0	4000	194.4	31.1	460	22.08	80000	5	64.0
FD481238MB-P	2B		35~56.0	4400	213.7	34.2	550	26.40	80000	4	66.0
FD481238HB-P	2B	48	35~56.0	5100	247.6	39.6	750	36.00	75000	3	69.5
FD481238EB-P	2B		35~56.0	5800	281.5	45.1	1100	52.80	65000	2	72.5
FD481238EB-P	2B	35~56.0	6500	315.3	50.5	1550	74.40	65000	1	74.5	

Model No.	Bearing	Rated Voltage	Operating Voltage Range	Speed	Max. Airflow	Max. Static Pressure	Current	Power Consumption	Life at 40°C L10	P-Q Curve	Noise Level
		VDC	VDC	RPM	CFM	mm-H ₂ O	mA	W	Hour		dB(A)
FD121238LB-R	2B	12	7~13.2	2800	88.0	8.4	270	3.24	80000	5	45.5
FD121238MB-R	2B		7~13.2	3200	100.9	10.5	360	4.32	80000	4	47.0
FD121238HB-R	2B	12	7~13.2	3600	113.9	13.0	520	6.24	75000	3	51.0
FD121238EB-R	2B		7~13.2	4000	127.0	16.0	700	8.40	65000	2	55.0
FD121238EB-R	2B	12	7~13.2	4500	142.0	20.0	950	11.40	65000	1	58.5
FD241238LB-R	2B		12~26.4	2800	88.0	8.4	145	3.48	80000	5	45.5
FD241238MB-R	2B	24	12~26.4	3200	100.9	10.5	195	4.68	80000	4	47.0
FD241238HB-R	2B		12~26.4	3600	113.9	13.0	270	6.48	75000	3	51.0
FD241238EB-R	2B	24	12~26.4	4000	127.0	16.0	370	8.88	65000	2	55.0
FD241238EB-R	2B		12~26.4	4500	142.0	20.0	520	12.48	65000	1	58.5
FD481238LB-R	2B	48	24~56.0	2800	88.0	8.4	100	4.80	80000	5	45.5
FD481238MB-R	2B		24~56.0	3200	100.9	10.5	130	6.24	80000	4	47.0
FD481238HB-R	2B	48	24~56.0	3600	113.9	13.0	170	8.16	75000	3	51.0
FD481238EB-R	2B		24~56.0	4000	127.0	16.0	200	9.60	65000	2	55.0
FD481238EB-R	2B	24~56.0	4500	142.0	20.0	270	12.96	65000	1	58.5	

2B: 2-ball bearing L: sintetico bearing S: sleeve bearing

Voltage Available
05 12 24 48

Bearing System Available
2B L S

Function Available
N A I F R Q S T M V C P D W U

PERFORMANCE P-Q CURVE

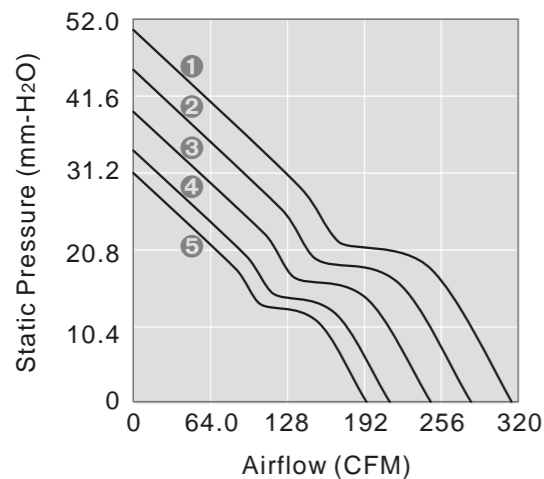

OUTLINE DIMENSIONS

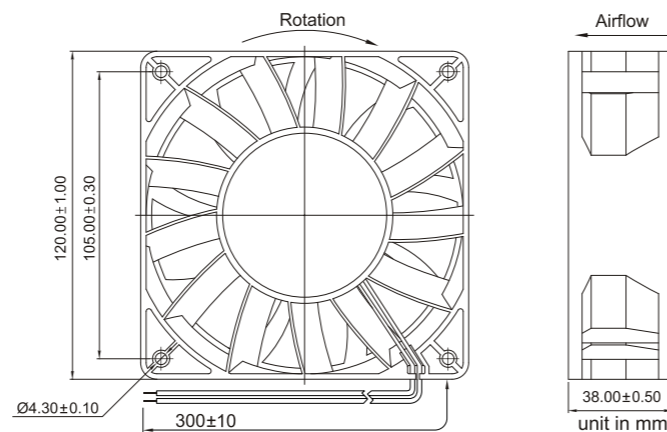

Please refer to Model Numbering System for bearing, function and speed level indication. Specifications are subject to changes without notice. Please refer to the formally issued product specification via contacting Y.S. TECH sales department. Visit Y.S. TECH web site at <http://www.ystech.com.tw> for updated information. Customized Specifications are designed accordingly.

2B: 2-ball bearing L: sintetico bearing S: sleeve bearing

Voltage Available
05 12 24 48

Bearing System Available
2B L S

Function Available
N A I F R Q S T M V C P D W U

PERFORMANCE P-Q CURVE

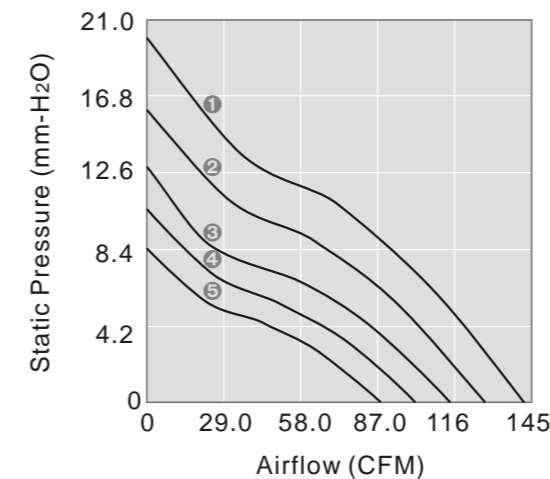

OUTLINE DIMENSIONS

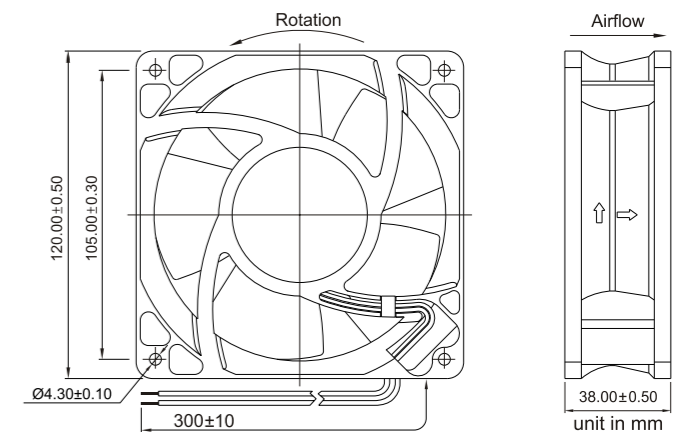

Please refer to Model Numbering System for bearing, function and speed level indication. Specifications are subject to changes without notice. Please refer to the formally issued product specification via contacting Y.S. TECH sales department. Visit Y.S. TECH web site at <http://www.ystech.com.tw> for updated information. Customized Specifications are designed accordingly.



172x150x51mm

- Airflow: 247.5~464.0 CFM
- Static Pressure: 16.7~52.0 mm-H₂O
- Blade / Housing: Plastic Material UL 94V-0 P.P.O. Frame: Die-Casting Aluminum
- Lead Wire: UL1007 #22 AWG
- Weight: 1080 g



80x80x25mm

- Airflow: 38.0~55.1 CFM
- Static Pressure: 3.9~6.6 mm-H₂O
- Blade: Plastic Material UL 94V-0 P.B.T.
- Frame: Die-Casting Aluminum
- Weight: 138 g

Model No.	Bearing	Rated Voltage	Operating Voltage Range	Speed	Max. Airflow	Max. Static Pressure	Current	Power Consumption	Life at 40°C L10	P-Q Curve	Noise Level
		VDC	VDC	RPM	CFM	mm-H ₂ O	mA	W	Hour		dB(A)
FD121751LB	2B	12	7~13.2	3000	247.5	16.7	1800	21.60	80000	6	57.2
FD121751MB	2B		7~13.2	3500	294.4	23.7	2800	33.60	80000	5	62.1
FD241751LB	2B	24	12~26.4	3000	247.5	16.7	850	20.40	80000	6	57.2
FD241751MB	2B		12~26.4	3500	294.4	23.7	1250	30.00	80000	5	62.1
FD241751HB	2B	48	12~26.4	4000	335.4	29.8	1850	40.40	75000	4	63.0
FD241751EB	2B		12~26.4	4500	379.7	37.1	2700	64.80	65000	3	67.3
FD481751LB	2B	48	24~56.0	3000	247.5	16.7	440	21.12	80000	6	57.2
FD481751MB	2B		24~56.0	3500	294.4	23.7	650	31.20	80000	5	62.1
FD481751HB	2B	48	24~56.0	4000	335.4	29.8	950	45.60	75000	4	63.0
FD481751EB	2B		24~56.0	4500	379.7	37.1	1250	60.00	65000	3	67.3
FD481751EB	2B	48	24~56.0	5000	419.9	46.3	1650	79.20	65000	2	71.1
FD481751EB	2B		24~56.0	5500	464.0	52.0	2400	115.2	65000	1	73.1

Model No.	Bearing	Rated Voltage	Freq	Speed	Max. Airflow	Max. Static Pressure	Current	Power Consumption	Life at 40°C L10	P-Q Curve	Noise Level
		VAC	Hz	RPM	CFM	mm-H ₂ O	A	W	Hour		dB(A)
FV18025LBA	2B	110	50/60	2800/3200	38.6/44.1	3.9/4.4	0.11/0.13	1.90/2.40	50000	4/3	34.0/38.5
FV18025MBA	2B		50/60	3200/3600	44.1/49.6	4.4/5.7	0.15/0.17	2.80/3.60	50000	3/2	38.5/42.0
FV18025HBA	2B	220	50/60	3600/4000	49.6/55.1	5.7/6.6	0.16/0.19	3.40/4.30	50000	2/1	42.0/45.5
FV28025LBA	2B		50/60	2800/3200	38.6/44.1	3.9/4.4	0.11/0.13	2.80/3.40	50000	4/3	34.0/38.5
FV28025MBA	2B	220	50/60	3200/3600	44.1/49.6	4.4/5.7	0.14/0.17	3.80/4.80	50000	3/2	38.5/42.0
FV28025HBA	2B		50/60	3600/4000	49.6/55.1	5.7/6.6	0.15/0.18	4.30/5.30	50000	2/1	42.0/45.5

2B: 2-ball bearing L: sintetico bearing S: sleeve bearing

Voltage Available
05 12 24 48

Bearing System Available
2B L S

Function Available
N A I F R Q S T M V C P D W U

PERFORMANCE P-Q CURVE

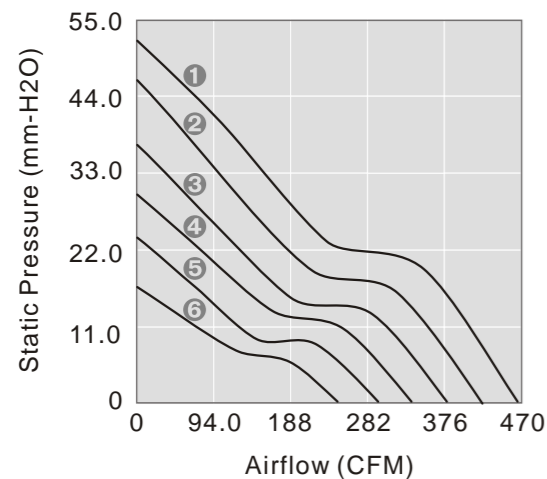

OUTLINE DIMENSIONS

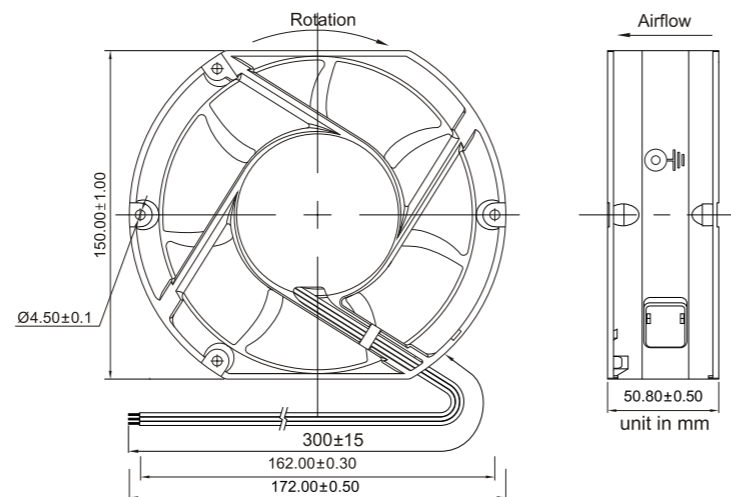

Please refer to Model Numbering System for bearing, function and speed level indication. Specifications are subject to changes without notice. Please refer to the formally issued product specification via contacting Y.S. TECH sales department. Visit Y.S. TECH web site at <http://www.ystech.com.tw> for updated information. Customized Specifications are designed accordingly.

2B: 2-ball bearing S: sleeve bearing

Voltage Available
115 230

Bearing System Available
2B S

PERFORMANCE P-Q CURVE

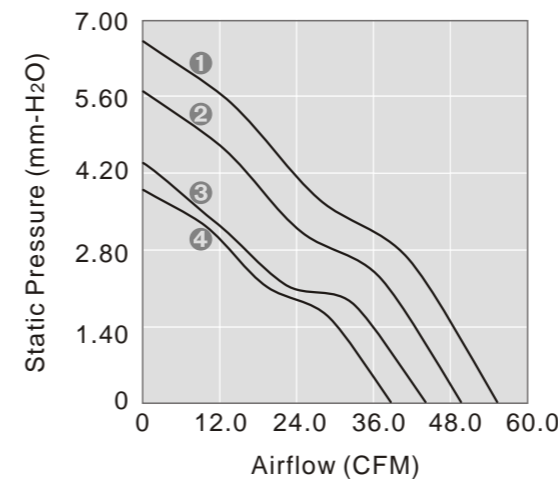

OUTLINE DIMENSIONS

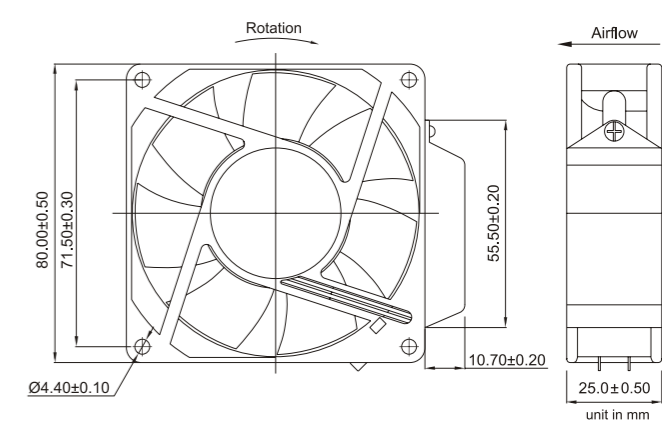

Please refer to Model Numbering System for bearing, function and speed level indication. Specifications are subject to changes without notice. Please refer to the formally issued product specification via contacting Y.S. TECH sales department. Visit Y.S. TECH web site at <http://www.ystech.com.tw> for updated information. Customized Specifications are designed accordingly.



80x80x26mm

- Airflow: 14.5~18.3 CFM
- Static Pressure: 3.31~5.16 mm-H2O
- Blade: Plastic Material UL 94V-0 P.B.T.
- Frame: Die-Cast Aluminum
- Weight: 260 g



80x80x38mm

- Airflow: 16.7~24.3 CFM
- Static Pressure: 2.88~6.29 mm-H2O
- Blade: Plastic Material UL 94V-0 P.B.T.
- Frame: Die-Cast Aluminum
- Weight: 370 g

Model No.	Bearing	Rated Voltage	Freq	Speed	Max. Airflow	Max. Static Pressure	Current	Power Consumption	Life at 40°C L10	P-Q Curve	Noise Level
	VAC	Hz	RPM	CFM	mm-H ₂ O	A	W	Hour			
FA108025HST-T S	115	50/60	2500/3000	14.5/18.3	3.31/5.16	0.17/0.15	15.0/13.0	20000	①/②	28.2/35.0	
FA108025HSL-T S				14.5/18.3	3.31/5.16	0.17/0.15	15.0/13.0	20000	①/②	28.2/35.0	
FA108025HBT-T 2B				14.5/18.3	3.31/5.16	0.17/0.15	15.0/13.0	60000	②/②	28.2/35.0	
FA108025HBL-T 2B				14.5/18.3	3.31/5.16	0.17/0.15	15.0/13.0	60000	②/②	28.2/35.0	
FA208025HST-T S	230	50/60	2500/3000	14.5/18.3	3.31/5.16	0.08/0.07	15.0/13.0	20000	①/②	28.2/35.0	
FA208025HSL-T S				14.5/18.3	3.31/5.16	0.08/0.07	15.0/13.0	20000	①/②	28.2/35.0	
FA208025HBT-T 2B				14.5/18.3	3.31/5.16	0.08/0.07	15.0/13.0	60000	②/②	28.2/35.0	
FA208025HBL-T 2B				14.5/18.3	3.31/5.16	0.08/0.07	15.0/13.0	60000	②/②	28.2/35.0	

Model No.	Bearing	Rated Voltage	Freq	Speed	Max. Airflow	Max. Static Pressure	Current	Power Consumption	Life at 40°C L10	P-Q Curve	Noise Level
	VAC	Hz	RPM	CFM	mm-H ₂ O	A	W	Hour			
FA108038HST-T S	115	50/60	2450/3000	20.4/24.3	4.45/6.29	0.12/0.10	14.0/12.0	20000	①/②	29.9/37.2	
FA108038HSL-T S				20.4/24.3	4.45/6.29	0.12/0.10	14.0/12.0	20000	①/②	29.9/37.2	
FA108038MBT-T 2B				16.7/18.8	2.88/3.35	0.07/0.06	11.0/ 9.0	60000	②/②	26.2/29.2	
FA108038MBL-T 2B				16.7/18.8	2.88/3.35	0.07/0.06	11.0/ 9.0	60000	②/②	26.2/29.2	
FA108038HBT-T 2B	230	50/60	2450/3000	20.4/24.3	4.45/6.29	0.12/0.10	14.0/12.0	60000	①/②	29.9/37.2	
FA108038HBL-T 2B				20.4/24.3	4.45/6.29	0.12/0.10	14.0/12.0	60000	①/②	29.9/37.2	
FA208038HST-T S				20.4/24.3	4.45/6.29	0.06/0.05	14.0/12.0	20000	①/②	29.9/37.2	
FA208038HSL-T S				20.4/24.3	4.45/6.29	0.06/0.05	14.0/12.0	20000	①/②	29.9/37.2	
FA208038MBT-T 2B	230	50/60	2100/2300	16.7/18.8	2.88/3.35	0.05/0.04	11.0/ 9.0	60000	②/②	26.2/29.2	
FA208038MBL-T 2B				16.7/18.8	2.88/3.35	0.05/0.04	11.0/ 9.0	60000	②/②	26.2/29.2	
FA208038HBT-T 2B				20.4/24.3	4.45/6.29	0.06/0.05	14.0/12.0	60000	①/②	29.9/37.2	
FA208038HBL-T 2B				20.4/24.3	4.45/6.29	0.06/0.05	14.0/12.0	60000	①/②	29.9/37.2	

2B: 2-ball bearing S: sleeve bearing

Voltage Available **115 230** Bearing System Available **2B S**

PERFORMANCE P-Q CURVE

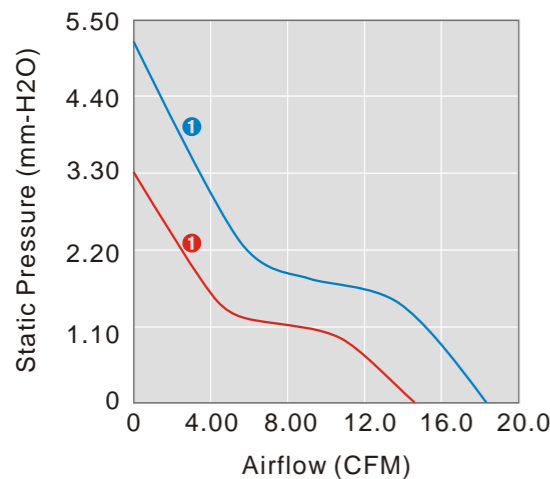

OUTLINE DIMENSIONS

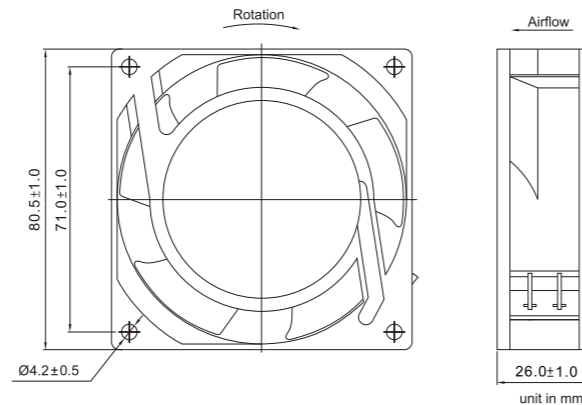

2B: 2-ball bearing S: sleeve bearing

Voltage Available **115 230** Bearing System Available **2B S**

PERFORMANCE P-Q CURVE

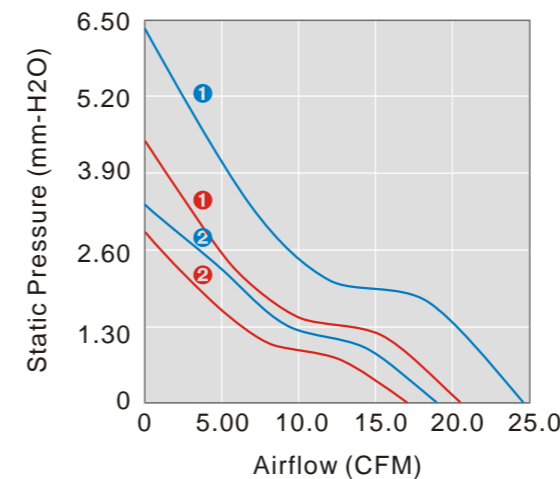

OUTLINE DIMENSIONS

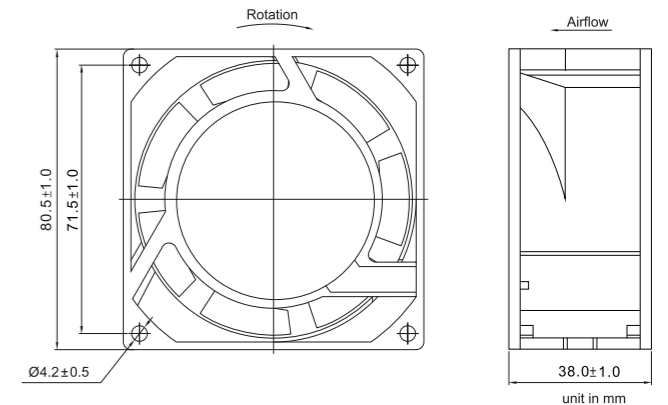

Please refer to Model Numbering System for bearing, function and speed level indication. Specifications are subject to changes without notice. Please refer to the formally issued product specification via contacting Y.S. TECH sales department. Visit Y.S. TECH web site at <http://www.ystech.com.tw> for updated information. Customized Specifications are designed accordingly.

Please refer to Model Numbering System for bearing, function and speed level indication. Specifications are subject to changes without notice. Please refer to the formally issued product specification via contacting Y.S. TECH sales department. Visit Y.S. TECH web site at <http://www.ystech.com.tw> for updated information. Customized Specifications are designed accordingly.



92x92x25.5mm

- Airflow: 17.3~32.0 CFM
- Static Pressure: 1.39~5.70 mm-H2O
- Blade: Plastic Material UL 94V-0 P.B.T.
- Frame: Die-Cast Aluminum
- Weight: 260 g



92x92x38.0mm

- Airflow: 34.0~47.0 CFM
- Static Pressure: 2.20~6.00 mm-H2O
- Blade: Plastic Material UL 94V-0 P.B.T.
- Frame: Die-Cast Aluminum
- Weight: 450 g

Model No.	Bearing	Rated Voltage	Freq	Speed	Max. Airflow	Max. Static Pressure	Current	Power Consumption	Life at 40°C L10	P-Q Curve	Noise Level
	VAC	Hz	RPM	CFM	mm-H2O	A	W	Hour	dB(A)		
FA109225HST-T	S	50/60	2500/3000	26/32	3.80/5.70	0.18/0.16	15.0/13.0	20000	1/1	31.7/39.1	
FA109225HSL-T	S	50/60	2500/3000	26/32	3.80/5.70	0.18/0.16	15.0/13.0	20000	1/1	31.7/39.1	
FA109225LBT-T	2B	50/60	1600/1800	17.3/18.3	1.39/1.42	0.07/0.06	7.0/6.0	60000	3/3	26.5/27.0	
FA109225LBL-T	2B	50/60	1600/1800	17.3/18.3	1.39/1.42	0.07/0.06	7.0/6.0	60000	3/3	26.5/27.0	
FA109225MBT-T	2B	50/60	2100/2300	22/25	2.50/2.90	0.09/0.08	10.0/9.0	60000	2/2	28.6/32.0	
FA109225MBL-T	2B	50/60	2100/2300	22/25	2.50/2.90	0.09/0.08	10.0/9.0	60000	2/2	28.6/32.0	
FA109225HBT-T	2B	50/60	2500/3000	26/32	3.80/5.70	0.18/0.16	15.0/13.0	60000	1/1	31.7/39.1	
FA109225HBL-T	2B	50/60	2500/3000	26/32	3.80/5.70	0.18/0.16	15.0/13.0	60000	1/1	31.7/39.1	
FA209225HST-T	S	50/60	2500/3000	26/32	3.80/5.70	0.08/0.07	15.0/13.0	20000	1/1	31.7/39.1	
FA209225HSL-T	S	50/60	2500/3000	26/32	3.80/5.70	0.08/0.07	15.0/13.0	20000	1/1	31.7/39.1	
FA209225LBT-T	2B	50/60	1600/1800	17.3/18.3	1.39/1.42	0.05/0.04	7.0/6.0	60000	3/3	26.5/27.0	
FA209225LBL-T	2B	50/60	1600/1800	17.3/18.3	1.39/1.42	0.05/0.04	7.0/6.0	60000	3/3	26.5/27.0	
FA209225MBT-T	2B	50/60	2100/2300	22/25	2.50/2.90	0.09/0.08	10.0/9.0	60000	2/2	28.6/32.0	
FA209225MBL-T	2B	50/60	2100/2300	22/25	2.50/2.90	0.09/0.08	10.0/9.0	60000	2/2	28.6/32.0	
FA209225HBT-T	2B	50/60	2500/3000	26/32	3.80/5.70	0.08/0.07	15.0/13.0	60000	1/1	31.7/39.1	
FA209225HBL-T	2B	50/60	2500/3000	26/32	3.80/5.70	0.08/0.07	15.0/13.0	60000	1/1	31.7/39.1	

2B: 2-ball bearing S: sleeve bearing

Voltage Available: 115 230
Bearing System Available: 2B S

PERFORMANCE P-Q CURVE

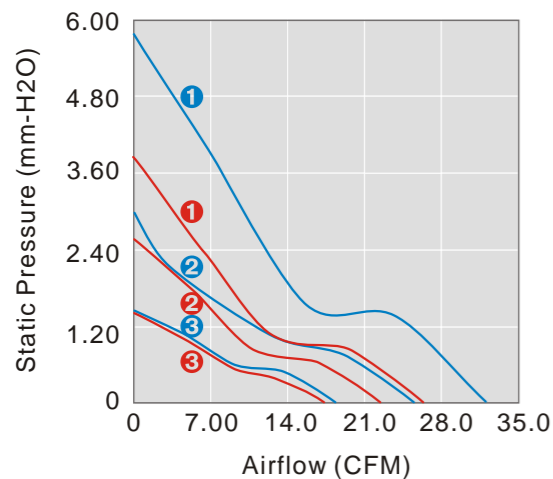

OUTLINE DIMENSIONS

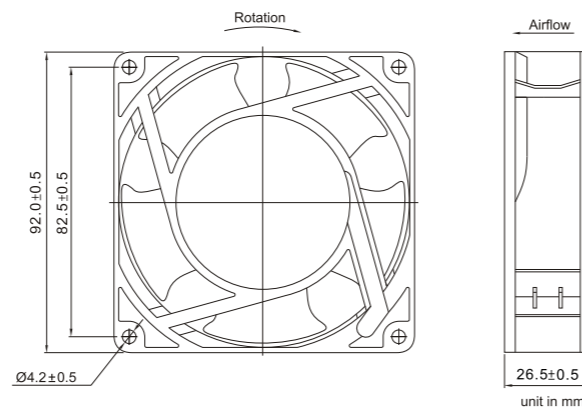

Model No.	Bearing	Rated Voltage	Freq	Speed	Max. Airflow	Max. Static Pressure	Current	Power Consumption	Life at 40°C L10	P-Q Curve	Noise Level
	VAC	Hz	RPM	CFM	mm-H2O	A	W	Hour	dB(A)		
FA109238HST-T	S	50/60	2550/3100	40/47	4.50/6.00	0.12/0.11	14.0/12.0	20000	1/1	36.0/41.0	
FA109238HSL-T	S	50/60	2550/3100	40/47	4.50/6.00	0.12/0.11	14.0/12.0	20000	1/1	36.0/41.0	
FA109238LBT-T	2B	50/60	1900/1800	36/34	3.20/2.20	0.05/0.04	7.0/5.0	60000	3/3	30.2/27.8	
FA109238LBL-T	2B	50/60	1900/1800	36/34	3.20/2.20	0.05/0.04	7.0/5.0	60000	3/3	30.2/27.8	
FA109238MBT-T	2B	50/60	2200/2400	38/40	3.88/3.78	0.07/0.06	11.0/9.0	60000	2/2	32.9/35.3	
FA109238MBL-T	2B	50/60	2200/2400	38/40	3.88/3.78	0.07/0.06	11.0/9.0	60000	2/2	32.9/35.3	
FA109238HBT-T	2B	50/60	2550/3100	40/47	4.50/6.00	0.12/0.11	14.0/12.0	60000	1/1	36.0/41.0	
FA109238HBL-T	2B	50/60	2550/3100	40/47	4.50/6.00	0.12/0.11	14.0/12.0	60000	1/1	36.0/41.0	
FA209238HST-T	S	50/60	2550/3100	40/47	4.50/6.00	0.06/0.05	14.0/12.0	60000	1/1	36.0/41.0	
FA209238HSL-T	S	50/60	2550/3100	40/47	4.50/6.00	0.06/0.05	14.0/12.0	60000	1/1	36.0/41.0	
FA209238HBT-T	2B	50/60	2550/3100	40/47	4.50/6.00	0.06/0.05	14.0/12.0	60000	1/1	36.0/41.0	
FA209238HBL-T	2B	50/60	2550/3100	40/47	4.50/6.00	0.06/0.05	14.0/12.0	60000	1/1	36.0/41.0	

2B: 2-ball bearing S: sleeve bearing

Voltage Available: 115 230
Bearing System Available: 2B S

PERFORMANCE P-Q CURVE

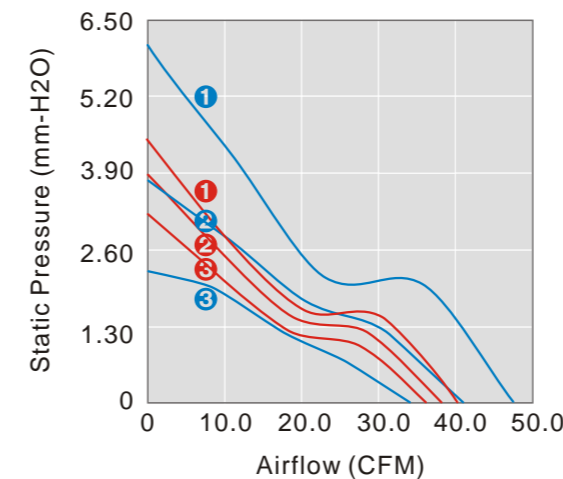

OUTLINE DIMENSIONS

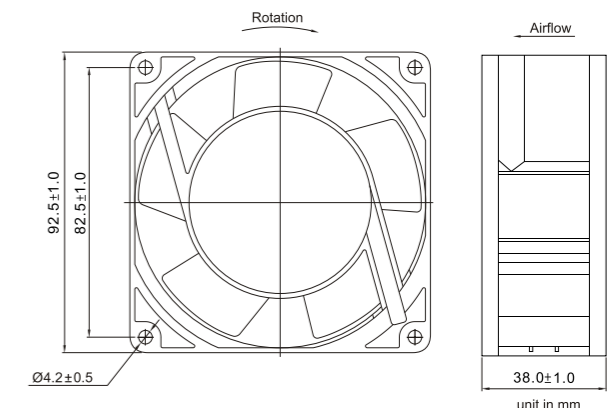

Please refer to Model Numbering System for bearing, function and speed level indication. Specifications are subject to changes without notice. Please refer to the formally issued product specification via contacting Y.S. TECH sales department. Visit Y.S. TECH web site at <http://www.ystech.com.tw> for updated information. Customized Specifications are designed accordingly.

Please refer to Model Numbering System for bearing, function and speed level indication. Specifications are subject to changes without notice. Please refer to the formally issued product specification via contacting Y.S. TECH sales department. Visit Y.S. TECH web site at <http://www.ystech.com.tw> for updated information. Customized Specifications are designed accordingly.



120x120x25.5mm

- Airflow: 43.2~67.27 CFM
- Static Pressure: 1.5~6.2 mm-H2O
- Blade: Plastic Material UL 94V-0 P.B.T.
- Frame: Die-Cast Aluminum
- Weight: 390 g



120x120x38mm

- Airflow: 65.0~108.0 CFM
- Static Pressure: 2.04~8.80 mm-H2O
- Blade: Plastic Material UL 94V-0 P.B.T.
- Frame: Die-Cast Aluminum
- Weight: 550 g

Model No.	Bearing	Rated Voltage	Freq	Speed	Max. Airflow	Max. Static Pressure	Current	Power Consumption	Life at 40°C L10	P-Q Curve	Noise Level
	VAC	Hz	RPM	CFM	mm-H2O	A	W	Hour	dB(A)		
FA112025HST-T	S	50/60	2400/2900	57.5/67.3	5.30/6.20	0.25/0.20	17.0/15.0	20000	①/①	44.5/48.2	
FA112025HSL-T	S	50/60	2400/2900	57.5/67.3	5.30/6.20	0.25/0.20	17.0/15.0	20000	①/①	44.5/48.2	
FA112025LBT-T	2B	50/60	1800/1600	47.1/43.2	2.30/1.50	0.06/0.05	8.0/6.0	60000	③/③	36.7/35.0	
FA112025LBL-T	2B	50/60	1800/1600	47.1/43.2	2.30/1.50	0.06/0.05	8.0/6.0	60000	③/③	36.7/35.0	
FA112025MBT-T	2B	50/60	2200/2300	53.8/57.8	3.99/3.77	0.09/0.08	12.0/10.0	60000	②/②	43.0/45.0	
FA112025MBL-T	2B	50/60	2200/2300	53.8/57.8	3.99/3.77	0.09/0.08	12.0/10.0	60000	②/②	43.0/45.0	
FA112025HBT-T	2B	50/60	2400/2900	57.5/67.3	5.30/6.20	0.25/0.20	17.0/15.0	20000	①/①	44.5/48.2	
FA112025HBL-T	2B	50/60	2400/2900	57.5/67.3	5.30/6.20	0.25/0.20	17.0/15.0	20000	①/①	44.5/48.2	
FA212025HST-T	S	50/60	2400/2900	57.5/67.3	5.30/6.20	0.09/0.07	17.0/15.0	20000	①/①	44.5/48.2	
FA212025HSL-T	S	50/60	2400/2900	57.5/67.3	5.30/6.20	0.09/0.07	17.0/15.0	20000	①/①	44.5/48.2	
FA212025LBT-T	2B	50/60	1800/1600	47.1/43.2	2.30/1.50	0.05/0.04	8.0/6.0	60000	③/③	36.7/35.0	
FA212025LBL-T	2B	50/60	1800/1600	47.1/43.2	2.30/1.50	0.05/0.04	8.0/6.0	60000	③/③	36.7/35.0	
FA212025MBT-T	2B	50/60	2200/2300	53.8/57.8	3.99/3.77	0.06/0.05	12.0/10.0	60000	②/②	43.0/45.0	
FA212025MBL-T	2B	50/60	2200/2300	53.8/57.8	3.99/3.77	0.06/0.05	12.0/10.0	60000	②/②	43.0/45.0	
FA212025HBT-T	2B	50/60	2400/2900	57.5/67.3	5.30/6.20	0.09/0.07	17.0/15.0	20000	①/①	44.5/48.2	
FA212025HBL-T	2B	50/60	2400/2900	57.5/67.3	5.30/6.20	0.09/0.07	17.0/15.0	20000	①/①	44.5/48.2	

2B: 2-ball bearing S: sleeve bearing

Voltage Available
115 230

Bearing System Available
2B S

PERFORMANCE P-Q CURVE

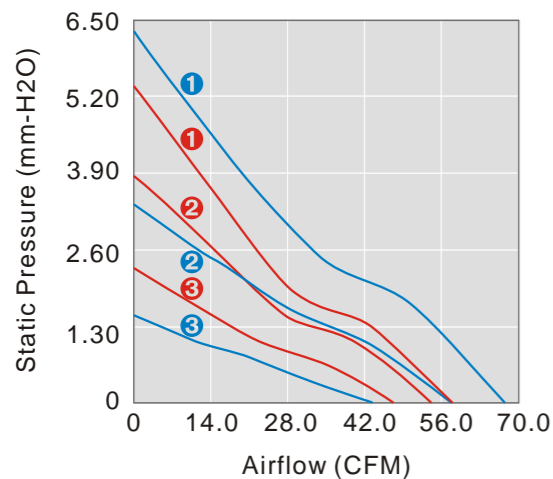

OUTLINE DIMENSIONS

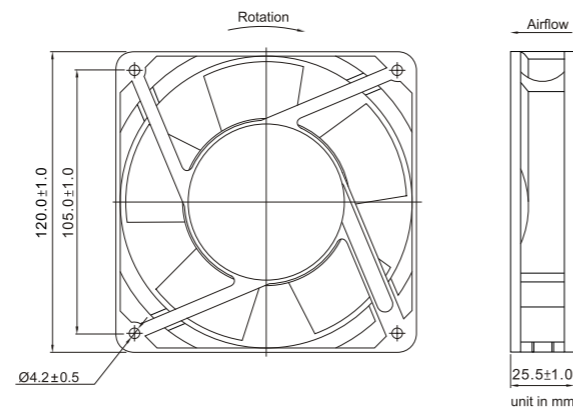

Model No.	Bearing	Rated Voltage	Freq	Speed	Max. Airflow	Max. Static Pressure	Current	Power Consumption	Life at 40°C L10	P-Q Curve	Noise Level
	VAC	Hz	RPM	CFM	mm-H2O	A	W	Hour	dB(A)		
FA112038HST-T	S	50/60	2500/3000	96/108	7.80/8.80	0.25/0.21	17.0/15.0	20000	①/①	45.0/50.0	
FA112038HSL-T	S	50/60	2500/3000	96/108	7.80/8.80	0.25/0.21	17.0/15.0	20000	①/①	45.0/50.0	
FA112038LBT-T	2B	50/60	1800/1600	83/65	4.20/2.04	0.10/0.10	9.0/8.0	60000	③/③	41.1/32.5	
FA112038LBL-T	2B	50/60	1800/1600	83/65	4.20/2.04	0.10/0.10	9.0/8.0	60000	③/③	41.1/32.5	
FA112038MBT-T	2B	50/60	2100/2300	90/88	6.20/4.00	0.14/0.13	12.0/11.0	60000	②/②	41.0/43.0	
FA112038MBL-T	2B	50/60	2100/2300	90/88	6.20/4.00	0.14/0.13	12.0/11.0	60000	②/②	41.0/43.0	
FA112038HBT-T	2B	50/60	2500/3000	96/108	7.80/8.80	0.25/0.21	17.0/15.0	60000	①/①	45.0/50.0	
FA112038HBL-T	2B	50/60	2500/3000	96/108	7.80/8.80	0.25/0.21	17.0/15.0	60000	①/①	45.0/50.0	
FA212038HST-T	S	50/60	2500/3000	96/108	7.80/8.80	0.12/0.10	17.0/15.0	20000	①/①	45.0/50.0	
FA212038HSL-T	S	50/60	2500/3000	96/108	7.80/8.80	0.12/0.10	17.0/15.0	20000	①/①	45.0/50.0	
FA212038LBT-T	2B	50/60	1800/1600	83/65	4.20/2.04	0.07/0.06	12.0/11.0	60000	③/③	41.0/43.0	
FA212038LBL-T	2B	50/60	1800/1600	83/65	4.20/2.04	0.07/0.06	12.0/11.0	60000	③/③	41.0/43.0	
FA212038MBT-T	2B	50/60	2100/2300	90/88	6.20/4.00	0.07/0.06	12.0/11.0	60000	②/②	41.0/43.0	
FA212038HBT-T	2B	50/60	2500/3000	96/108	7.80/8.80	0.12/0.10	17.0/15.0	60000	①/①	45.0/50.0	
FA212038HBL-T	2B	50/60	2500/3000	96/108	7.80/8.80	0.12/0.10	17.0/15.0	60000	①/①	45.0/50.0	

2B: 2-ball bearing S: sleeve bearing

Voltage Available
115 230

Bearing System Available
2B S

PERFORMANCE P-Q CURVE

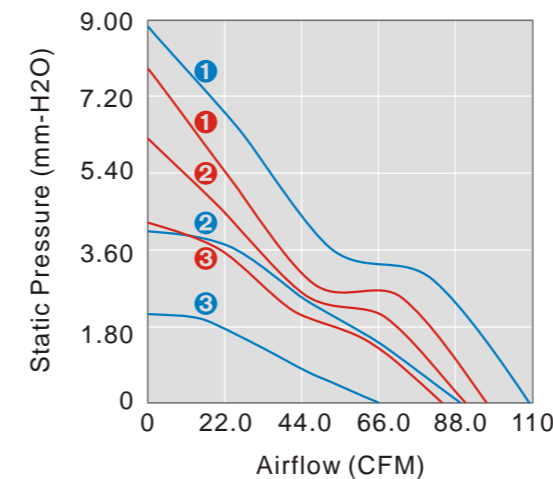

OUTLINE DIMENSIONS

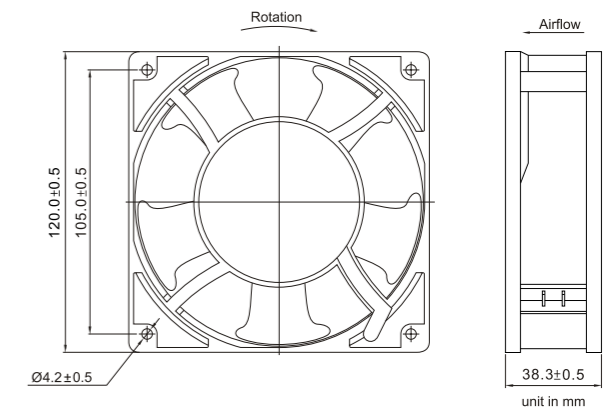

Please refer to Model Numbering System for bearing, function and speed level indication. Specifications are subject to changes without notice. Please refer to the formally issued product specification via contacting Y.S. TECH sales department. Visit Y.S. TECH web site at <http://www.ystech.com.tw> for updated information. Customized Specifications are designed accordingly.

Please refer to Model Numbering System for bearing, function and speed level indication. Specifications are subject to changes without notice. Please refer to the formally issued product specification via contacting Y.S. TECH sales department. Visit Y.S. TECH web site at <http://www.ystech.com.tw> for updated information. Customized Specifications are designed accordingly.



172x150x51mm

- Airflow: 190.0~223.0 CFM
- Static Pressure: 15.0~19.0 mm-H2O
- Blade: Plastic Material UL 94V-0 P.B.T.
- Frame: Die-Cast Aluminum
- Weight: 1050 g



176x176x89mm

- Airflow: 344.8~397.2 CFM
- Static Pressure: 15.9~20.7 mm-H2O
- Blade: Plastic Material UL 94V-0 P.B.T.
- Frame: Die-Cast Aluminum
- Weight: 2000 g

Model No.	Bearing	Rated Voltage	Freq	Speed	Max. Airflow	Max. Static Pressure	Current	Power Consumption	Life at 25°C L10	P-Q Curve	Noise Level
	VAC	Hz	RPM	CFM	mm-H ₂ O	A	W	Hour			dB(A)
FA117251HBT-T 2B	115	50/60	2600/3000	190/223	15.0/19.0	0.24/0.25	24.0/28.0	60000	60000	①/②	56.6/60.6
FA117251HBL-T 2B											
FA217251HBT-T 2B	230	50/60	2600/3000	190/223	15.0/19.0	0.12/0.16	24.0/28.0	60000	60000	①/②	56.6/60.6
FA217251HBL-T 2B											

Model No.	Bearing	Rated Voltage	Freq	Speed	Max. Airflow	Max. Static Pressure	Current	Power Consumption	Life at 65°C L10	P-Q Curve	Noise Level
	VAC	Hz	RPM	CFM	mm-H ₂ O	A	W	Hour			dB(A)
FA117689HBT-T 2B	115	50/60	2650/3200	344.8/397.2	15.9/20.7	0.57/0.48	50.0/52.0	40000	40000	①/②	61.1/64.8
FA117689HBL-T 2B											
FA217689HBT-T 2B	230	50/60	2650/3200	344.8/397.2	15.9/20.7	0.21/0.23	43.0/52.0	40000	40000	①/②	61.1/64.8
FA217689HBL-T 2B											

2B: 2-ball bearing S: sleeve bearing

Voltage Available **115 230** Bearing System Available **2B S**

PERFORMANCE P-Q CURVE

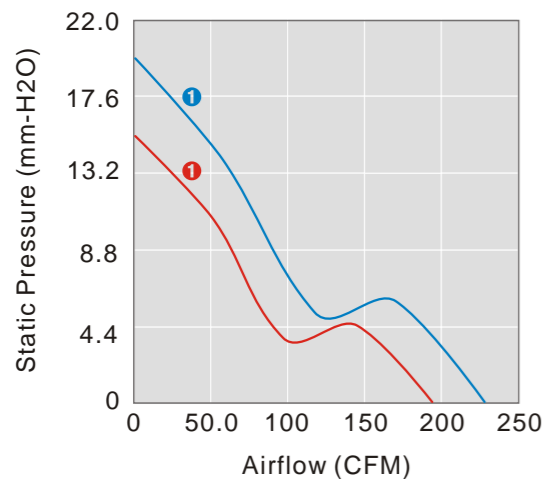

OUTLINE DIMENSIONS

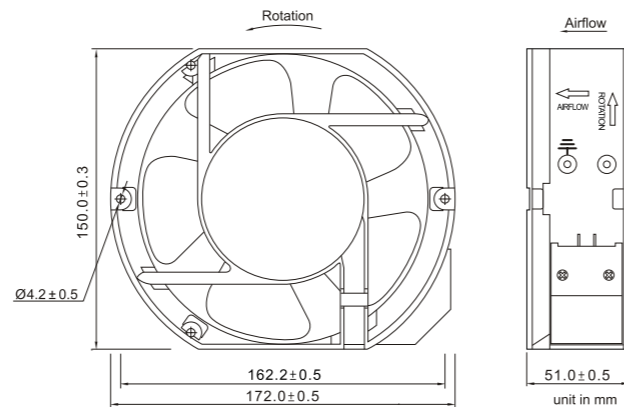

Please refer to Model Numbering System for bearing, function and speed level indication. Specifications are subject to changes without notice. Please refer to the formally issued product specification via contacting Y.S. TECH sales department. Visit Y.S. TECH web site at <http://www.ystech.com.tw> for updated information. Customized Specifications are designed accordingly.

2B: 2-ball bearing S: sleeve bearing

Voltage Available **115 230** Bearing System Available **2B S**

PERFORMANCE P-Q CURVE

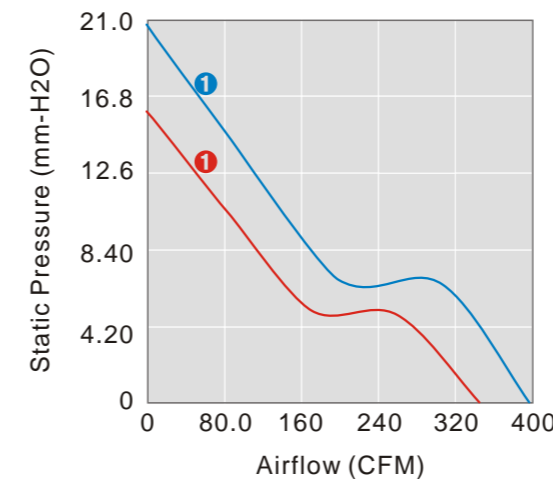

OUTLINE DIMENSIONS

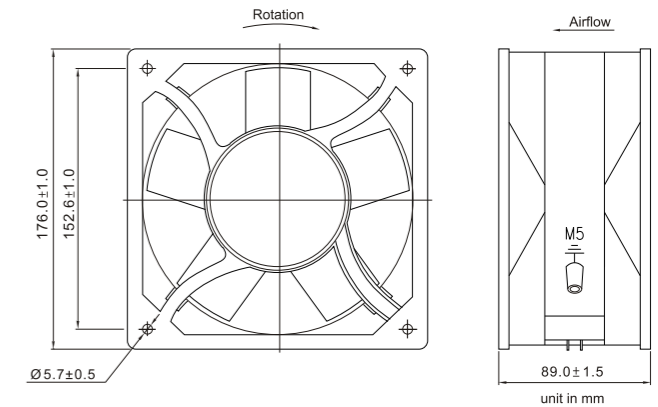

Please refer to Model Numbering System for bearing, function and speed level indication. Specifications are subject to changes without notice. Please refer to the formally issued product specification via contacting Y.S. TECH sales department. Visit Y.S. TECH web site at <http://www.ystech.com.tw> for updated information. Customized Specifications are designed accordingly.



180x180x65mm

- Airflow: 349.5~397.5 CFM
- Static Pressure: 17.6~22.0 mm-H₂O
- Blade: Plastic Material UL 94V-0 P.B.T.
- Frame: Die-Cast Aluminum
- Weight: 1800 g



Ø 254x89mm

- Airflow: 443.0~699.8 CFM
- Static Pressure: 6.87~8.39 mm-H₂O
- Blade: Plastic Material UL 94V-0 P.B.T.
- Frame: Die-Casting Aluminum
- Weight: 2000 g

Model No.	Bearing	Rated Voltage	Freq	Speed	Max. Airflow	Max. Static Pressure	Current	Power Consumption	Life at 65°C L10	P-Q Curve	Noise Level
	VAC	Hz	RPM	CFM	mm-H ₂ O	A	W	Hour		dB(A)	
FA118065HBT-T 2B	115	50/60	2650/3200	349.5/397.5	17.6/22.0	0.57/0.48	50.0/52.0	40000	①/①	59.7/63.6	
FA118065HBL-T 2B											
FA218065HBT-T 2B	230	50/60	2650/3200	349.5/397.5	17.6/22.0	0.23/0.24	43.0/52.0	40000	①/①	59.7/63.6	
FA218065HBL-T 2B											

Model No.	Bearing	Rated Voltage	Freq	Speed	Max. Airflow	Max. Static Pressure	Current	Power Consumption	Life at 65°C L10	P-Q Curve	Noise Level
	VAC	Hz	RPM	CFM	mm-H ₂ O	A	W	Hour		dB(A)	
FA125489MBT-T 2B	115	50/60	1400/1600	443/518	6.87/8.39	0.22/0.24	34.0/37.0	40000	②/②	52.6/59.5	
FA125489MBL-T 2B											
FA125489HBT-T 2B	230	50/60	2300/2200	700/620	8.90/6.80	0.55/0.62	60.0/67.0	40000	①/①	61.6/57.6	
FA125489HBL-T 2B											
FA225489MBT-T 2B	115	50/60	1400/1600	443/518	6.87/8.39	0.16/0.14	34.0/37.0	40000	②/②	52.6/59.5	
FA225489MBL-T 2B											
FA225489HBT-T 2B	230	50/60	2300/2200	700/620	8.90/6.80	0.26/0.30	60.0/67.0	40000	①/①	61.6/57.6	
FA225489HBL-T 2B											

2B: 2-ball bearing S: sleeve bearing

Voltage Available **115 230** Bearing System Available **2B S**

PERFORMANCE P-Q CURVE

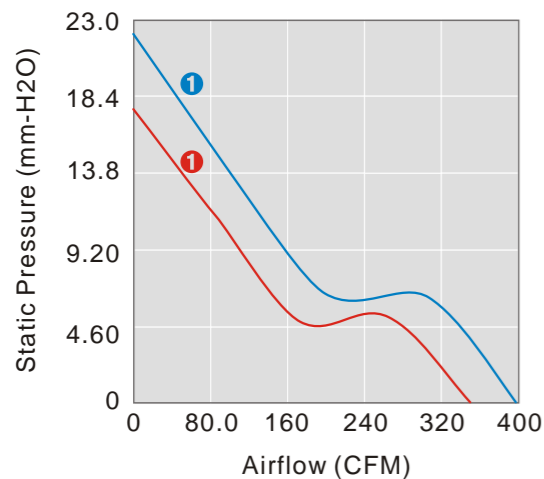

OUTLINE DIMENSIONS

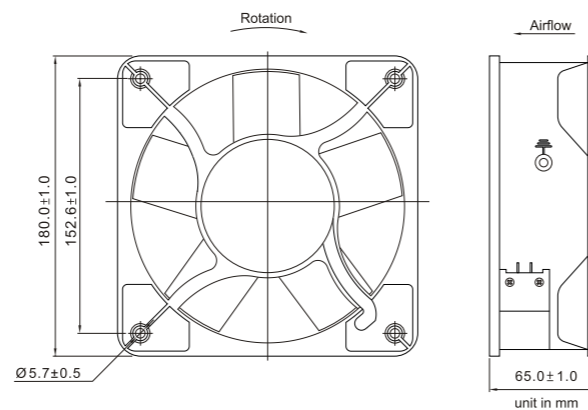

Please refer to Model Numbering System for bearing, function and speed level indication. Specifications are subject to changes without notice. Please refer to the formally issued product specification via contacting Y.S. TECH sales department. Visit Y.S. TECH web site at <http://www.ystech.com.tw> for updated information. Customized Specifications are designed accordingly.

PERFORMANCE P-Q CURVE

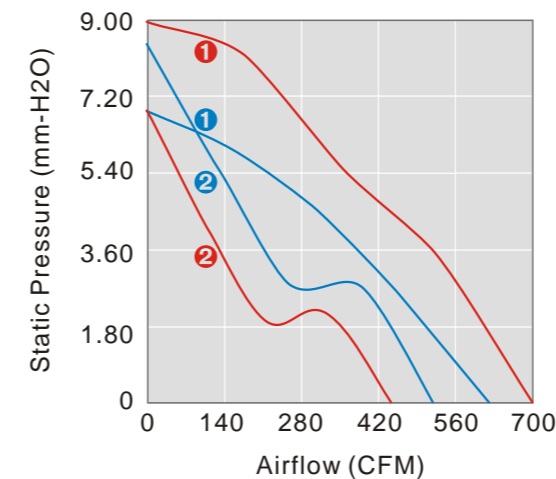

OUTLINE DIMENSIONS

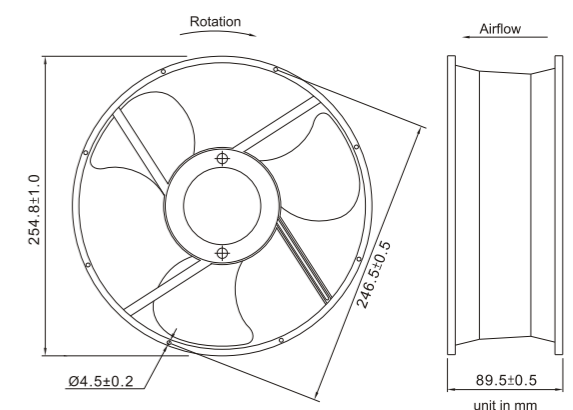

Please refer to Model Numbering System for bearing, function and speed level indication. Specifications are subject to changes without notice. Please refer to the formally issued product specification via contacting Y.S. TECH sales department. Visit Y.S. TECH web site at <http://www.ystech.com.tw> for updated information. Customized Specifications are designed accordingly.